

L3246

THIS FORM HAS BEEN APPROVED BY THE INDIANA STATE BAR ASSOCIATION FOR USE BY LAWYERS ONLY. THE SELECTION OF A FORM OF INSTRUMENT, FILLING IN BLANK SPACES, STRIKING OUT PROVISIONS AND INSERTION OF SPECIAL CLAUSES, CONSTITUTES THE PRACTICE OF LAW AND MAY ONLY BE DONE BY A LAWYER.

Mall tax bills to: 91009163

Tax Key No. 13-379-1

2501 Harvest Drive  
Crown Point, IN 46307

# WARRANTY DEED

COMMUNITY TITLE CO.  
421 W. 81st Avenue  
Merrillville, IN 46410

This indenture witnesseth that NORMA R. GUILLEN

of LAKE County in the State of INDIANA

Convey and warrant to PAMELA S. FREEMAN

of LAKE County in the State of INDIANA  
for and in consideration of Ten Dollars (\$10.00) and other good and valuable consideration  
the receipt whereof is hereby acknowledged, the following Real Estate in LAKE County  
in the State of Indiana, to wit:

The Condominium Unit designated as 2501 Harvest Drive, Schererville, Indiana, in Oakcrest Condominiums according to the Declaration of Horizontal Property Regime recorded May 7, 1985 as Document Nos. 802041 and 802042 and as amended by documents recorded October 17, 1985 as Document Nos. 824860 and 824861 and as amended by documents recorded April 19, 1986 as Document Nos. 851542 and 851543 and as amended by documents recorded February 24, 1987 as Document Nos. 903508 and 903509 and amended by documents recorded September 20, 1988 as Document No. 998356, in the Office of the Recorder of Lake County, Indiana, together with the undivided interest in the common elements appertaining thereto.

(Commonly known as 2501 Harvest Drive, Schererville, Indiana)

Subject to streets, highways, easements, restrictions and ordinances of record.

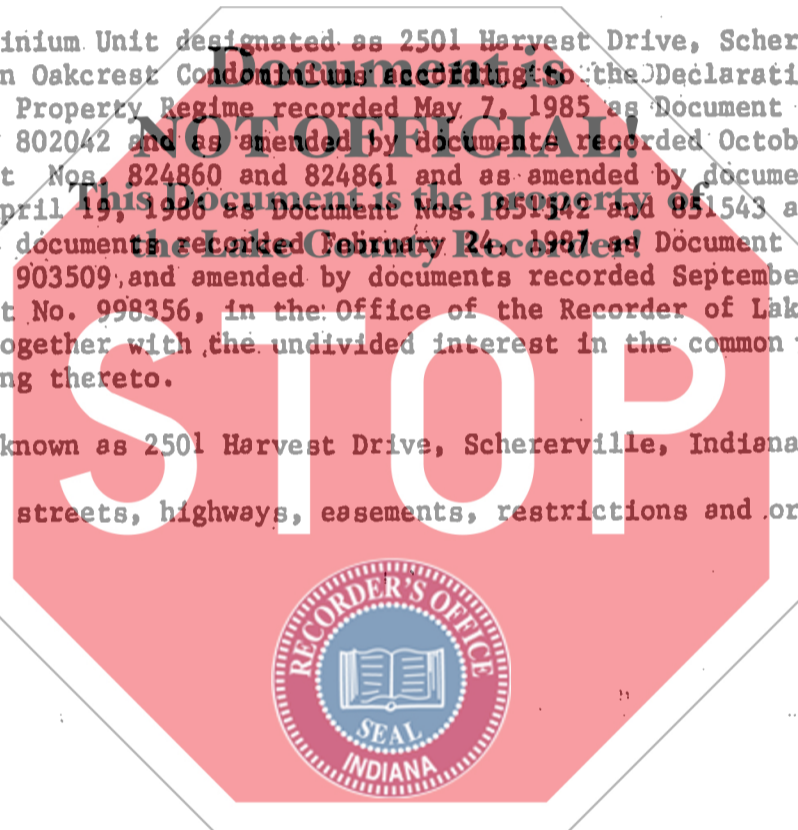

STATE OF INDIANA'S S. NO. LAKE COUNTY FILED FOR RECORD  
FEB 27 12 37 PM '91  
ROBERT J. ... AND  
RECORDER

State of Indiana, LAKE County, ss:

Before me, the undersigned, a Notary Public in and for said County and State, this 12th day of February 19 91 personally appeared:

Dated this 12th Day of February 1991

*Norma R. Guillen*  
Norma R. Guillen

NORMA R. GUILLEN

DULY ENTERED FOR TAXATION, SUBJECT TO FINAL ACCEPTANCE FOR TRANSFER.

FEB 19 1991

And acknowledged the execution of the foregoing deed. In witness whereof, I have hereunto subscribed my name and affixed my official seal. My commission expires 4-15-19 94

*Anna N. Anton*  
AUDITOR LAKE COUNTY

*Patricia Ludington*  
Patricia Ludington  
Notary Public

Resident of LAKE County.

This instrument prepared by HENRY S. KOWALCZYK  
5246 Hohman Avenue, Hammond, Indiana 46320 Attorney at Law  
219/931-4933

01163

*AM 700*