

91009033

SWORN STATEMENT OF INTENTION TO HOLD LIEN (NOTICE OF MECHANIC'S LIEN)

To: Wal-Mart Stores, Inc.
1545 U.S. 41
Schererville, IN 46375
OWNER'S NAME AND ADDRESS

STATE OF Indiana, COUNTY OF Lake, SS:

The undersigned, being first duly sworn, makes this sworn statement of intention to hold a lien upon the property described below and says that:

1. The undersigned Richard P. Bellich, President
(INDIVIDUAL'S NAME) (CORPORATE OFFICER'S NAME) (ETC.)
Miller Electric Company of Indiana, Inc.

intends to hold a lien on land commonly known as Wal-Mart Stores, Inc.
1545 U.S. 41
Schererville, IN 46375
STREET STATE

and legally described as follows:

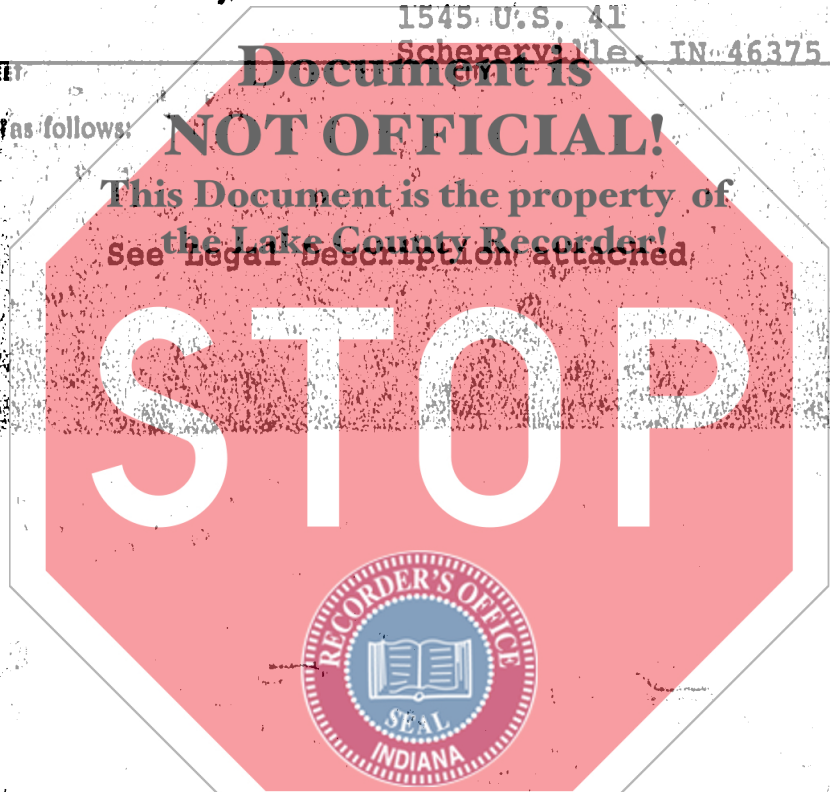

STATE OF INDIANA/S.S. NO. 1
LAKE COUNTY
RECORDED
FEB 27 9 05 AM '91
ROBERT L. LAND
RECORDER

as well as on all buildings, other structures and improvements located thereon or connected therewith for work and labor done and for materials and machinery furnished by the undersigned in the erection, construction, altering, repairing and removing of said buildings, structures and improvements for such work and labor and for such materials and machinery.

2. The amount claimed under this statement is Thirty Six Thousand Dollars (\$ 36,507.35).

3. The work and labor were done and the materials and machinery were furnished by the undersigned within the last sixty days. Five Hundred Seven and 35/100

Richard P. Bellich
CLAIMANT'S SIGNATURE Richard P. Bellich, President CLAIMANT'S ADDRESS 505 West 84th Drive, Merrillville, IN 46410
Miller Electric Co. of Indiana, Inc.

Subscribed and sworn to before me, a notary public, by Richard P. Bellich
this 25th day of February, 1991. Witness my hand and notarial seal.

My commission expires: February 8, 1993

Nancy Kracich Waters
NOTARY PUBLIC
Nancy Kracich Waters, Lake County Resident

I hereby certify that I have this 25th day of February, 1991 mailed a duplicate of this notice, first-class, postage prepaid, to the within named property owner at 1545 U.S. 41, Schererville, IN 46375
(Latest address shown on tax records)

Recorder of Lake County

This instrument prepared by PAUL J. GIORGI, Attorney at Law.
One Professional Center, Suite 204
2100 N. Main Street
Crown Point, IN 46307

800

Part of the Northwest Quarter of the Northwest Quarter of Section 16, Township 35 North, Range 9 West of the Second Principal Meridian, Lake County, Indiana, described as follows:

Commencing at the Northwest corner of the Northwest Quarter of said Section 16, thence North 87 degrees 53 minutes 18 seconds East on the North line of the Northwest Quarter of said Section 16, a distance of 959.92 feet to the Point of Beginning; thence continuing North 87 degrees 53 minutes 18 seconds East on the North line of said Northwest Quarter, a distance of 198.86 feet to a point in the West Right-of-Way line of the New York Central Railroad; thence South 2 degrees 30 minutes 27 seconds East on said West Right-of-Way line, a distance of 651.37 feet; thence South 87 degrees 21 minutes 58 seconds West, a distance of 319.68 feet; thence South 29 degrees 34 minutes 39 seconds West, a distance of 29.77 feet; thence South 2 degrees 38 minutes 02 seconds East, a distance of 80.05 feet; thence South 43 degrees 30 minutes 03 seconds West, a distance of 81.96 feet; thence South 2 degrees 38 minutes 02 seconds East, a distance of 79.96 feet to a point in the North Right-of-Way line of U.S. Route 30; thence North 89 degrees 28 minutes 09 seconds West on said North Right-of-Way line, a distance of 110.00 feet; thence North 2 degrees 38 minutes 02 seconds West, a distance of 51.93 feet; thence North 43 degrees 30 minutes 03 seconds East, a distance of 116.41 feet; thence North 2 degrees 38 minutes 02 seconds West, a distance of 55.93 feet; thence South 87 degrees 58 minutes 03 seconds East, a distance of 288.40 feet; thence North 0 degrees 32 minutes 56 seconds West, a distance of 192.12 feet; thence South 89 degrees 27 minutes 04 seconds West, a distance of 195.80 feet; thence North 3 degrees 18 minutes 21 seconds West, a distance of 409.99 feet; thence North 2 degrees, 32 minutes, 55 seconds West, a distance of 13.65 feet; thence North 87 degrees 29 minutes 33 seconds East, a distance of 704.82 feet; thence North 2 degrees 30 minutes 27 seconds West, a distance of 76.83 feet to the Point of Beginning, also known as Lot 1, The Crossroads, as shown in Plat Book 69, page 3, Lake County, Indiana.