

SWORN STATEMENT OF INTENTION TO HOLD LIEN
(NOTICE OF MECHANIC'S LIEN)

31008881

To: Bank One, Merrillville, NA Wal-Mart Stores, Inc.
as Trustee under Trust Agreement c/o First National Realty
dated October 5, 1989 415 North LaSalle, Suite 700
1000 East 80th Place, Suite 600 North Chicago, Illinois 60610
Merrillville, Indiana 46410
as owners of the real estate described herein.

STATE OF Indiana COUNTY OF Lake SS:

The undersigned, after being duly cautioned and sworn upon his oath, makes this statement of intention to hold a lien upon the property and real estate described herein saying that:

1. The undersigned Interior Products Supply a division of Strahm Group, Inc.

By: Norbert J. Schenkel, Jr., its Assistant Secretary
intends to hold a lien upon land commonly known as Wal-Mart
Merrillville Crossing, Merrillville, Indiana

the same being legally described as follows, to wit:

See Attached

Document is NOT OFFICIAL!

This Document is the property of the Lake County Recorder!

along with all buildings, structures, and improvements located upon or connected in any way with said described real estate for the providing of work, labor, goods, materials, or machinery used or furnished by it in the improvement, erection, construction, alteration, reparation or removal of certain buildings, structures, or improvements as well as for work, labor, materials, and machinery provided.

2. As a result of the providing of the above, a lien upon said property and real estate is claimed to the extent of Three Thousand Four Hundred Ninety Six and 05/100 ----- Dollars (\$3,496.05)

3. Further, said lien is based upon the providing of work, labor, materials, and machinery within sixty (60) days of the recording hereof.

INTERIOR PRODUCTS SUPPLY, A DIVISION OF STRAHM GROUP, INC. P. O. Box 8299

Norbert J. Schenkel, Jr.
By: Norbert J. Schenkel, Jr. Asst. Sec.) SS:
STATE OF INDIANA COUNTY OF ALLEN)

Before me, a Notary Public in for said County and State, personally appeared Norbert J. Schenkel, Jr. Assistant Secretary of Interior Products Supply, a Division of Strahm Group, Inc. and acknowledged the execution of the foregoing Sworn Statement and Notice of Intention to Hold Mechanic's Lien, stated that the facts contained therein are true, accurate, and correct this 25th day of February, 1991.

Patricia A. Gump
Patricia A. Gump Notary Public

My Commission Expires: December 3, 1993 Resident of Allen County

I hereby certify that I have this _____ day of _____, 19____, mailed a duplicate of this notice first class postage prepaid to the within named property owner at 1000 E. 80th Place, Suite 600 N., Merrillville, IN 46410 and 415 N. LaSalle, Chicago, Illinois 60610

Return to: SCHENKEL & TIRPAK Recorder of _____ County
520 South Calhoun St. Recorder, of _____ County
Ft. Wayne, IN. 46802

This instrument prepared by _____, Attorney at Law.

7/3/90

STATE OF INDIANA/S.S. No. 11
FEB 25 11 13 AM '91
RECORDERS OFFICE

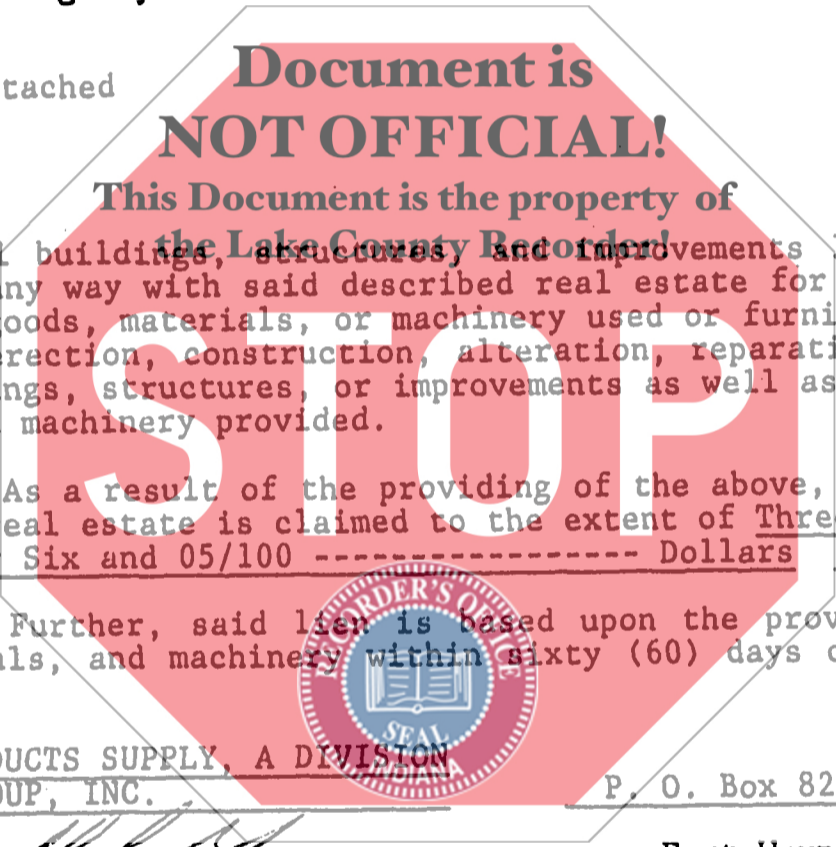

1200

THE SOUTHEAST QUARTER OF THE NORTHEAST QUARTER OF SECTION 23, TOWNSHIP 35 NORTH, RANGE 8 WEST OF THE 2ND P.M., AND THE EAST HALF OF THE SOUTHWEST QUARTER OF THE NORTHEAST QUARTER OF SECTION 23, TOWNSHIP 35 NORTH, RANGE 8 WEST OF THE 2ND P.M. LYING NORTH OF THE NORTHERLY RIGHT-OF-WAY LINE OF U.S. HIGHWAY NO. 30 EXCEPTING THAT PART OF THE SOUTHEAST QUARTER OF THE NORTHEAST QUARTER OF SAID SECTION 23, DESCRIBED AS FOLLOWS: COMMENCING AT THE INTERSECTION OF THE NORTH RIGHT-OF-WAY LINE OF U.S. HIGHWAY #30 WITH THE EAST LINE OF THE NORTHEAST QUARTER OF SAID SECTION 23; THENCE WEST ALONG THE NORTH LINE OF U.S. HIGHWAY NO. 30, A DISTANCE OF 180 FEET: THENCE NORTH PARALLEL TO THE EAST LINE OF THE NORTHEAST QUARTER OF SAID SECTION 23, A DISTANCE OF 150 FEET: THENCE EAST PARALLEL TO THE NORTH LINE OF U.S. HIGHWAY NO. 30, A DISTANCE OF 180 FEET TO THE EAST LINE OF THE NORTHEAST QUARTER OF SAID SECTION 23; THENCE SOUTH 150 FEET TO THE POINT OF BEGINNING, IN LAKE COUNTY, INDIANA.

ALSO EXCEPTING THEREFROM THAT PORTION DESCRIBED AS FOLLOWS:

COMMENCING AT THE POINT OF INTERSECTION OF THE NORTH RIGHT OF WAY LINE OF U.S. HIGHWAY NO. 30 WITH THE EAST LINE OF THE NORTHEAST 1/4 OF SAID SECTION 23, THENCE NORTH 2 DEGREES 48 MINUTES 02 SECONDS WEST ON THE EAST LINE OF THE NORTHEAST 1/4 OF SAID SECTION 23, A DISTANCE OF 150.0 FEET: THENCE WEST PARALLEL TO THE NORTH LINE OF U.S. HIGHWAY 30, A DISTANCE OF 50.01 FEET TO A POINT ON A LINE 50.0 FEET WEST OF AND PARALLEL TO THE EAST LINE OF THE NORTHEAST 1/4 OF SAID SECTION 23, THENCE CONTINUING WEST ON A LINE PARALLEL TO THE NORTH LINE OF U.S. HIGHWAY 30, A DISTANCE OF 150.0 FEET TO A POINT: SAID POINT BEING THE POINT OF BEGINNING OF THE HEREINAFTER DESCRIBED TRACT: THENCE NORTH 2 DEGREES 48 MINUTES 02 SECONDS WEST ON A LINE PARALLEL TO THE EAST LINE OF THE NORTHEAST 1/4 OF SAID SECTION 23, A DISTANCE OF 95.17 FEET: THENCE SOUTH 88 DEGREES 37 MINUTES 48 SECONDS WEST, A DISTANCE OF 166.44 FEET TO A POINT: THENCE SOUTH 1 DEGREE 22 MINUTES 12 SECONDS EAST, A DISTANCE OF 246.32 FEET TO A POINT ON THE NORTH RIGHT OF WAY LINE OF U.S. HIGHWAY 30, THENCE EASTERLY ON THE NORTH RIGHT OF WAY LINE OF U.S. HIGHWAY 30, A DISTANCE OF 172.56 FEET ON THE ARC OF A CIRCLE WHOSE CHORD HAS A BEARING OF NORTH 88 DEGREES 12 MINUTES 53 SECONDS EAST, A CHORD LENGTH OF 172.56 FEET AND A RADIUS OF 98117.96 FEET TO A POINT: THENCE NORTH 2 DEGREES 48 MINUTES 02 SECONDS WEST, A DISTANCE OF 149.98 FEET TO THE POINT OF BEGINNING.

ALSO EXCEPTING THEREFROM THAT PORTION DESCRIBED AS FOLLOWS:

COMMENCING AT THE POINT OF INTERSECTION OF THE NORTH RIGHT OF WAY LINE OF U.S. HIGHWAY NO. 30 WITH THE EAST LINE OF THE NORTHEAST 1/4 OF SAID SECTION 23, THENCE NORTH 2 DEGREES 48 MINUTES 02 SECONDS WEST ON THE EAST LINE OF THE NORTHEAST 1/4 OF SAID SECTION 23, A DISTANCE OF 150.0 FEET: THENCE WEST PARALLEL TO THE NORTH LINE OF U.S. HIGHWAY 30, (SAID PARALLEL LINE HAVING A BEARING OF SOUTH 88 DEGREES 06 MINUTES 00 SECONDS WEST) A DISTANCE OF 180.0 FEET TO THE POINT OF BEGINNING: THENCE CONTINUING SOUTH 88 DEGREES 06 MINUTES 00 SECONDS WEST ON SAID LINE PARALLEL TO THE NORTH LINE OF U.S. HIGHWAY 30, A DISTANCE OF 20.01 FEET TO A POINT: THENCE SOUTH 2 DEGREES 48 MINUTES 02 SECONDS EAST ON A LINE PARALLEL TO THE EAST LINE OF THE NORTHEAST 1/4 OF SAID SECTION 23, A DISTANCE OF 149.98 FEET: TO A POINT ON NORTH RIGHT OF WAY LINE OF U.S. HIGHWAY 30, THENCE EASTERLY ON THE NORTH RIGHT OF WAY LINE OF U.S. HIGHWAY 30, A DISTANCE OF 20.01 FEET ON THE ARC OF A CIRCLE WHOSE CHORD HAS A BEARING OF NORTH 88 DEGREES 09 MINUTES 31 SECONDS EAST, A CHORD LENGTH OF 20.01 FEET AND A RADIUS OF 98117.96 FEET TO A POINT: THENCE NORTH 2 DEGREES 48 MINUTES 02 SECONDS WEST ON A LINE PARALLEL TO THE EAST LINE OF NORTHEAST 1/4 OF SAID SECTION 23, A DISTANCE OF 150.00 FEET TO THE POINT OF BEGINNING. ALL IN LAKE COUNTY, INDIANA.