

THIS FORM HAS BEEN APPROVED BY THE INDIANA STATE BAR ASSOCIATION FOR USE BY LAWYERS ONLY. THE SELECTION OF A FORM OF INSTRUMENT, FILLING IN BLANK SPACES, STRIKING OUT PROVISIONS AND INSERTION OF SPECIAL CLAUSES, CONSTITUTES THE PRACTICE OF LAW AND MAY ONLY BE DONE BY A LAWYER.

Mail tax bills to: **91008795**

Tax Key No. \_\_\_\_\_

Dovenmuehle Mortgage Co  
1501 Woodfield Road  
Schaumburg IL 60173-4982

# WARRANTY DEED

LAWYERS TITLE INS. CORP.  
ONE PROFESSIONAL CENTER  
SUITE 215  
GREEN POINT, IN 46207

This indenture witnesseth that

HANNAH A. GIBSON

of Lake County in the State of Indiana

Convey and warrant to MARY C. KEPCHAR and ALVIN ERBESTI

of Lake County in the State of Indiana

for and in consideration of ten dollars and other good and valuable consideration, the receipt whereof is hereby acknowledged, the following Real Estate in Lake County in the State of Indiana, to wit:

STATE OF INDIANA/S.S. NO.  
LAKE COUNTY  
FILED  
FEB 26 9 36 AM '91  
ROBERT J. [unclear] CLERK

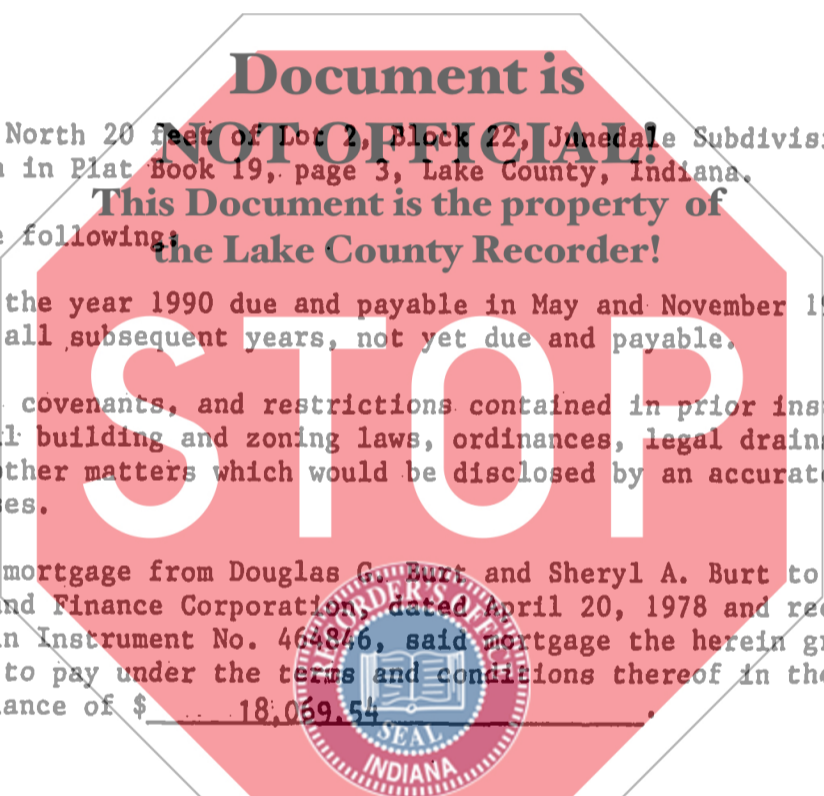

Lot 1 and the North 20 feet of Lot 2, Block 22, Jamedale Subdivision, City of Gary, as shown in Plat Book 19, page 3, Lake County, Indiana.

Subject to the following:

1. Taxes for the year 1990 due and payable in May and November 1991; and taxes for all subsequent years, not yet due and payable.
2. Easements, covenants, and restrictions contained in prior instruments of record; all building and zoning laws, ordinances, legal drains, right-of-way, and other matters which would be disclosed by an accurate survey of the premises.
3. A certain mortgage from Douglas G. Burt and Sheryl A. Burt to Percy Wilson Mortgage and Finance Corporation, dated April 20, 1978 and recorded April 26, 1978 in Instrument No. 464846, said mortgage the herein grantee assume and agree to pay under the terms and conditions thereof in the approximate unpaid balance of \$ 18,069.54

Key # 45-186-1 + 2 UNIT 25

State of Indiana, Lake County, ss:  
Before me, the undersigned, a Notary Public in and for said County and State, this 22nd day of February 1991 personally appeared:

Dated this 22nd Day of February 1991

*Hannah A. Gibson*  
HANNAH A. GIBSON

HANNAH A. GIBSON

DULY ENTERED FOR TAXATION SUBJECT TO FINAL ACCEPTANCE FOR 1991

FEB 26 1991

*Alvin Erbesti*  
AUDITOR LAKE COUNTY

And acknowledged the execution of the foregoing deed. In witness whereof, I have hereunto subscribed my name and affixed my official seal. My commission expires 9-17-93 19

*Andrea A. Plasencia*  
Andrea A. Plasencia Notary Public

Resident of Lake County.

01717

This instrument prepared by ERVIN C. CARSTENSEN Attorney at Law  
1000 E. 80th Pl., Suite 517, Merrillville, IN 46410