

Use of this form constitutes practice of law and is limited to practicing lawyers.  
©Copyright, 1986, by Indianapolis Bar Association.

Rev. 10/86

KEY  
Form No. 41-210-41

91006534

**WARRANTY DEED**

THIS INDENTURE WITNESSETH, That SAM LETO and JENNIE LETO, husband and wife  
\_\_\_\_\_ (Grantor)  
of Lake County, in the State of Indiana, CONVEY  
AND WARRANT to CHARLENE E. STRONG a single person and ANNETTE E. STRONG  
\_\_\_\_\_ a single person (Grantee)  
of Lake County, in the State of Indiana, for the sum  
of Ten and 00/100 Dollars (\$ 10.00 ) and other  
valuable consideration, the receipt and sufficiency of which is hereby acknowledged, the following  
described real estate in Lake County, State of Indiana:

Lot 42 and the North 1/2 of Lot 41, Block 2, Broadway Realty and Co  
Investment Company's Addition to Gary, as shown in Plat Book 9,  
page 31, Lake County, Indiana.

Subject to all real estate taxes payable.

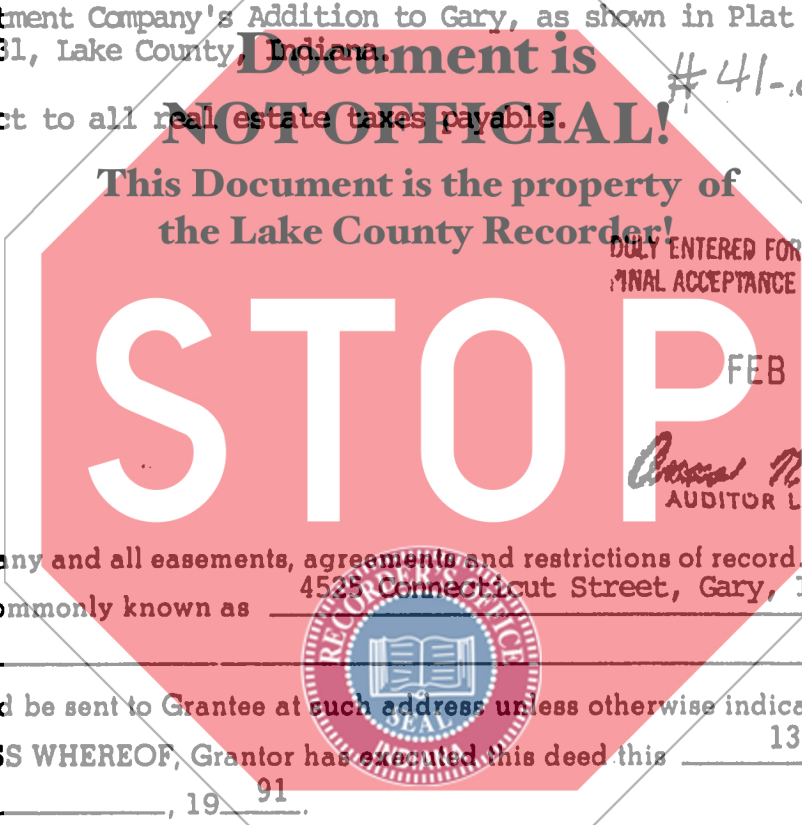

STATE OF INDIANA/S.S. NO.  
FILED IN RECORD  
FEB 25 5 58 AM '91

DULY ENTERED FOR TAXATION SUBJECT TO  
FINAL ACCEPTANCE FOR TRANSFER.

FEB 22 1991

*Anna M. Anton*  
AUDITOR LAKE COUNTY

Subject to any and all easements, agreements and restrictions of record. The address of such  
real estate is commonly known as 4525 Connecticut Street, Gary, Indiana 46409

Tax bills should be sent to Grantee at such address unless otherwise indicated below.

IN WITNESS WHEREOF, Grantor has executed this deed this 13th day of  
February, 1991.

Grantor: \_\_\_\_\_ (SEAL)  
Signature *Sam Leto*  
Printed SAM LETO

Grantor: \_\_\_\_\_ (SEAL)  
Signature *Jennie Leto*  
Printed JENNIE LETO

STATE OF Indiana } SS: ACKNOWLEDGMENT  
COUNTY OF Lake

Before me, a Notary Public in and for said County and State, personally appeared \_\_\_\_\_  
Sam Leto and Jennie Leto Husband and Wife  
who acknowledged the execution of the foregoing Warranty Deed, and who, having been duly  
sworn, stated that any representations therein contained are true.

Witness my hand and Notarial Seal this 13th day of February, 1991.  
My commission expires: 07/12/91 Signature *Lori S. Monahan*  
Printed Lori S. Monahan, Notary Public  
Resident of Lake County, Indiana.

This instrument prepared by MARK A. PSIMOS, 7887 Broadway, Merrillville, IN 46410, Attorney at Law.

Return deed to \_\_\_\_\_

Send tax bills to Simmons First National Bank of Pine Bluff  
P.O. Box 24410  
Little Rock Arkansas 72217-4410

71202 700/100