

THIS FORM HAS BEEN APPROVED BY THE INDIANA STATE BAR ASSOCIATION FOR USE BY LAWYERS ONLY. THE SELECTION OF A FORM OF INSTRUMENT, FILLING IN BLANK SPACES, STRIKING OUT PROVISIONS AND INSERTION OF SPECIAL CLAUSES, CONSTITUTES THE PRACTICE OF LAW AND MAY ONLY BE DONE BY A LAWYER.

MAIL TAX BILLS TO: 91008512

TAX KEY NO: 7-218-21

938 Meadow Crest Dr
Pittsburg, PA 15237

QUIT-CLAIM DEED

This indenture witnesseth that **TERESA F. PIERCE, F/K/A TERESA FAYE FORSYTHE, A/K/A TERESA F. FORSYTHE**

of **ALLEGHENY** County in the State of **PENNSYLVANIA**

Releases and quit claims to **TERESA F. PIERCE and Joe T. PIERCE, Husband and Wife**

of **ALLEGHENY** County in the State of **PENNSYLVANIA**
for and in consideration of **Ten dollars and other good and valuable consideration**
the receipt whereof is hereby acknowledged, the following Real Estate in **LAKE** County
in the State of Indiana, to wit:

⁷⁻²¹⁸⁻²¹
Lot 21 in Willowdale Manor, as per plat thereof, recorded in Plat Book 31 page 14, in the Office of the Recorder of Lake County, Indiana.

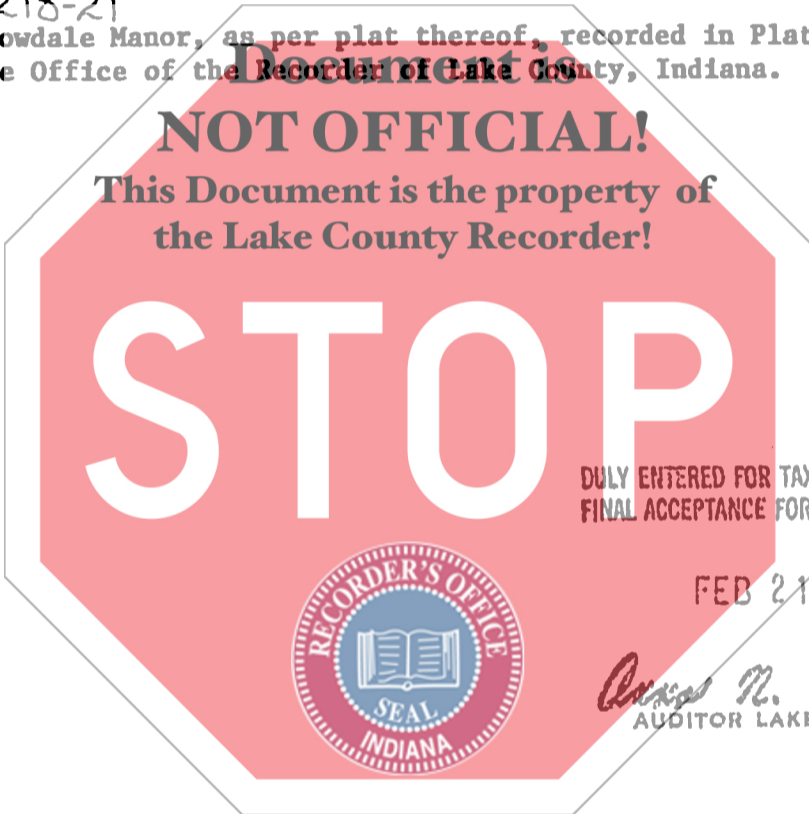

PENNSYLVANIA
State of Indiana: **Allegheny** County, ss:
Before me, the undersigned, a Notary Public in and for said County and State, this **7th** day of **February** 19 **91** personally appeared:
TERESA F. PIERCE, F/K/A TERESA FAYE FORSYTHE, A/K/A TERESA F. FORSYTHE

Dated this **7th** Day of **February** 1991

Teresa F. Pierce
TERESA F. PIERCE, F/K/A TERESA FAYE FORSYTHE, A/K/A TERESA F. FORSYTHE

And acknowledged the execution of the foregoing deed. In witness whereof, I have hereunto subscribed my name and affixed my official seal. My commission expires **5-23-94** 19

Notarial Seal
Susan M. Platko, Notary Public
Pittsburgh, Allegheny County
My Commission Expires May 23, 1994

Susan M. Platko
Notary Public

Member, Pennsylvania Association of Notaries
Resident of **Allegheny** County

This instrument prepared by **JOHN D. BRECLAW**, Attorney at Law

MAIL TO: **735 West Glen Park Avenue
Griffith, Indiana 46319
(219) 924-8750**

01197

700
k