

139238

WARRANTY DEED

THIS INDENTURE WITNESSETH, That THOMAS M. KOVATCH AND SUSAN P. KOVATCH, HUSBAND AND WIFE

of LAKE County, in the State of INDIANA. Convey and Warrant to

PRUDENTIAL RESIDENTIAL SERVICES LIMITED PARTNERSHIP, A DELAWARE LIMITED PARTNERSHIP of County, in the State of for and in consideration of TEN DOLLARS AND GOOD AND OTHER VALUABLE CONSIDERATION Dollars the receipt whereof is hereby acknowledged, the following described Real Estate in LAKE County, in the State of Indiana, to-wit:

LOT ONE HUNDRED AND ONE (101), PLUM CREEK VILLAGE, BLOCK TWO (2) TO THE TOWN OF SCHERERVILLE, AS SHOWN IN PLAT BOOK 47 PAGE 31 IN LAKE COUNTY INDIANA.

SUBJECT TO: REAL ESTATE TAXES AND SPECIAL ASSESSMENTS IF ANY BECOMING DUE AND PAYABLE HEREAFTER; EASEMENT AFFECTING SOUTH FIVE (5) FEET OF PREMISES AS SHOWN ON PLAT OF SUBDIVISION; RESTRICTIVE COVENANTS AS SHOWN ON PLAT OF SUBDIVISION EXCEPT SUCH COVENANTS BASED ON RACE, COLOR, RELIGION OR NATIONAL ORIGIN BUILDING AND ZONING LAWS AND ORDINANCES AND AMENDMENTS THERETO;

Key # 13-216-17

Taxes: Two Woodfield Lake 1100 Woodfield Rd, Ste 520 Schaumburg, IL 60173

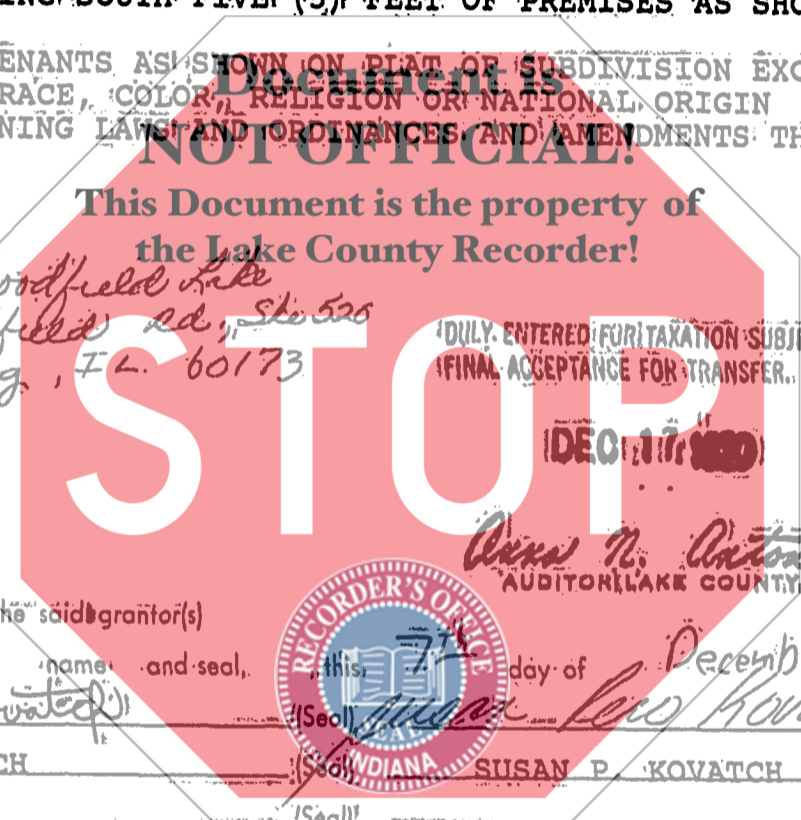

DULY ENTERED FOR TAXATION SUBJECT TO FINAL ACCEPTANCE FOR TRANSFER. DEC 17 1990

Alex N. Anton Auditor, LAKE COUNTY

IN WITNESS WHEREOF, the said grantor(s) has hereunto affixed name and seal, this 7th day of December 1990. Thomas M. Kovatch (Seal), Susan P. Kovatch (Seal)

OFFICIAL SEAL LINDA CHRISTMAS NOTARY PUBLIC STATE OF ILLINOIS MY COMMISSION EXPIRES 7/24/91

STATE OF INDIANA Cook County, ss: Before me, the undersigned, a Notary Public in and for said County and State; this 7th day of December 1990, personally appeared Thomas M. Kovatch and Susan Pero Kovatch and acknowledged the execution of the foregoing deed. Linda Christmas Notary Public My Commission expires 7/24/91

STATE OF INDIANA/S.S. NO. FILED FOR RECORD DEC 17 1 52 PM '90 ROBERT H. RECORDER

Auditor Stamp

Recorder Stamp

00847

700

TALAN & KTSANES 175 W. JACKSON BLVD CHICAGO, ILLINOIS 60604

This Document Prepared by

Sign in BLACK INK for better Micro copies