



Chicago Title Insurance Company

THIS INDENTURE WITNESSETH

139090

That LANETTE L. MAX

of Lake County, and State of Indiana

CONVEY. & WARRANT

To MATTHEW J. SWIERCZYNSKI

of Lake County, in the State of Indiana

for the sum of Ten Dollars and other good and valuable / (\$ 10.00 Dollars)

and other good and valuable consideration, the receipt of which is hereby acknowledged. The following described Real Estate, in Lake County, in the State of Indiana, to-wit:

Lot 209A in Pine Island Ridge Unit 3, as per plat thereof, recorded in Plat Book 45, page 87, in the Office of the Recorder of Lake County, Indiana

Subject to taxes for the year 1989, payable in 1990, and 1990, payable in 1991, and to all taxes and assessments thereafter payable, and to all conditions, restrictions, easements, rights of way and zoning ordinances of record.

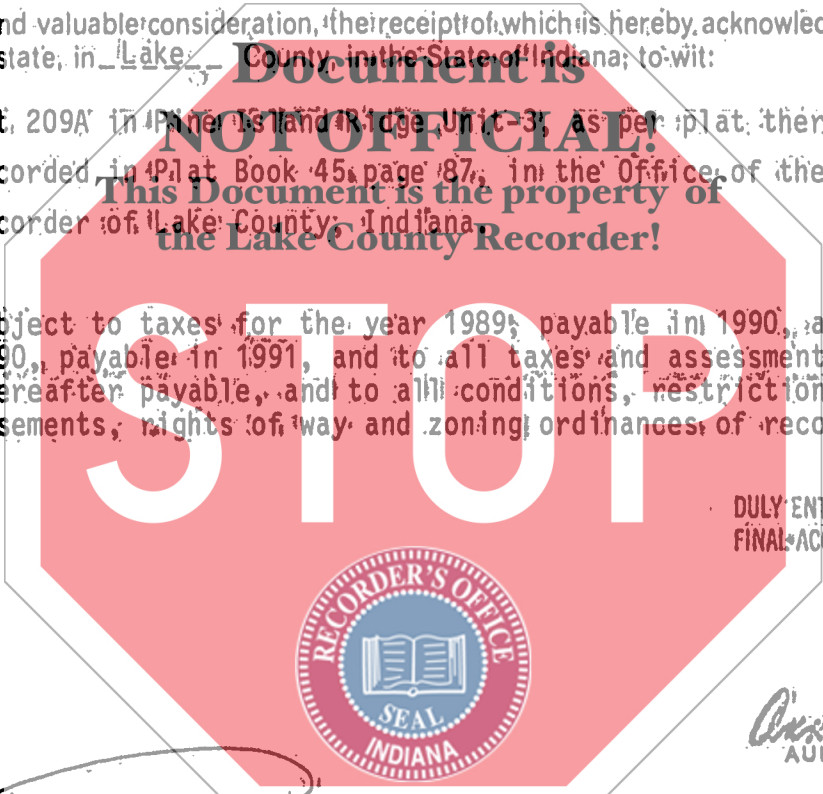

STATE OF INDIANA, S. NO. LAKE COUNTY
REC'D DEC 13 8 46 AM '90
ROBERT RECHNER

DULY ENTERED FOR TAXATION SUBJECT TO FINAL ACCEPTANCE FOR TRANSFER

DEC 13 1990

Anna N. Anton
AUDITOR LAKE COUNTY

KEY NO: 13-248-14

SEND TAX STATEMENTS TO: Liberty Savings Assn., IFA, 1900 Indianapolis Blvd Whiting IN 46394

IN WITNESS WHEREOF, The said LANETTE L. MAX

Has hereunto set her Hand this 1st day of November 19 90

State of IN Lake County, ss:
Before me, the undersigned, a Notary Public, in and for said County and State, personally appeared the within named LANETTE L. MAX

on November 29 19 90
and acknowledged the execution of the foregoing Deed to be her voluntary act and deed, in witness whereof, I have hereunto subscribed my name and affixed my official seal. My commission expires: February 28, 1991

Doris D. Slayden
Doris D. Slayden Notary Public
Resident of Lake County

Lanette L. Max Seal

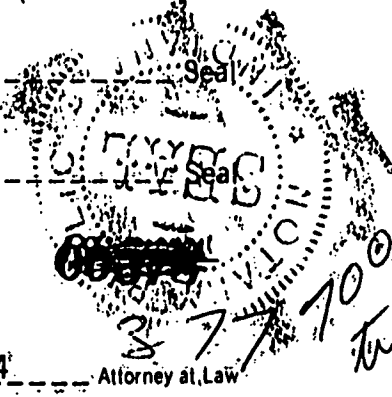

156883

TCOR TITLE INSURANCE
Crown Point, Indiana