

137583

ASSIGNMENT OF MORTGAGE

LAWYERS TITLE INS. CORP.
ONE PROFESSIONAL CENTER
SUITE 215
CROWNPOINT, IN 46307

50624

For the value received, Suburban Mortgage Co., Inc. (Assignor) hereby assigns, transfers, sets over and delivers to DMR Financial Services, Inc. (Assignee) a certain Mortgage dated 11/21/90, executed by John K. Staples, a single person and Shirley A. Ewen, as single person, the Mortgagor therein, to Assignor as the Mortgagee therein, and duly recorded on 11/27/90 in Mortgage Record Doc # 136000, page 17, in the Lake County, Indiana, Recorder's Office, together with the note or notes therein described which such mortgage secures. This assignment is made without recourse and without warranties.

In witness whereof Suburban Mortgage Co., Inc. has hereunto set its hand and seal this 21st day of November, 1990

Lots 7 and 8, Block 1, Riverton Park Suburban Mortgage Co., Inc.
Subdivision, in the Town of East Gary,
now Lake Station, as shown in Plat Book
17, page 18, Lake County, Indiana

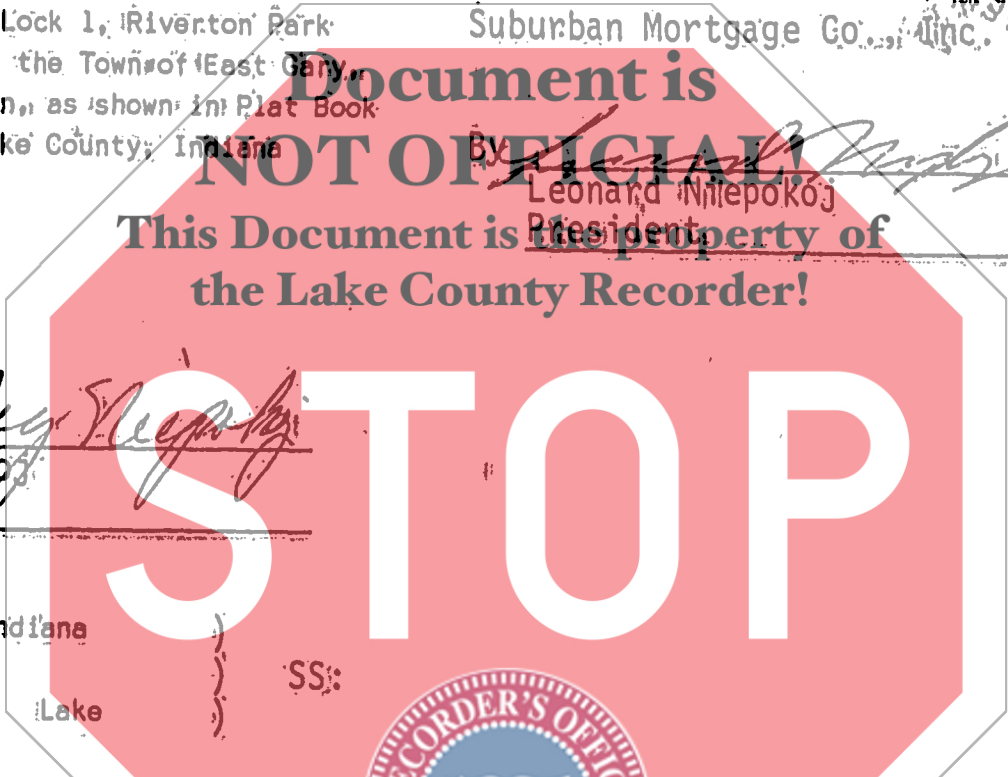

BY Leonard Niepokoj
President

ATTEST:

Ruby Niepokoj
Secretary

STATE OF Indiana
COUNTY OF Lake

SS:



Before me, a Notary Public in and for said County and State, personally appeared Leonard Niepokoj and Ruby Niepokoj, known to me to be the President and Secretary, respectively, of Suburban Mortgage Co., Inc., who acknowledged the execution of the foregoing Assignment of Mortgage for and on behalf of said Corporation and who, being first duly sworn, stated that they are duly authorized to execute such Assignment by resolution of the Corporation's Board of Directors.

Witness my hand and Notarial Seal this 21st day of November, 1990

My commission expires:

10/13/90 ~~10/13/90~~ 10/13/94

Catherine A. Kasarda

Catherine A. Kasarda

This instrument was prepared by:

Leonard Niepokoj
SUBURBAN MORTGAGE CO., INC.
500 West Lincoln Highway, Suite F
Merrillville, Indiana 46410

Resident of Lake County

ROBERT J. O'BRIEN
RECORDER

Dec 6 8 55 AM '90

STATE OF INDIANA/S.S. NO.
LAKE COUNTY
FILED FOR RECORD

500
Ry