

THIS FORM HAS BEEN APPROVED BY THE INDIANA STATE BAR ASSOCIATION FOR USE BY LAWYERS ONLY. THE SELECTION OF A FORM OF INSTRUMENT, FILLING IN BLANK SPACES, STRIKING OUT PROVISIONS AND INSERTION OF SPECIAL CLAUSES, CONSTITUTES THE PRACTICE OF LAW AND MAY ONLY BE DONE BY A LAWYER.

Mail tax bill to: **137546**

Tax Key No.: **46-550-5**

# WARRANTY DEED

TREMONT N. TURNER  
2645 CENTRAL DRIVE  
GARY, INDIANA 46407

This indenture witnesseth that MARY LOU LOVELACE, Widow and not remarried

of LAKE County in the State of INDIANA

Convey and warrant to TREMONT N. TURNER

of LAKE County in the State of INDIANA  
for and in consideration of TEN (\$10.00) DOLLARS AND OTHER GOOD AND VALUABLE CONSIDERATIONS  
the receipt whereof is hereby acknowledged, the following Real Estate in LAKE  
in the State of Indiana, to-wit:

STATE OF INDIANA  
LAKE COUNTY  
FILED  
RECORDED  
DEC 5 8 51 AM 1990

PROPERTY KNOWN AS 2645 CENTRAL DRIVE, GARY, INDIANA 46407.  
MORE PARTICULARLY DESCRIBED AS: LOT 5, BLOCK 2 IN MARSHAL TOWN  
TERRACE IN THE CITY OF GARY, AS PER PLAT THEREOF, RECORDED IN  
PLAT BOOK 30, PAGE 12, IN THE OFFICE OF THE RECORDER OF LAKE  
COUNTY, INDIANA.

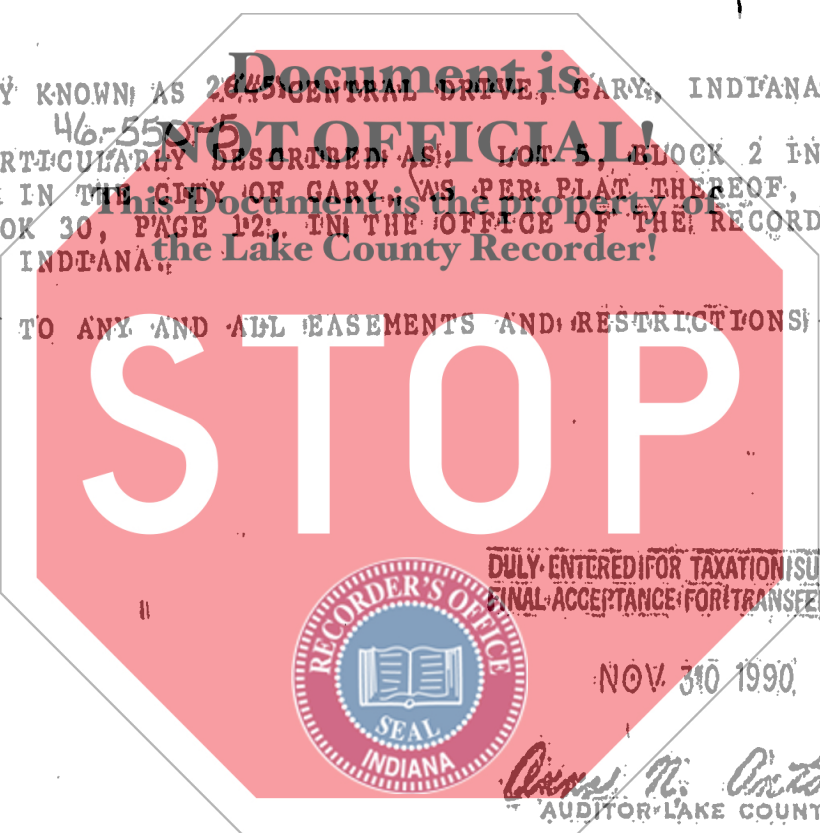

SUBJECT TO ANY AND ALL EASEMENTS AND RESTRICTIONS OF RECORD

State of Indiana, LAKE County, 1990

Dated this 19th Day of November 19 90

Before me, the undersigned, a Notary Public in and for said County and State, this 19th day of November 19 90 personally appeared MARY LOU LOVELACE, widow and not remarried

*Mary Lou Lovelace*  
MARY LOU LOVELACE, widow and not remarried

And acknowledged the execution of the foregoing deed. In witness whereof, I have hereunto subscribed my name and affixed my official seal. My commission expires Dec 28 1992

*Terry C. Gray*  
Notary Public  
TERRY C. GRAY

Resident of LAKE County

NOTARY PUBLIC STATE OF INDIANA

This instrument prepared by TERRY C. GRAY, 2210 W. LAKE AVENUE, GARY, IN 46404, (219) 944-2655  
001338 at Law