

THIS FORM HAS BEEN APPROVED BY THE INDIANA STATE BAR ASSOCIATION FOR USE BY LAWYERS ONLY. THE SELECTION OF A FORM OF INSTRUMENT, FILLING IN BLANK SPACES, STRIKING OUT PROVISIONS AND INSERTION OF SPECIAL CLAUSES, CONSTITUTES THE PRACTICE OF LAW AND MAY ONLY BE DONE BY A LAWYER.

Mall tax bills to:  
934 Brooke Lane  
Schererville, IN 46375

Tax Key No.: 113-415-6

# WARRANTY DEED

NORTHEAST INDIANA TITLE SERVICES, INC.  
162 Washington Street  
Lowell, Indiana 46356  
763-0727 or 696-0100

This indenture witnesseth that:

\*\*\*\*\* GARY L. MOON and KATHLEEN M. MOON, husband and wife \*\*\*\*\*

of Lake County in the State of Indiana

Convey and warrant to

\*\*\*\*\* JAMES ALLEVA and PATRICIA ALLEVA, husband and wife \*\*\*\*\*

of Lake County in the State of Indiana

for and in consideration of Ten dollars and other good and valuable consideration the receipt whereof is hereby acknowledged, the following Real Estate in Lake County in the State of Indiana, to wit:

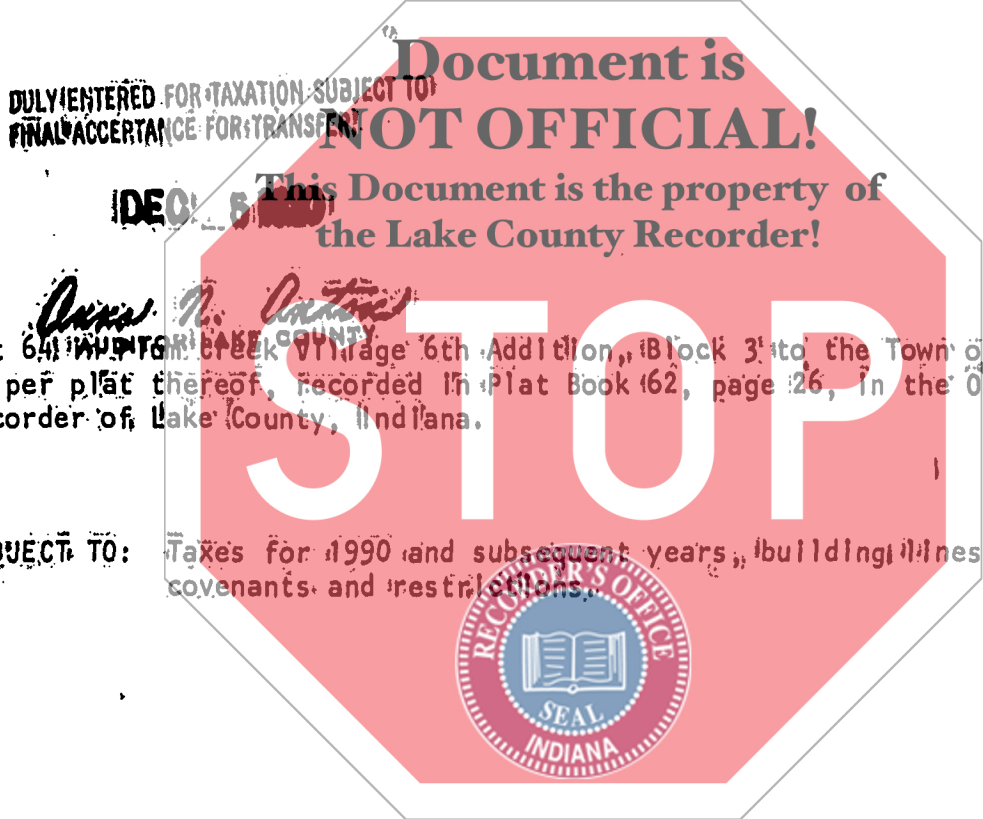

*Quia N. Contine*  
Lot 64 in the 6th Addition, Block 3 to the Town of Schererville, as per plat thereof, recorded in Plat Book 62, page 26, in the Office of the Recorder of Lake County, Indiana.

SUBJECT TO: Taxes for 1990 and subsequent years, building lines, easements, covenants and restrictions.

State of Indiana, Lake County, ss:  
Before me, the undersigned, a Notary Public in and for said County and State, this 4th day of December, 1990, personally appeared:

Dated this 4th Day of December, 1990

*Gary L. Moon*  
GARY L. MOON  
*Kathleen M. Moon*  
KATHLEEN M. MOON

\*\* GARY L. MOON and KATHLEEN M. MOON, husband and wife \*\*

And, acknowledged the execution of the foregoing deed. In witness whereof, I have hereunto subscribed my name and affixed my official seal. My commission expires March 5, 1991

*Vincent Zunica*  
VINCENT ZUNICA, Notary Public.  
Resident of Lake County.

This instrument prepared by RICHARD A. ZUNICA, 162 Washington Street, Lowell, IN 46356 Attorney at Law

STATE OF INDIANA  
FILED  
DEC 5 1990  
ROBERT REED  
15 MAR 91

7.00  
P/dck