

L2830

THIS FORM HAS BEEN APPROVED BY THE INDIANA STATE BAR ASSOCIATION FOR USE BY LAWYERS ONLY. THE SELECTION OF A FORM OF INSTRUMENT, FILLING IN BLANK SPACES, STRIKING OUT PROVISIONS AND INSERTION OF SPECIAL CLAUSES, CONSTITUTES THE PRACTICE OF LAW AND MAY ONLY BE DONE BY A LAWYER.

Mail tax bills to:
620 Cottonwood Drive
Dyer, IN 46311

137115

WARRANTY DEED

Tax Key No.: 14-142-38
COMMUNITY TITLE CO.
421 W. 81st Avenue
Merrillville, IN 46410

This indenture witnesseth that David C. Popiolek and Linda S. Popiolek, husband and wife

of Lake County in the State of Indiana

Convey and warrant to Robert Rovai and Ann M. Rovai, husband and wife

of Lake County in the State of Indiana for and in consideration of \$10.00 and other good and valuable consideration the receipt whereof is hereby acknowledged, the following Real Estate in Lake County in the State of Indiana, to wit:

STATE OF INDIANA / S.S. NO.
LAKE COUNTY
FILED FOR RECORDING
DEC 3 3 57 PM '90
ROBERT REC.

Lot 38, in Pheasant Hills Addition, Unit 5, to the Town of Dyer, as per plat thereof, recorded in Plat Book 43, page 23, in the Office of the Recorder of Lake County, Indiana.

Document is NOT OFFICIAL!
14-142-38

Commonly known as: 620 Cottonwood, Dyer, IN

Subject to past and current year real estate taxes.

Subject to easements, restrictions, and covenants of record, if any.

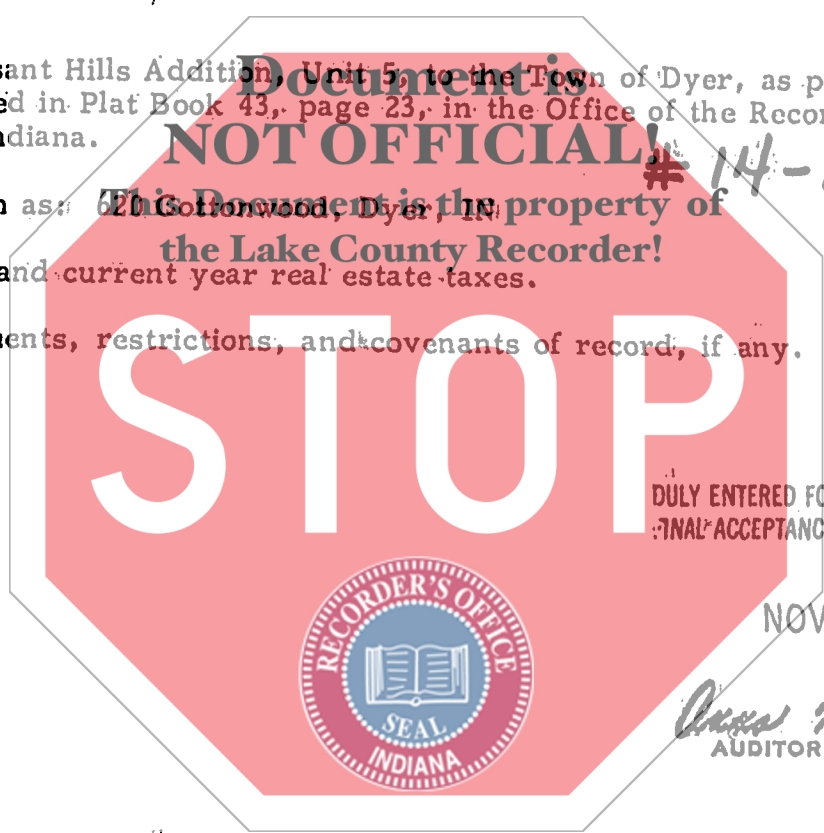

State of Indiana, Lake County, ss:
Before me, the undersigned, a Notary Public in and for said County and State, this 21st day of November 19 90 personally appeared:

David C. Popiolek and Linda S. Popiolek, husband and wife

Dated this 21st Day of November 1990

David C. Popiolek
David C. Popiolek

Linda S. Popiolek
Linda S. Popiolek

And acknowledged the execution of the foregoing deed. In witness whereof, I have hereunto subscribed my name and affixed my official seal. My commission expires 12-13-93 19

Kimberly S. Hauk
Kimberly S. Hauk Notary Public

Resident of Lake County.

This instrument prepared by David C. Popiolek and Linda S. Popiolek

001305