

THIS FORM HAS BEEN APPROVED BY THE INDIANA STATE BAR ASSOCIATION FOR USE BY LAWYERS ONLY. THE SELECTION OF A FORM OF INSTRUMENT, FILLING IN BLANK SPACES, STRIKING OUT PROVISIONS AND INSERTION OF SPECIAL CLAUSES, CONSTITUTES THE PRACTICE OF LAW AND MAY ONLY BE DONE BY A LAWYER.

Mail tax bills to: **102503**
8325 Burr
Crown Point, IN 46307

Tax Key No.: 36-125-29

WARRANTY DEED

CHICAGO TITLE INSURANCE COMPANY
STATE OF INDIANA DIVISION
RECORDED
MAY 24 1 18 PM '90

This indenture witnesseth that DONALD LEWIS STILLER of St. Lucie County, Florida, and SANDRA STILLER, Tenants in Common

of Martin County in the State of Florida
C.

Convey and warrant to CLYDE/WOLFE

of Lake County in the State of Indiana

for and in consideration of Ten Dollars (\$10.00) and other good and valuable consideration the receipt whereof is hereby acknowledged, the following Real Estate in Lake County in the State of Indiana, to wit:

36-125-29
Lot 81 and the South 8 1/3 feet of Lot 80, Stafford and Trankle's Seventh Addition to Hammond, as shown in Plat Book 6, page 42, in Lake County, Indiana.

Commonly known as: 4911 Ash Avenue, Hammond, Indiana 46327.

Subject to past and current year real estate taxes.
Subject to easements, restrictions and covenants of record, if any.

For and in consideration of Ten Dollars (\$10.00) cash in hand paid, the receipt of which is hereby acknowledged, and other good and valuable consideration, a part of which is the assumption of one certain trust deed dated January 20, 1977 and filed for record February 4, 1977, in the office of the recorder of deeds of Lake County, Indiana as Document No. 391709, and note of even date thereby secured, in the original principal amount of \$22,900.00, payable to Great Lakes Mortgage Corporation, an Illinois corporation, now known as Lomas Mortgage USA, Inc., which debt the grantee herein assumes the obligations of Donald Lewis Stiller and Sandra Stiller, his wife, under the terms of the instruments creating the loan to indemnify the Veterans Administration to the extent of any claim payment arising from the guaranty or insurance of the indebtedness above mentioned, said mortgage balance being \$18,418.01.

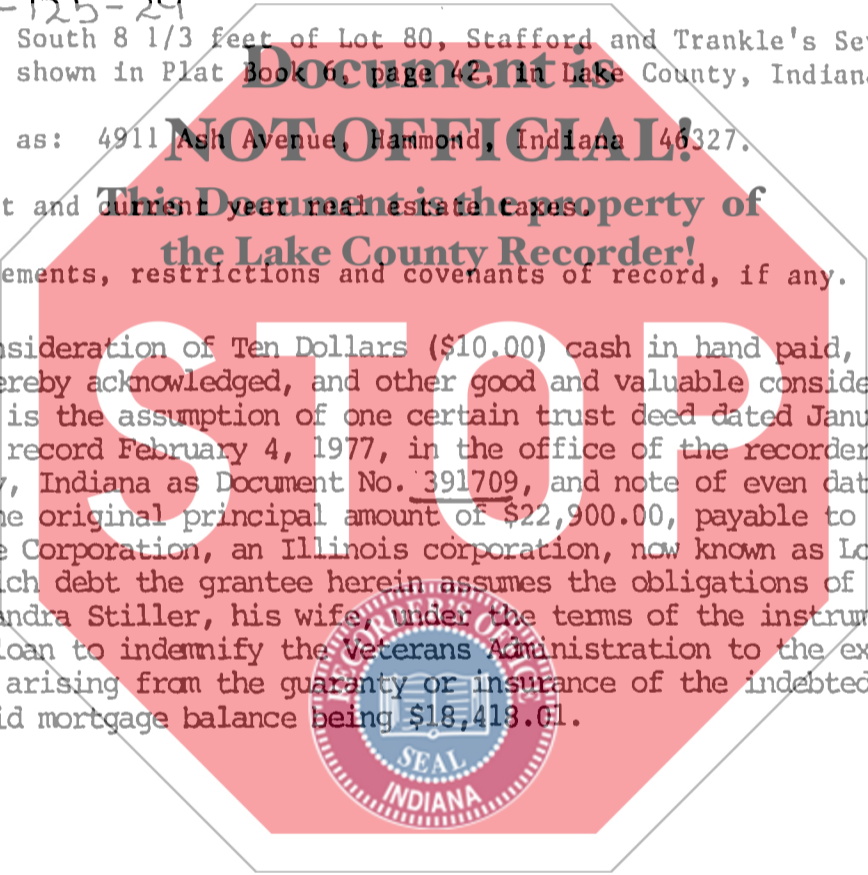

State of Indiana, Lake County, ss:
Before me, the undersigned, a Notary Public in and for said County and State, this 15th day of May 1990 personally appeared:

DONALD LEWIS STILLER of St. Lucie County, Florida, by Kay Blissmer, per Power of Attorney, and SANDRA STILLER, of Martin County, Florida, by Kay Blissmer, per Power of Attorney

Dated this 15th Day of May 1990

Donald Lewis Stiller, by Kay Blissmer POA
DONALD LEWIS STILLER, by KAY BLISSMER, per Power of Attorney

Sandra Stiller, by Kay Blissmer POA
SANDRA STILLER, by KAY BLISSMER, per Power of Attorney

And acknowledged the execution of the foregoing deed. In witness whereof, I have hereunto subscribed my name, and affixed my official seal. My commission expires Nov 21 1993

Christine S. Dudley
Christine S. Dudley Notary Public

Resident of Lake County.

DULY ENTERED FOR TAXATION SUBJECT TO FINAL ACCEPTANCE FOR TRANSFER.

MAY 24 1990

Anna M. Antox
AUDITOR LAKE COUNTY 001207

This instrument prepared by JOHN D. BRECLAW
735 West Glen Park Avenue
Griffith, Indiana 46319

Attorney at Law