

Use of this form constitutes practice of law and is limited to practicing lawyers.
©Copyright, 1986, by Indianapolis Bar Association.

Rev. 10/86

102373

KEY
Parcel No. 15-241-11 Unit #8

LAWYERS TITLE INS. CORP.
ONE PROFESSIONAL CENTER
SUITE 215
MERRILLVILLE, IN 46307

WARRANTY DEED

THIS INDENTURE WITNESSETH, That MARK A. PSIMOS

(Grantor)
of LAKE County, in the State of INDIANA, CONVEYS
AND WARRANT S. to MARTIN H. HACKETT

(Grantee)
of LAKE County, in the State of INDIANA, for the sum
of TEN AND 00/100-----Dollars (\$ 10.00) and other
valuable consideration, the receipt and sufficiency of which is hereby acknowledged, the following
described real estate in LAKE County, State of Indiana:

Lot 11 in Block 3 in Country Club Second Addition, Section "C",
in the Town of Merrillville, as shown in Plat Book 30, page 78,
Lake County, Indiana.

Subject to all real estate taxes payable.

Subject further to all easements, covenants, restrictions and
easements of record.

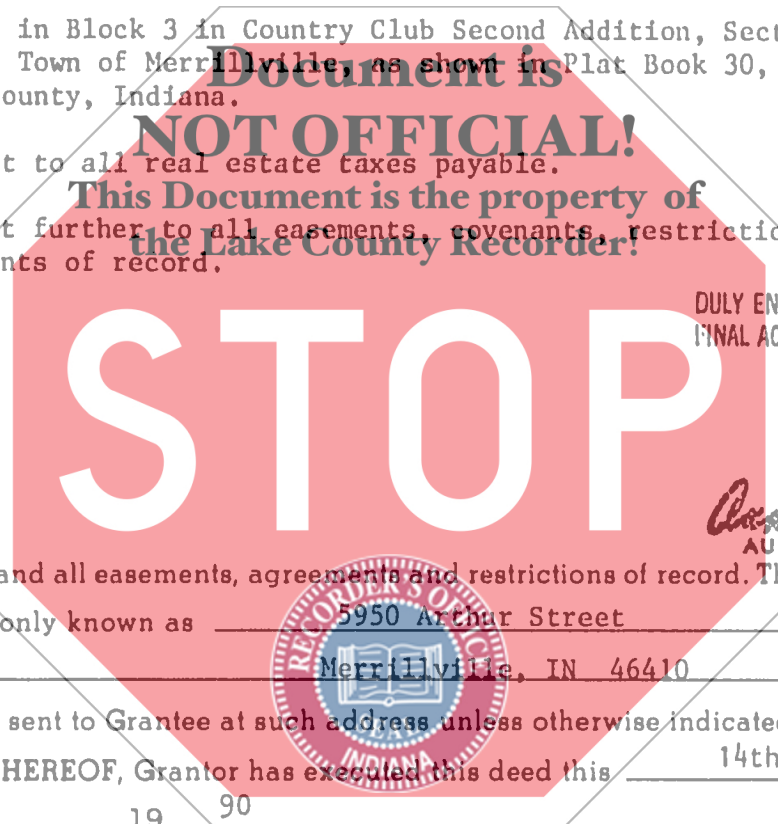

Subject to any and all easements, agreements and restrictions of record. The address of such
real estate is commonly known as 5950 Arthur Street
Merrillville, IN 46410

Tax bills should be sent to Grantee at such address unless otherwise indicated below.

IN WITNESS WHEREOF, Grantor has executed this deed this 14th day of
May, 1990

Grantor: _____ (SEAL)
Signature Mark Psimos
Printed MARK A. PSIMOS

Grantor: _____ (SEAL)
Signature _____
Printed _____

STATE OF Indiana }
COUNTY OF Lake } SS: ACKNOWLEDGMENT

Before me, a Notary Public in and for said County and State, personally appeared
MARK A PSIMOS

who acknowledged the execution of the foregoing Warranty Deed, and who, having been duly
sworn, stated that any representations therein contained are true.

Witness my hand and Notarial Seal this 14th day of May, 1990.

My commission expires 9-17-93
Signature Andrea A Plasencia
Printed Andrea A Plasencia, Notary Public

Resident of Lake County, Indiana.
IN 46410

This instrument prepared by HARRY A. PSIMOS, 7887 Bwy, Merrillville, Attorney at Law.

Return deed to _____

Send tax bills to Lake Mortgage Co 4000 W Lincoln Highway Merrillville IN 46410

000885

500