

THIS FORM HAS BEEN APPROVED BY THE INDIANA STATE BAR ASSOCIATION FOR USE BY LAWYERS ONLY. THE SELECTION OF A FORM OF INSTRUMENT, FILLING IN BLANK SPACES, STRIKING OUT PROVISIONS AND INSERTION OF SPECIAL CLAUSES, CONSTITUTES THE PRACTICE OF LAW AND MAY ONLY BE DONE BY A LAWYER.

27-328-2

Tax Key No.:

Mail tax bills to: 100921
9306 Saric Drive
Highland, IN 46322

WARRANTY DEED

CHICAGO TITLE INSURANCE COMPANY
INDIANA DIVISION

This indenture witnesseth that ---JOHN W. McCLELLAN and LINDA A. McCLELLAN,
husband and wife, as tenants by the entireties---

of Lake County in the State of Indiana

Convey and warrant to ---JOHN F. WILLIAMS and DEBRA L. WILLIAMS, husband
and wife, as tenants by the entireties---

of Lake County in the State of Indiana
for and in consideration of Ten Dollars (\$10.00) & other good & valuable consideration
the receipt whereof is hereby acknowledged, the following Real Estate in Lake County
in the State of Indiana, to wit:

Lot 2, except the south 2 feet thereof, block 10, Ellendale 3rd
Addition to the Town of Highland, as shown in Plat Book 34, page 94,
in Lake County, Indiana,

And commonly known as 9306 Saric Drive, Highland, Indiana.

Subject to easements, covenants and restrictions of record.

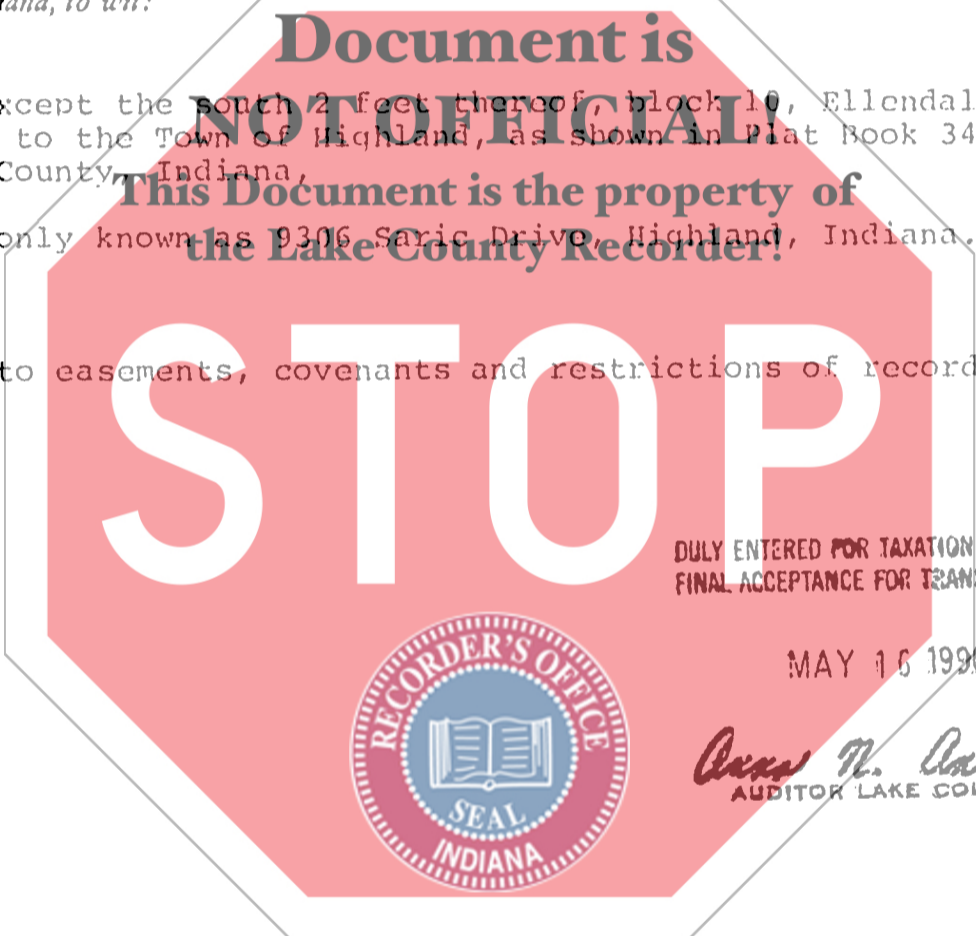

DULY ENTERED FOR TAXATION SUBJECT TO
FINAL ACCEPTANCE FOR TRANSFER.

MAY 16 1990

James H. Antox
AUDITOR LAKE COUNTY

State of Indiana, Lake County, ss:

Before me, the undersigned, a Notary Public in and for said County
and State, this 25 day of APRIL 1990
personally appeared:

JOHN W. McCLELLAN
LINDA A. McCLELLAN

Dated this 25 Day of APRIL 1990

John W. McClellan
JOHN W. McCLELLAN
Linda A. McClellan
LINDA A. McCLELLAN

And acknowledged the execution of the foregoing deed. In witness
whereof, I have hereunto subscribed my name and affixed my of-
ficial seal. My commission expires 4-26-1993

Mary Coleman
Mary Coleman Notary Public

Resident of LAKE County.

000282 500 CK

This instrument prepared by M. JEAN RAWSON, 905 Ridge Rd., Munster, IN 46321 Attorney at Law
(219) 836-1413