

#0 447683

THIS FORM HAS BEEN APPROVED BY THE INDIANA STATE BAR ASSOCIATION FOR USE BY LAWYERS ONLY. THE SELECTION OF A FORM OF INSTRUMENT, FILLING IN BLANK SPACES, STRIKING OUT PROVISIONS AND INSERTION OF SPECIAL CLAUSES, CONSTITUTES THE PRACTICE OF LAW AND MAY ONLY BE DONE BY A LAWYER.

Mail tax bills to: 7339 Tapper Avenue, Hammond, IN 46324

Tax Key No.: 33-94-26

100907

# WARRANTY DEED

This indenture witnesseth that Andrea Gyure-Bradley-Latham, formerly known as Andrea Lee Bradley, also known as Andrea L. Bradley Gyure

of Lake County in the State of Indiana

Convey and warrant to Clarendon James Miller and Constance Coffman-Miller, Husband and Wife

of Lake County in the State of Indiana for and in consideration of ten dollars and other good and valuable considerations. the receipt whereof is hereby acknowledged, the following Real Estate in Lake County in the State of Indiana, to wit:

Lot 27 and the North 12-1/2 feet of Lot 26, Block 4, Ford-Roxana Addition to the city of Hammond, as shown in Plat Book 20, Page 23, in Lake County, Indiana.

Key # 33-94-26  
Unit # 26

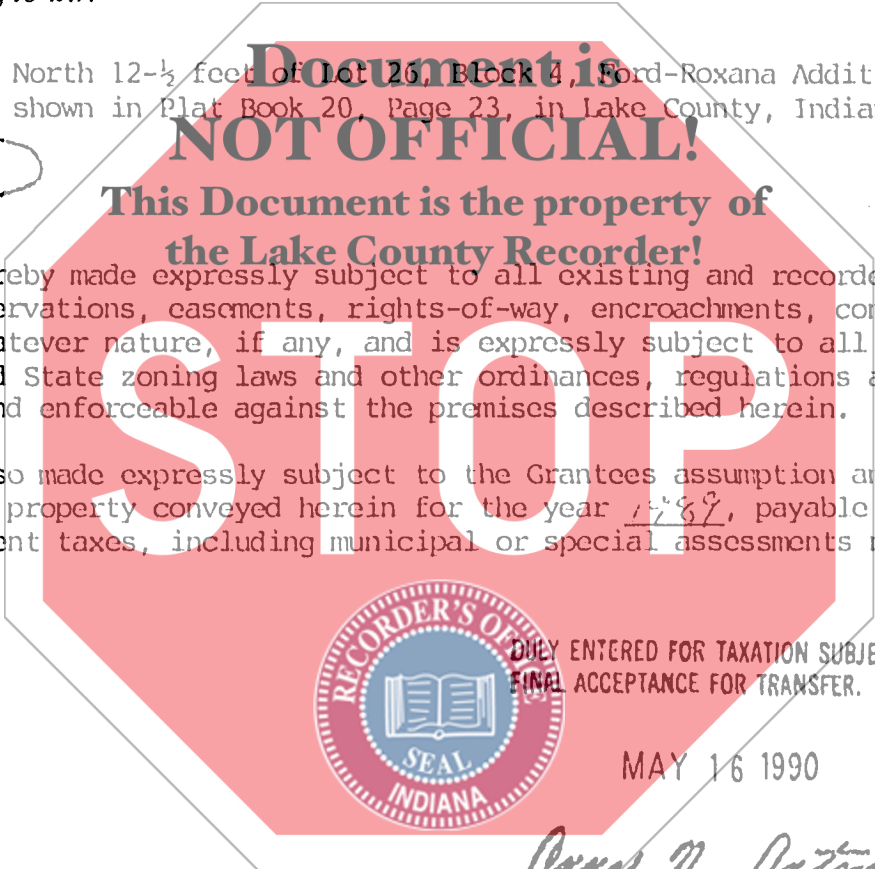

This deed is hereby made expressly subject to all existing and recorded restrictions, exceptions, reservations, easements, rights-of-way, encroachments, conditions and covenants of whatever nature, if any, and is expressly subject to all municipal, City, County and State zoning laws and other ordinances, regulations and restrictions applicable to and enforceable against the premises described herein.

This deed is also made expressly subject to the Grantees assumption and payment of taxes on the property conveyed herein for the year 1989, payable in 1990, and all subsequent taxes, including municipal or special assessments now or hereafter levied.

*Anna N. Antonio*  
AUDITOR LAKE COUNTY

State of Indiana, Lake County, ss:

Dated this 2nd Day of May 1990

Before me, the undersigned, a Notary Public in and for said County and State, this 2nd day of May 1990 personally appeared:

Andrea Gyure-Bradley-Latham, formerly known as Andrea Lee Bradley, also known as Andrea L. Bradley Gyure.

*Andrea Gyure-Bradley-Latham*  
Andrea Gyure-Bradley-Latham, formerly known as Andrea Lee Bradley, also known as Andrea L. Bradley Gyure.

*Andrea Lee Bradley*

*Andrea L. Bradley Gyure*

And acknowledged the execution of the foregoing deed. In witness whereof, I have hereunto subscribed my name and affixed my official seal. My commission expires November 27 1993

*Christine S. Dudley*  
Christine S. Dudley Notary Public

Resident of Lake County.

This instrument prepared by Michael W. Bosch, 7150 Indianapolis Blvd., Hammond, IN 46323 (219) 844-3020 Attorney at Law

000467 500 OK

CHICAGO TITLE INSURANCE COMPANY  
STATE OF INDIANA DIVISION  
MAY 17 1990