

2800 Wyoming ST. LAKE STATION 46405

THIS FORM HAS BEEN APPROVED BY THE INDIANA STATE BAR ASSOCIATION FOR USE BY LAWYERS ONLY. THE SELECTION OF A FORM OF INSTRUMENT, FILLING IN BLANK SPACES, STRIKING OUT PROVISIONS AND INSERTION OF SPECIAL CLAUSES, CONSTITUTES THE PRACTICE OF LAW AND MAY ONLY BE DONE BY A LAWYER.

Mail tax bills to: 0977:7

Tax Key No.:

660 E. Botherfield Rd. Lombard, IL 60148

# WARRANTY DEED

This indenture witnesseth that ERNESTO DE LEON CRUZ AND URSULA CRUZ, Husband and Wife.

of DUPAGE County in the State of ILLINOIS

Convey and warrant to DOMINGO SANTIAGO-VEGA

of LAKE County in the State of INDIANA for and in consideration of TEN & 001/00 DOLLARS & OTHER VALUABLE CONSIDERATION the receipt whereof is hereby acknowledged, the following Real Estate in LAKE County in the State of Indiana, to wit:

Lot 6 in Block 1 in First Addition to Liverpool Home Gardens, as per plat thereof, recorded in Plat Book 24 page 20, in the Office of the Recorder of Lake County, Indiana.

This Document is the property of the Lake County Recorder!

Subject to all covenants, easements and restrictions of record.

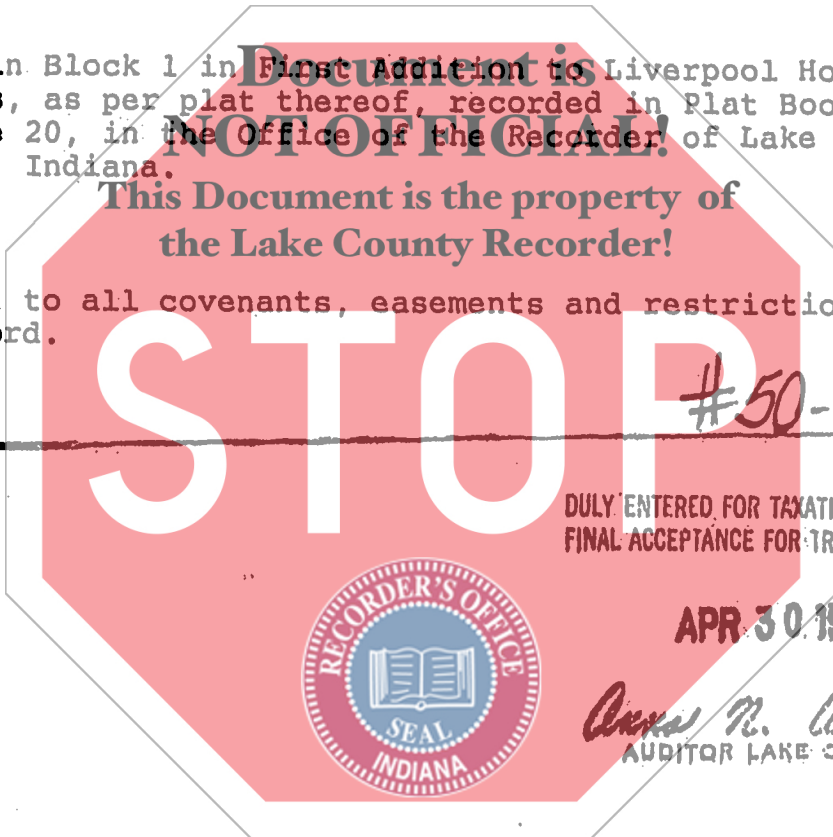

STATE OF INDIANA/S.S. NO. LAKE COUNTY FILED FOR RECORD APR 30 12 56 PM '90 ROBERT JOE FREELAND RECORDER

#50-147-6

DULY ENTERED FOR TAXATION SUBJECT TO FINAL ACCEPTANCE FOR TRANSFER.

APR 30 1990

Anna M. Antone AUDITOR LAKE COUNTY

State of Indiana, LAKE County, ss: Dated this 9 Day of Oct. 1988

Before me, the undersigned, a Notary Public in and for said County and State, this 9 day of Oct 1988 personally appeared: ERNESTO DE LEON CRUZ AND URSULA CRUZ, Husband and Wife.

Ernesto de Leon Cruz Seal ERNESTO DE LEON CRUZ Ursula Cruz Seal URSULA CRUZ Seal Seal Seal Seal Seal

And acknowledged the execution of the foregoing deed. In witness whereof, I have hereunto subscribed my name and affixed my official seal. My commission expires 1990

Notary Public HERMAN R. PEREZ JOHN W. PETERS

Resident of Portage Attorney at Law 001809

This instrument prepared by JOHN W. PETERS 6195 Central Ave. Portage, IN 46368 219/762-0402