

THIS FORM HAS BEEN APPROVED BY THE INDIANA STATE BAR ASSOCIATION FOR USE BY LAWYERS ONLY. THE SELECTION OF A FORM OF INSTRUMENT, FILLING IN BLANK SPACES, STRIKING OUT PROVISIONS AND INSERTION OF SPECIAL CLAUSES, CONSTITUTES THE PRACTICE OF LAW AND MAY ONLY BE DONE BY A LAWYER.

Mall tax bills to:
9142 Cottage Grove Avenue
Highland, IN 46322

Tax Key No.: 27-300-13

WARRANTY DEED

This indenture witnesseth that ROBERT M. KEKEIS and SHIRLEY A. KEKEIS,
Husband and Wife

of Lake County in the State of Indiana

Convey and warrant to GEORGE SEOLAS and JANE M. SEOLAS,
Husband and Wife

of Lake County in the State of Indiana
for and in consideration of Ten Dollars (\$10.00) and other good and valuable consideration
the receipt whereof is hereby acknowledged, the following Real Estate in Lake County
in the State of Indiana, to wit:

Lot 171, Southtown Estates 4th Addition to the Town of Highland,
as shown in Plat Book 33, Page 3, in Lake County, Indiana.
Commonly known as: 9142 Cottage Grove Avenue, Highland, Indiana 46322.
Subject to past and current year real estate taxes.
Subject to easements, restrictions and covenants of record, if any;

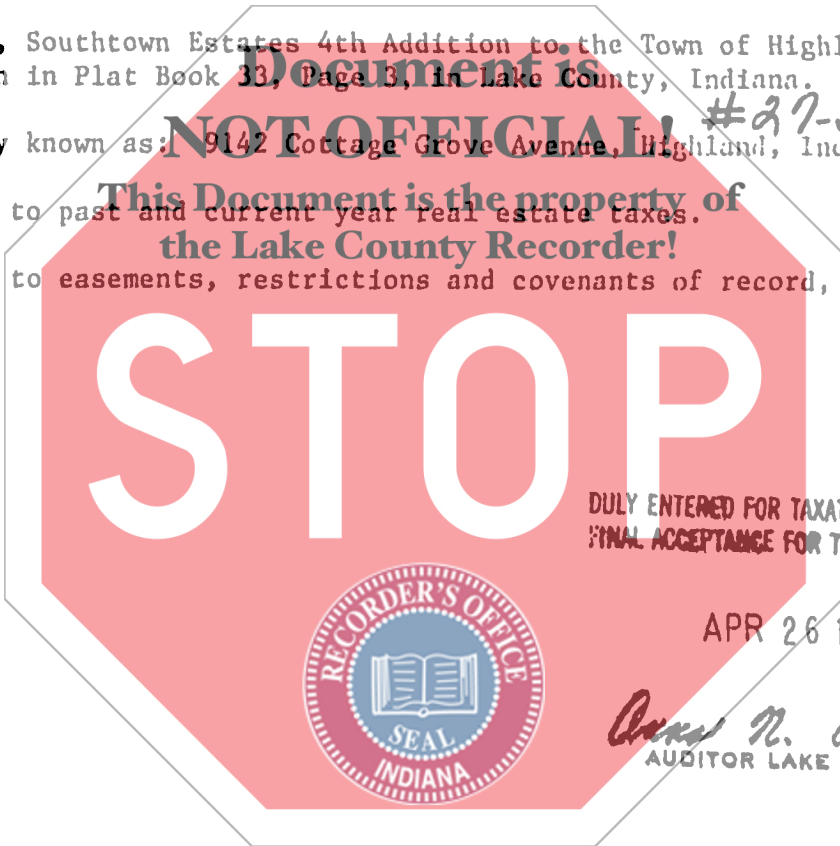

DULY ENTERED FOR TAXATION SUBJECT TO
FINAL ACCEPTANCE FOR TRANSFER.

APR 26 1990

Carol N. Anton
AUDITOR LAKE COUNTY

State of Indiana, Lake County, ss:
Before me, the undersigned, a Notary Public in and for said County
and State, this 13th day of April 19 90
personally appeared:

ROBERT M. KEKEIS and SHIRLEY A. KEKEIS,
Husband and Wife

Dated this 13th Day of April 19 90

Robert M. Kekeis
ROBERT M. KEKEIS

Shirley A. Kekeis
SHIRLEY A. KEKEIS

And acknowledged the execution of the foregoing deed. In witness
whereof, I have hereunto subscribed my name and affixed my of-
ficial seal. My commission expires November 27 19 93

Christine S. Dudley
Christine S. Dudley Notary Public

Resident of Lake County.

This instrument prepared by JOHN D. BRECLAW
735 West Glen Park Avenue
Griffith, Indiana 46319

001134
Attorney at Law

CHICAGO TITLE INSURANCE COMPANY

500