

THIS FORM HAS BEEN APPROVED BY THE INDIANA STATE BAR ASSOCIATION FOR USE BY LAWYERS ONLY. THE SELECTION OF A FORM OF INSTRUMENT, FILLING IN BLANK SPACES, STRIKING OUT PROVISIONS AND INSERTION OF SPECIAL CLAUSES, CONSTITUTES THE PRACTICE OF LAW AND MAY ONLY BE DONE BY A LAWYER.

Mail tax bills to: **096711**

Tax Key No.: _____

2553 East Lake Shore Drive
Crown Point IN 46307

WARRANTY DEED

This indenture witnesseth that BRUCE GERALD SWIFT & MARY ANN SWIFT,
Husband and Wife

of Lake County in the State of Indiana

Convey and warrant to WINFIELD SQUARE, INC.

of Lake County in the State of Indiana
for and in consideration of ten (\$10.00) dollars and other good and valuable consideration
the receipt whereof is hereby acknowledged, the following Real Estate in Lake County
in the State of Indiana, to wit:

The North 200 feet, EXCEPT the East 377.235 feet thereof, AND EXCEPT the West 720 feet thereof, of Tract 14, Lakes of the Four Seasons, Unit 2, as shown in Plat Book 37, page 76, in Lake County, Indiana, Containing 1.033 Acres, more or less, and subject to all legal highways and easements.

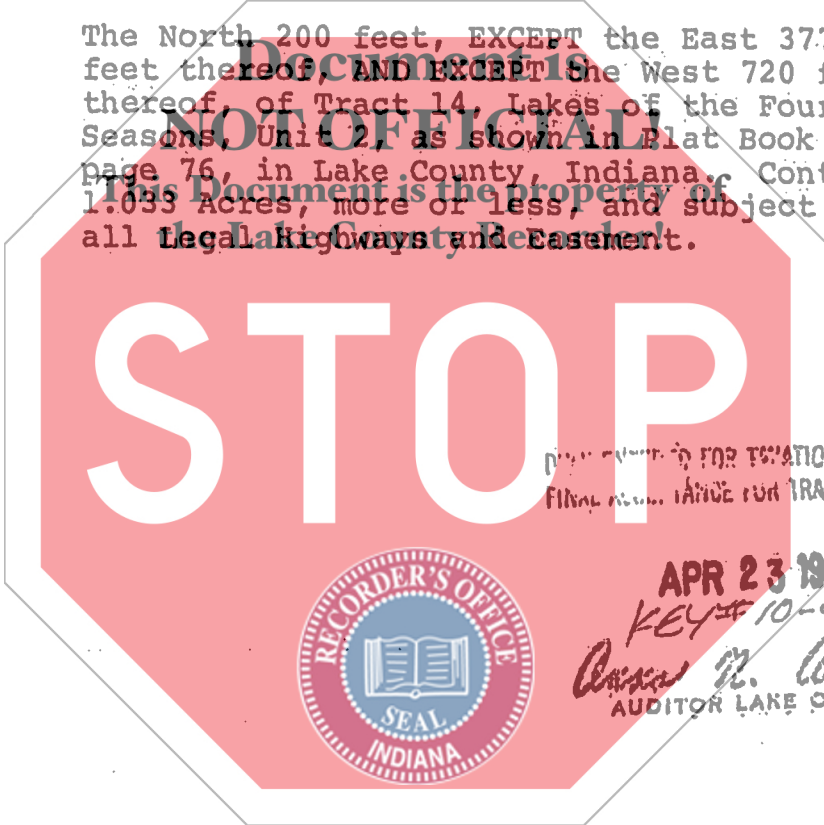

State of Indiana, Lake County, ss:

Before me, the undersigned, a Notary Public in and for said County and State, this 3rd day of April 1990 personally appeared:

Bruce Gerald Swift & Mary Ann Swift
Husband & Wife

Dated this 3rd Day of April 1990

Bruce Gerald Swift
Bruce Gerald Swift
Mary Ann Swift
Mary Ann Swift
STATE OF INDIANA / S. NO. FILED FOR RECORD / LAKE COUNTY / APR 24 8 47 AM '90 / RECORDER

And acknowledged the execution of the foregoing deed. In witness whereof, I have hereunto subscribed my name and affixed my official seal. My commission expires April 6 1990

Jacqueline R. Lewis
Jacqueline R. Lewis
Notary Public
Resident of Lake County

This instrument prepared by J.J. Stankiewicz, 7870 Broadway, Merrillville, Indiana 46410 (219) 769-1177 Attorney at Law

001340
5.04