

096237

Mail Tax Bills To:

Cleveland & Ruby Cox
1740 Roosevelt Place
Gary, IN 46404

WARRANTY DEED

This indenture witnesseth that

Lois Crook and Sherrel Chancelor as joint tenants
with right of survivorship

of Lake County in the State of Indiana

Conveys and Warrants to

Cleveland Cox and Ruby Cox
(Husband and Wife)

of Lake County in the State of Indiana, for and in
consideration of Ten Dollars (\$10.00) and other good and
valuable considerations the receipt whereof is hereby
acknowledged, the following Real Estate in Lake County in
the State of Indiana, to-wit:

Key 49-454-13

Lot 13, Block 2, Midway Gardens Second
Addition, as shown in plat Book 27, page
39, in the office of the Recorder of Lake
County, Indiana.
(2320-2322 Hanely Street, Gary, Indiana)

This conveyance is subject to easements,
covenants, reservations, exceptions, and
restrictions of record; zoning ordinances
and to subdivision regulations and laws,
if any; real estate taxes for the year
1988 payable in 1989 and 1989 payable in
1990; and all encroachments which might be
revealed from an inspection of the
premises.

IN WITNESS WHEREOF, The said Lois Crook Has hereunto set
her Hand and seal this 6 day of April, 1990.

DULY ENTERED FOR TAXATION SUBJECT TO
FINAL ACCEPTANCE FOR TRANSFER.

APR 16 1990

Lois Crook (SEAL)
Lois Crook

Alan N. Antos
AUDITOR LAKE COUNTY

Sherrel Chancelor (SEAL)
Sherrel Chancelor

STATE OF INDIANA, Lake County, ss:
Before me the undersigned, a Notary Public in and for said
County and State, personally appeared the within named Lois
Crook who acknowledged the execution of the foregoing Deed to be
her voluntary act and deed.

WITNESS, my hand and my Seal this 6th day
of April, 1990.

My commission expires:
7/5/93

Grace M. [Signature]
Notary Public
Resident of Lake County

This instrument prepared by John Maksimovich, HYATT LEGAL
SERVICES, 1165 E. Ridge Road, Griffith, Indiana 46319. 5.00

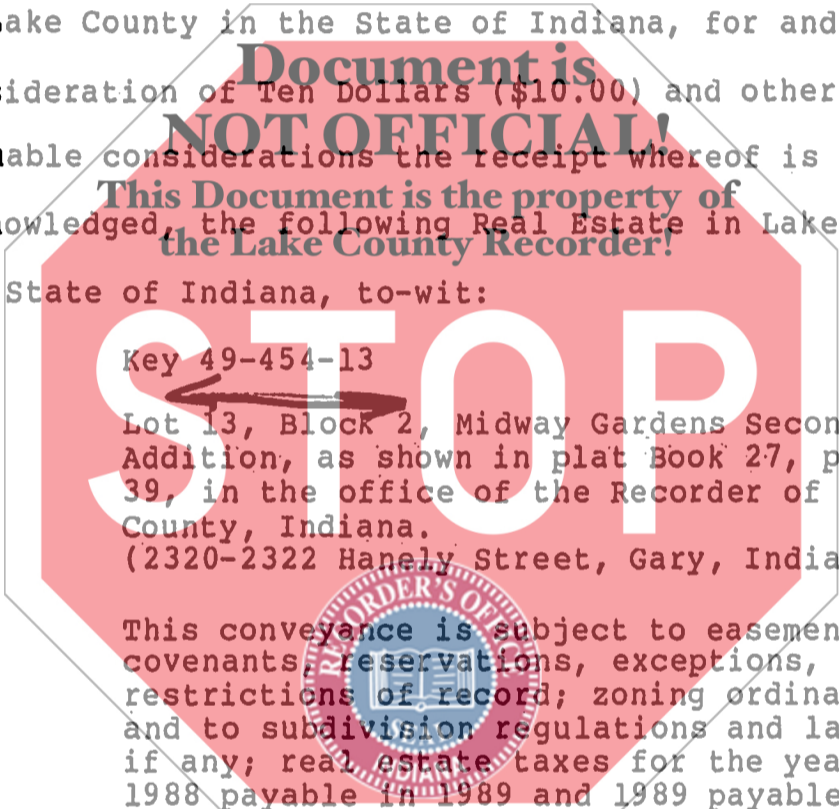

STATE OF INDIANA/S.S. NO.
LAKE COUNTY
FILED FOR RECORD
APR 20 10 24 AM '90
ROBERT J. COE
RECORDER
WELLS