

Com 15/059
Kewia Kwiski
096169

Ticor Title Insurance

Bank One, Merrillville
1000 E. 80th Pl,
Merrillville, IN 46410

ENVIRONMENTAL DISCLOSURE DOCUMENT FOR TRANSFER OF REAL PROPERTY

For Use By County Recorder's Office

County _____
Date _____
Doc. No. _____
Vol. _____
Page _____
Rec'd by: _____

STATE OF INDIANA/S.S. NO.
LAKE COUNTY
FILED IN 096169
APR 20 8 46 AM '90
ROBERT J. ...
RECORDER

TICOR TITLE INSURANCE
Crown Point, Indiana

The following information is provided under IC 13-7-22, the Responsible Property Transfer Law.

I. PROPERTY IDENTIFICATION

A. Address of property: 1006 North Indiana Avenue Street
Crown Point, Indiana 46307 City or Town Township

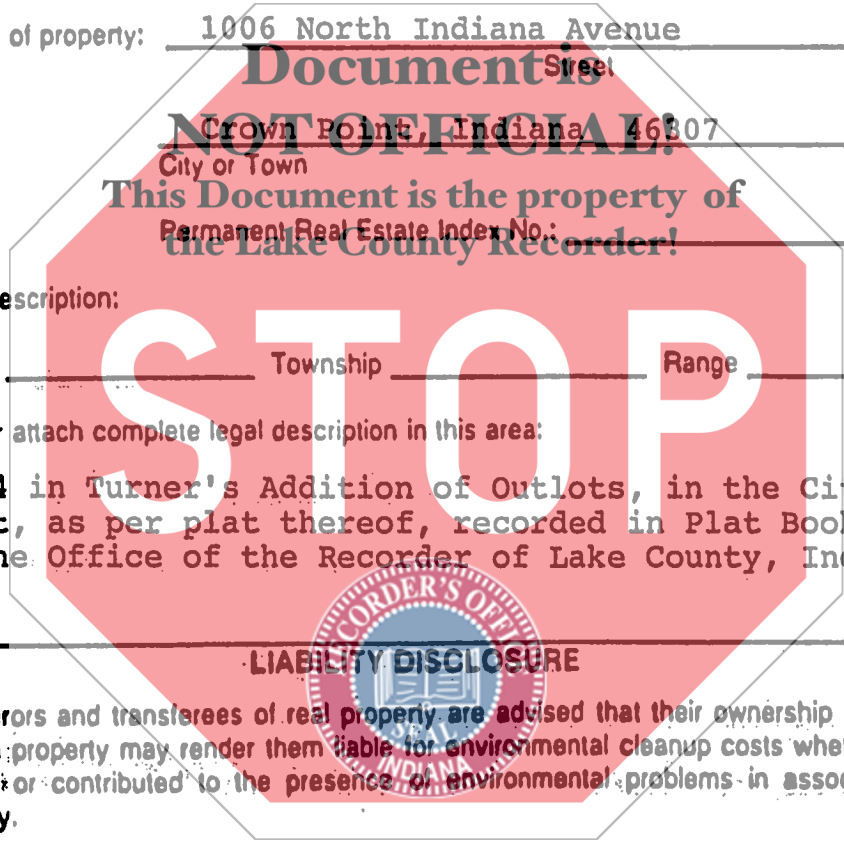

B. Legal Description:
Section _____ Township _____ Range _____
Enter or attach complete legal description in this area:
Lot 4 in Turner's Addition of Outlots, in the City of Crown Point, as per plat thereof, recorded in Plat Book 1 page 8, in the Office of the Recorder of Lake County, Indiana.

LIABILITY DISCLOSURE

Transferees and transferees of real property are advised that their ownership or other control of such property may render them liable for environmental cleanup costs whether or not they caused or contributed to the presence of environmental problems in association with the property.

C. Property Characteristics:

Lot Size 330 x 660 Acreage 5 more or less
more or less

Check all types of improvement and uses that pertain to the property:

- Apartment building (6 units or less)
- Commercial apartment (over 6 units)
- Store, office, commercial building
- Industrial building
- Farm, with buildings
- Other (specify)

FILED

APR 18 1990

Anna N. Antons
CLERK LAKE COUNTY

001093

05/11/90

II. NATURE OF TRANSFER

- | | Yes | No |
|--|-------------------------------------|-------------------------------------|
| A. (1) Is this a transfer by deed or other instrument of conveyance? | <input checked="" type="checkbox"/> | <input type="checkbox"/> |
| (2) Is this a transfer by assignment of over 25% of beneficial interest of a land trust? | <input type="checkbox"/> | <input checked="" type="checkbox"/> |
| (3) A lease exceeding a term of 40 years? | <input type="checkbox"/> | <input checked="" type="checkbox"/> |
| (4) A mortgage or collateral assignment of beneficial interest? | <input type="checkbox"/> | <input checked="" type="checkbox"/> |
| (5) A contract for the sale of property? | <input type="checkbox"/> | <input checked="" type="checkbox"/> |

B. (1) Identify Transferor:

United Brotherhood of Carpenters and Joiners of America
 Name and Current Address of Transferor Local 1005

Name and Address of Trustee if this is a transfer of beneficial interest of a land trust.

Trust No.

- (2) Identify person who has completed this form on behalf of the Transferor and who has knowledge of the information contained in this form:

GERRY L. NANNENGA - 780 UNION ST. HOBART, TN 46342-942-0518
 Name, Position (if any), and address PRES. - L.O. # 1005 Telephone No.

C. Identify Transferee:

Kwiatkowski Masonry, Inc.
 Name and current address of Transferee

III. ENVIRONMENTAL INFORMATION

A. Regulatory Information During Current Ownership

1. Has the transferor ever conducted operations on the property which involved the generation, manufacture, processing, transportation, treatment, storage, or handling of "hazardous waste," as defined by IC 13-7-1? This question does not apply to consumer goods stored or handled by a retailer in the same form and approximate amount, concentration, and manner as they are sold to consumers, unless the retailer has engaged in any commercial mixing (other than paint mixing or tinting of consumer sized containers), finishing, refinishing, servicing, or cleaning operations on the property.

Yes No

2. Has the transferor ever conducted operations on the property which involved the processing, storage, or handling of petroleum, other than that which was associated directly with the transferor's vehicle usage?

Yes No

3. Has the transferor ever conducted operations on the property which involved the generation, transportation, storage, treatment, or disposal of "hazardous waste," as defined in IC 13-7-1?

Yes No

4. Are there any of the following specific units (operating or closed) at the property that are used or were used by the transferor to manage hazardous wastes, hazardous substances, or petroleum?

| | Yes | No |
|--------------------------------|--------------------------|-------------------------------------|
| Landfill | <input type="checkbox"/> | <input checked="" type="checkbox"/> |
| Surface Impoundment | <input type="checkbox"/> | <input checked="" type="checkbox"/> |
| Land Treatment | <input type="checkbox"/> | <input checked="" type="checkbox"/> |
| Waste Pile | <input type="checkbox"/> | <input checked="" type="checkbox"/> |
| Incinerator | <input type="checkbox"/> | <input checked="" type="checkbox"/> |
| Storage Tank (Above Ground) | <input type="checkbox"/> | <input checked="" type="checkbox"/> |
| Storage Tank (Underground) | <input type="checkbox"/> | <input checked="" type="checkbox"/> |
| Container Storage Area | <input type="checkbox"/> | <input checked="" type="checkbox"/> |
| Injection Wells | <input type="checkbox"/> | <input checked="" type="checkbox"/> |
| Wastewater Treatment Units | <input type="checkbox"/> | <input checked="" type="checkbox"/> |
| Septic Tanks | <input type="checkbox"/> | <input checked="" type="checkbox"/> |
| Transfer Stations | <input type="checkbox"/> | <input checked="" type="checkbox"/> |
| Waste Recycling Operations | <input type="checkbox"/> | <input checked="" type="checkbox"/> |
| Waste Treatment Detoxification | <input type="checkbox"/> | <input checked="" type="checkbox"/> |
| Other Land Disposal Area | <input type="checkbox"/> | <input checked="" type="checkbox"/> |

If there are "YES" answers to any of the above items and the transfer of property that requires the filing of this document is other than a mortgage or collateral assignment of beneficial interest, you must attach to the copies of this document that you file with the county recorder and the department of environmental management a site plan that identifies the location of each unit.

5. Has the transferor ever held any of the following in regard to this real property?

(A) Permits for discharges of wastewater to waters of Indiana.

Yes No

(B) Permits for emissions to the atmosphere.

Yes No

(C) Permits for any waste storage, waste treatment, or waste disposal operation.

Yes No

6. Has the transferor ever discharged any wastewater (other than sewage) to a publicly owned treatment works?

Yes No

7. Has the transferor been required to take any of the following actions relative to this property?

(A) Filed an emergency and hazardous chemical inventory form pursuant to the federal Emergency Planning and Community Right-to-Know Act of 1986 (42 U.S.C. 11022).

Yes No

(B) Filed a toxic chemical release form pursuant to the federal Emergency Planning and Community Right-to-Know Act of 1986 (42 U.S.C. 11023).

Yes No

8. Has the transferor or any facility on the property or the property been the subject of any of the following state or federal governmental actions?

(A) Written notification regarding known, suspected, or alleged contamination on or emanating from the property.

Yes No

(B) Filing an environmental enforcement case with a court or the solid waste management board for which a final order or consent decree was entered.

Yes No

(C) If the answer to question (B) was Yes, then indicate whether or not the final order or decree is still in effect for this property.

Yes No

9. Environmental Releases During Transferor's Ownership.

(A) Has any situation occurred at this site which resulted in a reportable "release" of any hazardous substances or petroleum as required under state or federal laws?

Yes No

(B) Have any hazardous substances or petroleum which were released come into direct contact with the ground at this site?

Yes No

If the answers to questions (A) and (B) are Yes, have any of the following actions or events been associated with a release on the property?

Use of a cleanup contractor to remove or treat materials including soils, pavement, or other surficial materials?

Assignment of in-house maintenance staff to remove or treat materials including soils, pavement, or other surficial materials?

Sampling and analysis of soils?

Temporary or more long term monitoring of groundwater at or near the site?

Impaired usage of an on-site or nearby water well because of offensive characteristics of the water?

Coping with fumes from subsurface storm drains or inside basements?

Signs of substances leaching out of the ground along the base of slopes or at other low points on or immediately adjacent to the site?

10. Is the facility currently operating under a variance granted by the commissioner of the Indiana department of environmental management?

Yes No

ACKNOWLEDGEMENT OF TRANSFEROR

STATE OF INDIANA)
) SS:
COUNTY OF LAKE)

Before me, Heide M. Stanko, a Notary Public in and for said County and State, on this 26th day of January, 1990, personally appeared Gerry L. Nannenga, President, Local 1005, and Jeffrey Basco, Trustee, Local 1005

personally known to me, and known to me to be the person(s) who ~~XXX~~ (are) described in and who executed the foregoing document and acknowledged the same to be ~~XXX~~ (their) voluntary act and deed for the uses and purposes therein set forth.

WITNESS my hand and official seal.

Document is
NOT OFFICIAL

Heide M. Stanko
Heide M. Stanko, Notary Public

My Commission Expires: 1/17/92
This Document is the property of the Lake County Recorder!

Resident of Lake County

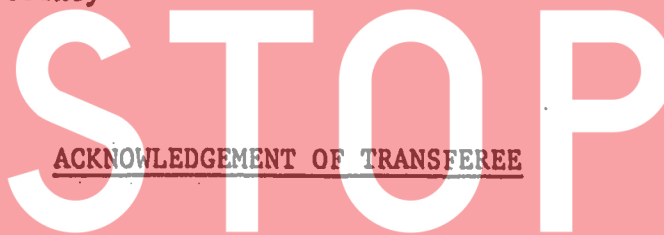

ACKNOWLEDGEMENT OF TRANSFEREE

STATE OF INDIANA)
) SS:
COUNTY OF LAKE)

Before me, Denise J. Clark, a Notary Public in and for said County and State, on this 30th day of January, 19 90, personally appeared Rick D. Kwiatkowski, President, Kwiatkowski Masonry, Inc.

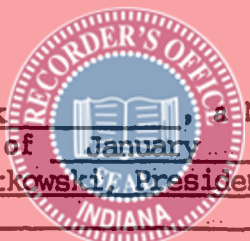

personally known to me, and known to me to be the person(s) who (is) ~~XXX~~ described in and who executed the foregoing document and acknowledged the same to be (his) ~~XXX~~ (their) voluntary act and deed for the uses and purposes therein set forth.

WITNESS my hand and official seal.

Denise J. Clark
Denise J. Clark, Notary Public

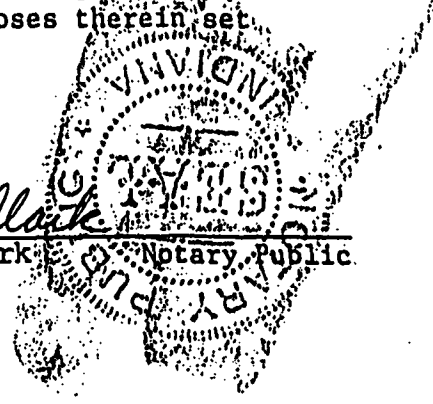

My Commission Expires:
12/28/90

Resident of Lake County

This document prepared by A. James Babusiak, Officer of Bank One, Merr., NA