

157719  
Larkin

THIS FORM HAS BEEN APPROVED BY THE INDIANA STATE BAR ASSOCIATION FOR USE BY LAWYERS ONLY. THE SELECTION OF A FORM OF INSTRUMENT, FILLING IN BLANK SPACES, STRIKING OUT PROVISIONS AND INSERTION OF SPECIAL CLAUSES, CONSTITUTES THE PRACTICE OF LAW AND MAY ONLY BE DONE BY A LAWYER.

Mail tax bills to: **095154**  
5526 Homerlee Ave  
East Chicago IN 46312

Tax Key No.:

# WARRANTY DEED

TICOR TITLE INSURANCE CO. OF INDIANA/S.S. NO.  
Highland, Indiana  
LAKE COUNTY  
FILED FOR RECORD

APR 20 9 49 AM '90  
ROBERT T. BREWSTER  
RECORDER

This indenture witnesseth that Lawrence J. Larkin

of Lake County in the State of Indiana

Convey and warrant to Leslie J. Larkin and Sue A. Larkin, husband and wife

of Lake County in the State of Indiana

for and in consideration of Ten Dollars, and Other good and valuable consideration the receipt whereof is hereby acknowledged, the following Real Estate in Lake County in the State of Indiana, to wit:

Lot 22, except the North 4 feet thereof, and the North 6 feet of Lot 23 in Block 4 in Roxana Park 4th Addition to East Chicago, as per plat thereof, recorded in Plat Book 29 page 47, in the Office of the Recorder of Lake County, Indiana. Commonly known as 5526 Homerlee Ave, East Chicago IN 46312

Subject to past and current year real estate taxes.  
Subject to easements, restrictions and covenants of record, if any.

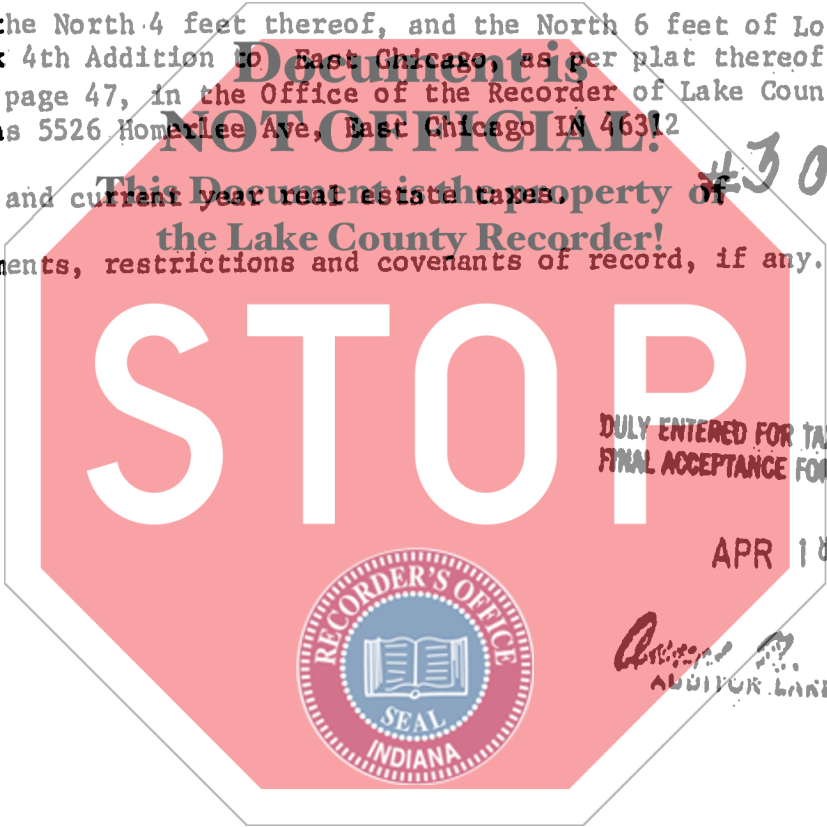

430-597-22

State of Indiana, Lake County, ss:  
Before me, the undersigned, a Notary Public in and for said County and State, this 29th day of March 19 90  
personally appeared:

Lawrence J. Larkin

Dated this 29 Day of March 1990

Lawrence J. Larkin  
Lawrence J. Larkin

And acknowledged the execution of the foregoing deed. In witness whereof, I have hereunto subscribed my name and affixed my official seal. My commission expires 12-3 1993

John McMichael  
John McMichael Notary Public

Resident of Lake County.

This instrument prepared by JOHN D. BREGLAW  
735 West Glen Park Avenue  
Griffith, Indiana 46319

000284  
Attorney at Law

500  
to