

096014 Real Estate Mortgage

1528 W. 74th Ave
Merrillville In
46400

This Indenture Witnesseth, That *WALTER J AND PATRICIA McLaughlin*

APR 19 10 54 AM '90
ROBERT BOB REBLAND
RECORDER

STATE OF INDIANA
LAKE COUNTY
FILE FOR RECORD

of *LAKE* County, in the State of *INDIANA*
Mortgage and Warrant to *Esther Plinovich*

of *PORTER* County, in the State of *INDIANA*, the following described
Real Estate in *LAKE* County, in the State of Indiana, as follows, to-wit:

*Lot 69 AND the North 30 feet of Lot 70, New GARY
ANNEX Addition, AS SHOWN IN PLAT BOOK 22, PAGE 44,
IN LAKE COUNTY, INDIANA.*

Commonly known as: *6002 JEFFERSON
Merrillville, Indiana*

This mortgage to secure a note of the following terms:

1. Principle Amount of *Thirty Six Thousand Five Hundred Dollars (\$36,500.00)*
2. Principle balance due on or before *4/15/90* or any agreed upon extension date.
3. Interest on principle balance to be paid Monthly at the Rate of *TEN PERCENT PER ANNUM.*
4. MORTGAGORS MAY PAY ANY AMOUNT OF THE principle balance IN ADVANCE OF THE due date without penalty.

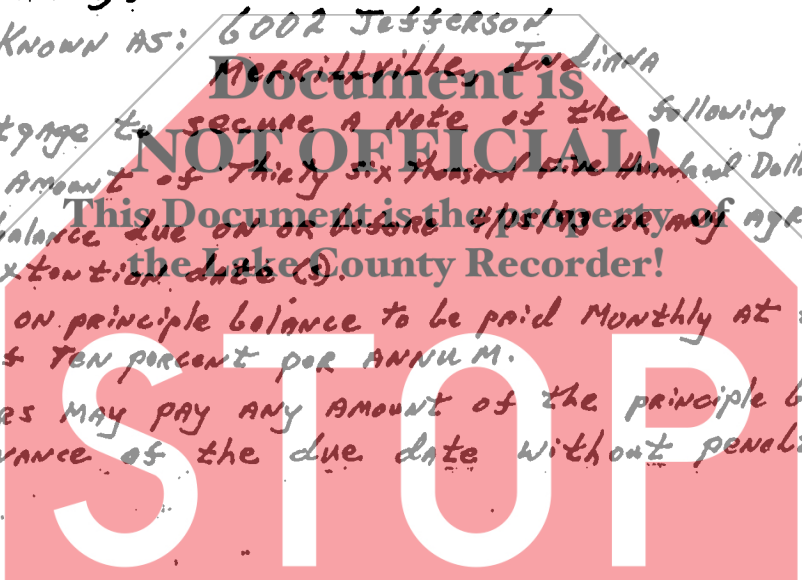

and the mortgagors expressly agree to pay the sum of money above secured, without relief from valuation or appraisal laws; and upon failure to pay any one of said notes, or any part thereof, at maturity, or the interest thereon, or any part thereof when due, or the taxes or insurance as hereinafter stipulated, then all of said notes are to be due and collectible, and this mortgage may be foreclosed accordingly. And it is further expressly agreed, that until all of said notes are paid, said mortgagors will keep all legal taxes and charges against said premises paid as they become due, and will keep the buildings thereon insured for the benefit of the mortgagee, as ~~in~~ interest may appear and the policy duly assigned to the mortgagee, to the amount of _____ Dollars, and failing to do so, said mortgagee, may pay said taxes or insurance, and the amount so paid, with *Ten* per cent interest thereon, shall be a part of the debt secured by this mortgage.

In Witness Whereof, We, the said mortgagor, have hereunto set their hands and seal this *16th* day of *APRIL* 19 *90*

(Seal) *Walter J McLaughlin* (Seal)
WALTER J McLaughlin
(Seal) *Patricia M McLaughlin* (Seal)
PATRICIA M McLaughlin
(Seal) _____ (Seal)

STATE OF INDIANA, *LAKE* COUNTY, ss:
Before me, the undersigned, a Notary Public in and for said County, this _____
16th day of *April* 19 *90*, came _____
WALTER J. + PATRICIA M. McLaughlin

_____, and acknowledged the execution of the foregoing instrument.



Witness my hand and official seal.
My Commission expires *5/23/91*
Doris J. Giedemann Hoffman Notary Public
DORIS J. GIEDEMANN HOFFMAN

This instrument prepared by: *WALT McLaughlin*

200