

093690

Pool/Commitment #: _____

Loan #: 204190

Prepared by: SYLVIA PERILLOUX

ASSIGNMENT OF MORTGAGE

For and in Consideration of the sum of One Dollar (\$1.00) and other good and valuable consideration to it in hand paid, COMMONWEALTH MORTGAGE COMPANY OF AMERICA, L.P., a Delaware Limited Partnership, does hereby, sell assign and transfer unto Fleet Mortgage Corp. 125 E. Wells Milwaukee, WI 53202

a certain indenture of mortgage and the note secured thereby, executed by LAWRENCE R. ROUGE AND JANE L. ROUGE, HUSBAND AND WIFE

To COMMONWEALTH MORTGAGE COMPANY OF AMERICA, L.P. on the 17TH day of NOVEMBER 19 89 upon the following described real estate located in LAKE County, and recorded as Document No. 072101 in Volume/Book _____ of Mortgages on page _____ in the office of Recorder of Deeds of LAKE County, State of INDIANA, on the 4TH day of DECEMBER 19 89

LOT 19, SHADY LAWN SUBDIVISION, AS PER PLAT THEREOF, RECORDED IN PLAT BOOK 32 PAGE 12, IN THE OFFICE OF THE RECORDER OF LAKE COUNTY, INDIANA.

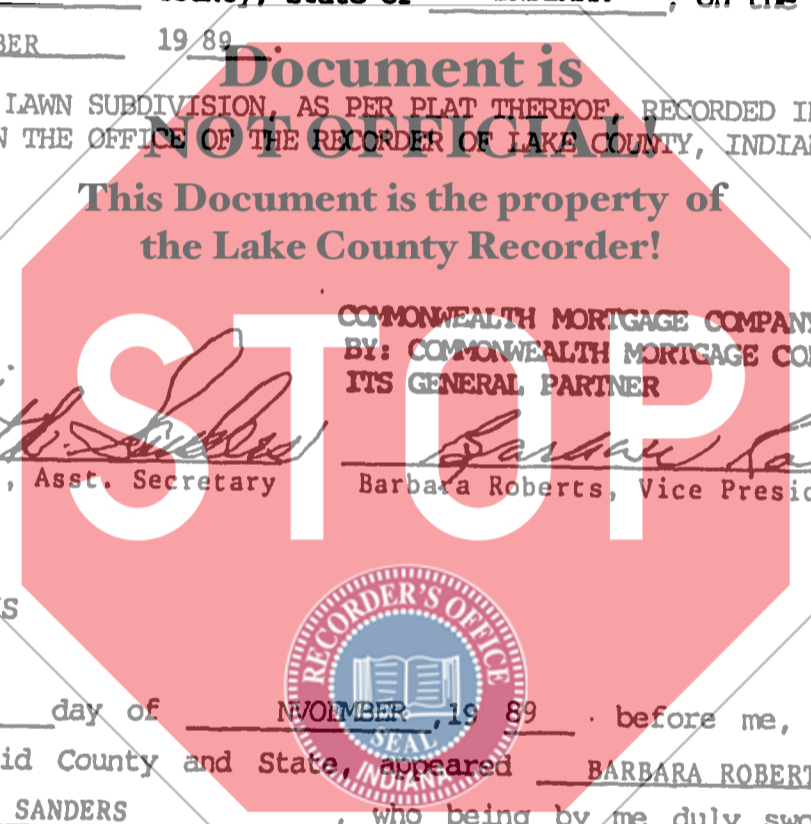

ATTEST:

Elizabeth Sanders
Elizabeth Sanders, Asst. Secretary

COMMONWEALTH MORTGAGE COMPANY OF AMERICA, L.P.
BY: COMMONWEALTH MORTGAGE CORPORATION OF AMERICA,
ITS GENERAL PARTNER
Barbara Roberts
Barbara Roberts, Vice President

STATE OF TEXAS
COUNTY OF HARRIS



STATE OF INDIANA/S.S. NO. _____
LAKE COUNTY
FILED _____
APR 5 10 02 AM '89
ROBERT ROUGE
RECORDER

On this 30TH day of NOVEMBER, 19 89 before me, a Notary Public in and for said County and State, appeared BARBARA ROBERTS and ELIZABETH SANDERS, who being by me duly sworn did say that they are the Vice President and Assistant Secretary, respectively of said COMMONWEALTH MORTGAGE CORPORATION OF AMERICA, a corporation; and that said instrument was signed and sealed on behalf of said corporation by authority of its Board of Directors; and the Vice President and Assistant Secretary as such BARBARA ROBERTS and ELIZABETH SANDERS being authorized so to do acknowledge the execution of said instrument to be the voluntary act and deed of said corporation.

WITNESS my official signature and notarial seal the date last above written.

Rebecca Luedicke
REBECCA LUEDECKE
Notary Public, State of Texas
My Commission Expires 1-6-90

Return to :

COMMONWEALTH MORTGAGE COMPANY OF AMERICA, L.P.
P.O. Box 1529
Houston, Texas 77251
ATTN: INVESTOR CERTIFICATION - MBC 7



5.00
ck
8