



Reception No.

A.D.

19

o'clock M.

Recorded this day of

Recorder

WARRANTY DEED

093408

THIS INDENTURE WITNESSETH

That GARRY J. SVETIC

of LAKE County, and State of INDIANA

CONVEY & WARRANT

To DONALD A. SHEAKS and DARAH J. SHEAKS, husband and wife,

of LAKE County, in the State of INDIANA

for the sum of One Dollar and other good and valuable consideration
AN UNDIVIDED ONE HALF INTEREST IN
the following described REAL ESTATE in LAKE County, in the
State of Indiana, to-wit:

The South 4.5 feet of Lot 6, all of Lots 7 and 8, (except the South 34.5 feet thereof), Oak Grove 2nd Addition, in the City of Hammond, as shown in Plat Book 20, page 44, in Lake County, Indiana. Also know as: 7323 Chestnut St., Hammond, IN.

STATE OF INDIANA/SIS. NO.
LAKE COUNTY
FILED FOR RECORD
APR 4 10 05 AM '90
ROBERT "BOB" FREELAND
RECORDER

SUBJECT TO:

- All Easements and Restrictions of record.
- Real Estate Taxes for 1989 payable 1990, and thereafter.
- A certain Mortgage, dated July 12, 1977 and recorded July 25, 1977, as document No. 419289, made by Richard C. Thomas, unmarried, to Great Lakes Mortgage Corporation, as Illinois Corporation, to secure one note for \$21,300.00, said Mortgage having been assigned to Federal National Mortgage Association by document No. 425916.

MAIL TAX BILLS TO:
Donald A. Sheaks
6743 Leland Avenue
Hammond, IN

Key No. 35-167-7

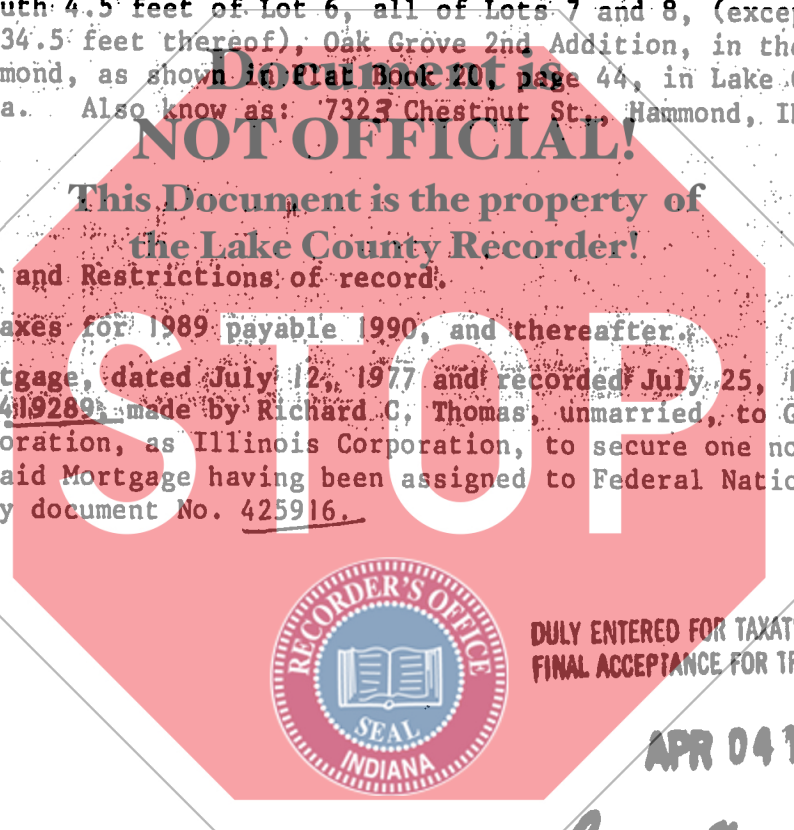

IN WITNESS WHEREOF, The said GARRY J. SVETIC

Has hereunto set his Hand and seal this 3rd day of April, 1990

(SEAL) (SEAL)
(SEAL) Garry J. Svetic (SEAL)
(SEAL) Garry J. Svetic (SEAL)

STATE OF INDIANA, Lake County, ss:

I, the undersigned, a Notary Public in and for said County and State, personally appeared the within named Garry J. Svetic

who acknowledged the execution of the foregoing Deed to be his voluntary act and deed.

IN WITNESS, my hand and Notary Seal this 3rd day of April, 1990

My commission expires September 29, 1993

William C. Gerlach Notary Public Resident Lake County

This instrument was prepared by: Darah J. Sheaks

000229

