



# TICOR TITLE INSURANCE

086429

Return To: Gray Real Estate

9105 E. 61st Ave. Merrillville, IN 46410

## WARRANTY

## This Indenture Witnesseth

That Betty J. Crane

of Cook County, and State of Illinois

### CONVEY AND WARRANT

To Jehu Smith and Maxie E. Smith, husband and wife

of Lake County, in the State of Indiana

for the sum of Ten dollars and other good and valuable consideration Dollars

the following described REAL ESTATE in Lake County, in the

State of Indiana, to-wit: Lot 5 in Block 6 in Indian Hills Addition to Gary, as per plat thereof, recorded in Plat Book 19 page 15, in the Office of the Recorder of Lake County, Indiana.

Subject to the following:

1. Taxes for 1988 payable in 1989 and thereafter
2. Building lines, easements, restrictions, and covenants already of record.

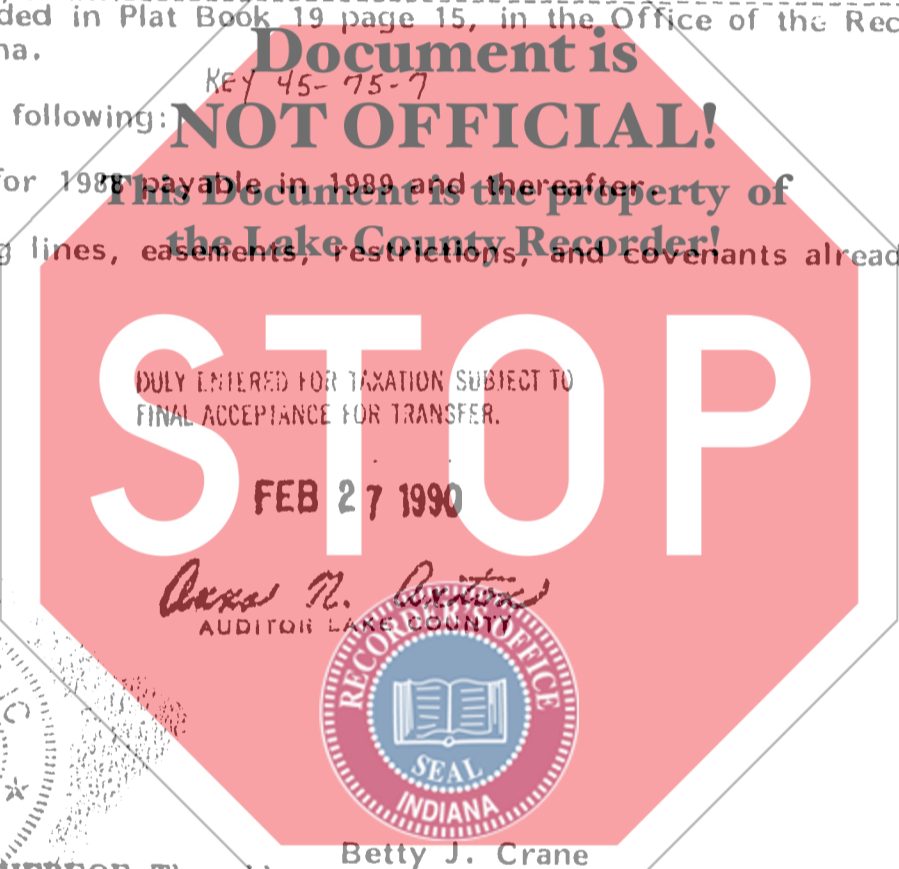

IN WITNESS WHEREOF, The said Betty J. Crane

Has hereunto set her Hand and seal this 24th day of Feb. 1990

Betty J. Crane (SEAL) (SEAL)  
BETTY J. CRANE (SEAL) (SEAL)  
 (SEAL) (SEAL)

STATE OF INDIANA, Lake County, ss:

Before me, the undersigned, a Notary Public in and for said County and State, personally appeared the within named Betty J. Crane

who acknowledged the execution of the foregoing Deed to be her voluntary act and deed.

WITNESS, my hand and Seal this 24th day of February 1990

My commission expires 11/10 1993 Robert M. Kostelnik Notary Public

County of Residence Porter

Mail Tax Statements to 816 Fayette St., Gary, Indiana, 46403

This instrument prepared by Betty J. Crane

001321

5.00  
ar