

(3) 147716 Katic

THIS FORM HAS BEEN APPROVED BY THE INDIANA STATE BAR ASSOCIATION FOR USE BY LAWYERS ONLY. THE SELECTION OF A FORM OF INSTRUMENT, FILLING IN BLANK SPACES, STRIKING OUT PROVISIONS AND INSERTION OF SPECIAL CLAUSES, CONSTITUTES THE PRACTICE OF LAW AND MAY ONLY BE DONE BY A LAWYER.

Mail tax bills to: 082979

Tax Key No.:

14745 Cline Ave
Cedar Lake IN 46303

WARRANTY DEED

FOR THE RECORD
HIGHLAND, INDIANA
PANICE

This indenture witnesseth that LAWRENCE G. PANICE, JR.

of Lake County in the State of Indiana

Convey^s and warrant^f to MARCO KATIC

of Lake County in the State of Indiana
for and in consideration of Ten (\$10.00) Dollars and other good and valuable consideration the receipt whereof is hereby acknowledged, the following Real Estate in Lake County in the State of Indiana, to wit:

STATE OF INDIANA/S. HENRY
LAKE COUNTY
FILED
FEB 5 8 51 AM '90
ROBERT W. WOODRUFF
RECORDER

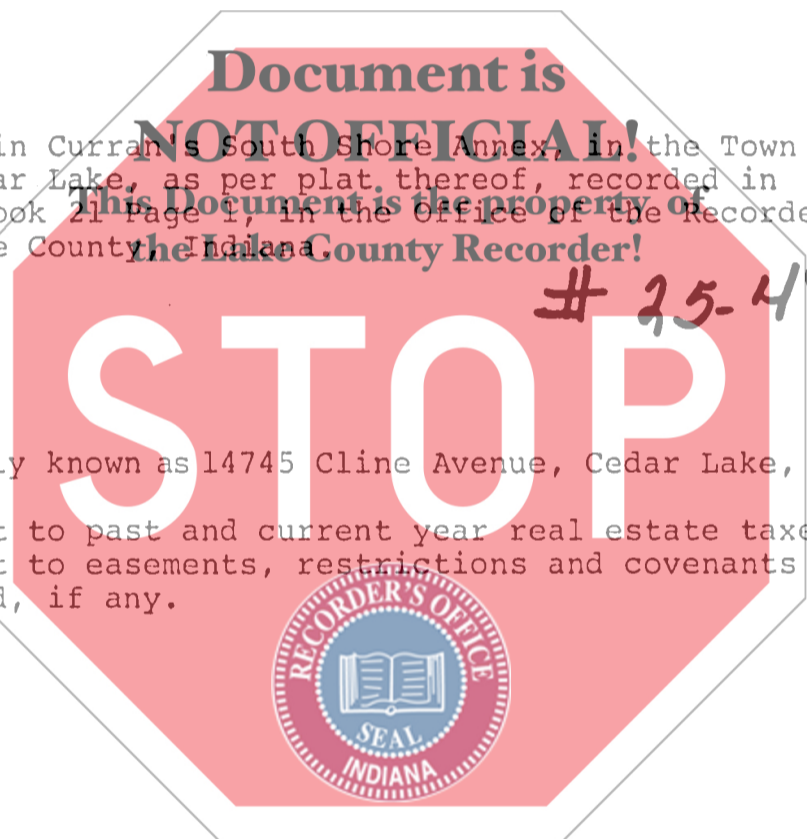

Lot 2 in Curran's South Shore Annex, in the Town of Cedar Lake, as per plat thereof, recorded in Plat Book 21 Page 1, in the Office of the Recorder of Lake County, Indiana.

Commonly known as 14745 Cline Avenue, Cedar Lake, Indiana.
Subject to past and current year real estate taxes.
Subject to easements, restrictions and covenants of record, if any.

State of Indiana, Lake County, ss:
Before me, the undersigned, a Notary Public in and for said County and State, this 26TH day of January 1990 personally appeared:

LAWRENCE G. PANICE, JR.

Dated this 26th Day of January 1990
Lawrence G. Panice, Jr.
LAWRENCE G. PANICE, JR.

DULY ENTERED FOR TAXATION SUBJECT TO FINAL ACCEPTANCE FOR TRANSFER.

JAN 31 1990

Charles M. Austin
AUDITOR LAKE COUNTY

and acknowledged the execution of the foregoing deed. In witness whereof, I have hereunto subscribed my name and affixed my official seal. My commission expires 12-3-93 19

Jean McMichael
Jean McMichael Notary Public

Resident of Lake County.

This instrument prepared by WANDA E. JONES, 622 Ridge Road, Munster, Indiana 46321 Attorney at Law

001711

5.00

MAIL TO: