

082672

ENVIRONMENTAL DISCLOSURE DOCUMENT FOR TRANSFER OF REAL PROPERTY

The following information is provided under IC 13-7-22, the Responsible Property Transfer Law.

For Use By County Recorder's Office
County
Date
Doc. No.
Vol.
Page
Rec'd by:

I. PROPERTY IDENTIFICATION

A. Address of property: 1835-1837 Cleveland Avenue, Whiting, Indiana
Street
City or Town
Township

B. Legal Description:
Permanent Real Estate Index No. _____
Section _____ Township _____ Range _____

Enter or attach complete legal description in this area:
Lots 14 and 15, Block 6, Central Park Addition to the City of Whiting, as shown in Plat Book 5, Page 1, in Lake County, Indiana.

Transferees and transferees of real property are advised that their ownership or other control of such property may render them liable for environmental cleanup costs whether or not they caused or contributed to the presence of environmental problems in association with the property.

C. Property Characteristics:

Lot Size 60' x 141' Acreage _____
Check all types of improvement and uses that pertain to the property:
 Apartment building (6 units or less)
 Commercial apartment (over 6 units)
 Store, office, commercial building
 Industrial building
 Farm, with buildings
 Other (specify) _____

II. NATURE OF TRANSFER

A. (1) Is this a transfer by deed or other instrument of conveyance? Yes No _____
(2) Is this a transfer by assignment of over 25% of beneficial interest of a land trust? _____
(3) A lease exceeding a term of 40 years? _____
(4) A mortgage or collateral assignment of beneficial interest? _____
(5) A contract for the sale of property? _____

B. (1) Identify Transferor:
Michael Catchur
Name and Current Address of Transferor
1234 DAVIS AVENUE
Whiting, Indiana 46394

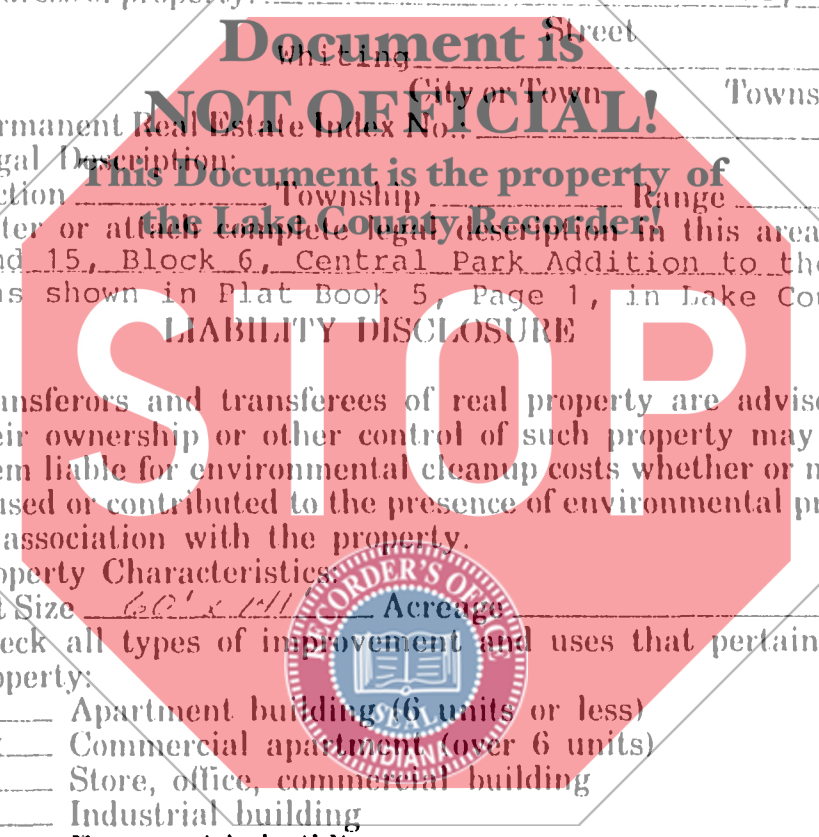

CHICAGO TITLE INSURANCE COMPANY
INDIANA DIVISION

STATE OF INDIANA, S. NO. _____
LAKE COUNTY
RECORDER'S OFFICE

FEB 2 1 05 PM '90
ROBERT W. JOHNSON
RECORDER

10.00
R

TRAX Box

Name and Address of Trustee if this is a transfer of beneficial interest of a land trust.
Not Applicable.

(2) Identify person who has completed this form on behalf of the Transferor and who has knowledge of the information contained in this form:

Michael Catchur
Name, Position (if any), Telephone No.
and address

C. Identify Transferee:
Mibar Estates, an Indiana General Partnership
Name and Current Address of Transferee

III. ENVIRONMENTAL INFORMATION

A. Regulatory Information During Current Ownership

1. Has the transferor ever conducted operations on the property which involved the generation, manufacture, processing, transportation, treatment, storage, or handling of "hazardous waste", as defined by IC 13-7-12? This question does not apply to consumer goods stored or handled by a retailer in the same form and approximate amount, concentration, and manner as they are sold to consumers, unless the retailer has engaged in any commercial mixing (other than printing, marking, or labeling of consumer sized containers), finishing, refinishing, servicing, or cleaning operations on the property.

Yes _____

No

2. Has the transferor ever conducted operations on the property which involved the processing, storage, or handling of petroleum, other than that which was associated directly with the transferor's vehicle usage?

Yes _____

No

3. Has the transferor ever conducted operations on the property which involved the generation, transportation, storage, treatment, or disposal of "hazardous waste", as defined in IC 13-7-1?

Yes _____

No

4. Are there any of the following specific units (operating or closed) at the property that are used or were used by the transferor to manage hazardous wastes, hazardous substances, or petroleum?

	Yes	No
Landfill	_____	<input checked="" type="checkbox"/>
Surface Impoundment	_____	<input checked="" type="checkbox"/>
Land Treatment	_____	<input checked="" type="checkbox"/>
Waste Pile	_____	<input checked="" type="checkbox"/>
Incinerator	_____	<input checked="" type="checkbox"/>
Storage Tank (Above Ground)	_____	<input checked="" type="checkbox"/>
Storage Tank (Underground)	_____	<input checked="" type="checkbox"/>
Container Storage Area	_____	<input checked="" type="checkbox"/>
Injection Wells	_____	<input checked="" type="checkbox"/>
Wastewater Treatment Units	_____	<input checked="" type="checkbox"/>
Septic Tanks	_____	<input checked="" type="checkbox"/>
Transfer Stations	_____	<input checked="" type="checkbox"/>
Waste Recycling Operations	_____	<input checked="" type="checkbox"/>
Waste Treatment/ Detoxification	_____	<input checked="" type="checkbox"/>
Other Land Disposal Area	_____	<input checked="" type="checkbox"/>

If there are "YES" answers to any of the above items and the transfer of property that requires the filing of this document is other than a mortgage or collateral assignment of beneficial interest, you must attach to the copies of this document that you file with the county recorder and the department of environmental management a site plan that identifies the location of each unit.

5. Has the transferor ever held any of the following in regard to this real property?

(A) Permits for discharges of wastewater to waters of Indiana. Yes _____
No X_____

(B) Permits for emissions to the atmosphere. Yes _____
No X_____

(C) Permits for any waste storage, waste treatment, or waste disposal operation. Yes _____
No X_____

6. Has the transferor ever discharged any wastewater (other than sewage) to a publicly owned treatment works?

Yes _____
No X_____

7. Has the transferor been required to take any of the following actions relative to this property?

(A) Filed an emergency and hazardous chemical inventory form pursuant to the federal Emergency Planning and Community Right-to-Know Act of 1986 (42 U.S.C. 11022). Yes _____
No X_____

(B) Filed a toxic chemical release form pursuant to the federal Emergency Planning and Community Right-to-Know Act of 1986 (42 U.S.C. 11023). Yes _____
No X_____

8. Has the transferor or any facility on the property or the property been the subject of any of the following state or federal governmental actions?

(A) Written notifications regarding known, suspected, or alleged contamination on or emanating from the property. Yes _____
No X_____

(B) Filing an environmental enforcement case with a court or the solid waste management board for which a final order or consent decree was entered. Yes _____
No X_____

(C) If the answer to question (B) was Yes, then indicate whether or not the final order or decree is still in effect for this property. Yes _____
No _____
Not Applicable

9. Environmental Releases During Transferor's Ownership.

(A) Has any situation occurred at this site which resulted in a reportable "release" of any hazardous substances or petroleum as required under state or federal laws?

Yes _____
No X_____

(B) Have any hazardous substances or petroleum which were released come into direct contact with the ground at this site?

Yes _____
No X_____

If the answers to questions (A) and (B) are Yes, have any of the following actions or events been associated with a release on the property?

- N/A Use of a cleanup contractor to remove or treat materials including soils, pavement, or other surficial materials?
- N/A Assignment of in-house maintenance staff to remove or treat materials including soils, pavement, or other surficial materials?
- N/A Sampling and analysis of soils?
- N/A Temporary or more long term monitoring of groundwater at or near the site?
- N/A Impaired usage of an on-site or nearby water well because of offensive characteristics of the water?
- N/A Coping with fumes from subsurface storm drains or inside basements?
- N/A Signs of substances leaching out of the ground along the base of slopes or at other low points on or immediately adjacent to the site?

10. Is the facility currently operating under a variance granted by the commissioner of the Indiana department of environmental management?

Yes

No

11. Is there any explanation needed for clarification of any of the above answers?

Not Applicable.

B. Site Information Under Other Ownership or Operation

1. Provide the following information about the previous owner or about any entity or person to whom the transferor leased the property or with whom the transferor contracted for the management of the property:

Name: Thomas Owens

Type of Business: Apartment rentals for residential or property usage purposes.

2. If the transferor has knowledge, indicate whether the following existed under prior ownerships, leaseholds granted by the transferor, or other contracts for management or use of the property:

	Yes	No
Landfill	_____	X
Surface Impoundment	_____	X
Land Treatment	_____	X
Waste Pile	_____	X
Incinerator	_____	X
Storage Tank (Above Ground)	_____	X
Storage Tank (Underground)	_____	X
Container Storage Area	_____	X
Injection Wells	_____	X
Wastewater Treatment Units	_____	X
Septic Tanks	_____	X
Transfer Stations	_____	X
Waste Recycling Operations	_____	X

Waste Treatment Detoxification
Other Land Disposal Area

Yes No

 X

 X

IV. CERTIFICATION

A. Based on my inquiry of those persons directly responsible for gathering the information, I certify that the information submitted is, to the best of my knowledge and belief, true and accurate.

Michael Catchur
TRANSFEROR (or on behalf of Transferor) Michael Catchur

B. This form was delivered to me with all elements completed on
January 26, 19 90

Michael J. Swentko, Barbara K. Chess
TRANSFeree (or on behalf of Transferee)

(P.L.166-1989, § 1.) Mibar Estates, an Indiana General Partnership

State of Indiana, Lake County ss:
Before me, the undersigned, a notary public in and for said county and state, personally appeared Michael Catchur, Transferor and Michael J. Swentko and Barbara K. Chess as representatives of Mibar Estates, an Indiana General Partnership, and acknowledged the foregoing instrument. Dated this January 26, 1990.

Christine S. Dudley

Christine S. Dudley, NOTARY PUBLIC
Resident of Lake County, Indiana

My Commission Expires:
November 27, 1993

Prepared by: Michael Catchur

