

Richard A Miller
521 E. 86th Ave Suite E
Ann 46110

Project: ITR-15-80(01)

QUITCLAIM DEED

861652

8

THIS INDENTURE WITNESSETH that the State of Indiana hereby quitclaims to
City of Gary, Indiana

for \$ One Dollar (\$1.00) and
other valuable consideration the receipt of which is hereby acknowledged, the
following described real estate in Lake County, State of Indiana, to wit:

Part of Parcel 4C

A part of the Northwest Quarter of Section 3, Township 36 North, Range 8 West
of the Second Principal Meridian, in the City of Gary, Lake County, Indiana,
described as follows:

Commencing at the northwest corner of said quarter section; thence South 00
degrees 55 minutes 21 seconds East (quoted from Chicago Title Insurance
Company's Commitment No. 394171) 1,323.06 feet (1,323.12 feet by Chicago Title
Insurance Company's Commitment No. 394171) along the west line of said quarter
section; thence Southeasterly 91.34 feet along an arc to the left and having a
radius of 11,737.70 feet and subtended by a long chord having a bearing of
South 79 degrees 51 minutes 54 seconds East (South 79 degrees 53 minutes 00
seconds East deduced from Chicago Title Insurance Company's Commitment No.
394171) and a length of 91.34 feet to the point of beginning of the
description, which point is on the east boundary of Broadway; thence
Southeasterly 10.70 feet along an arc to the left and having a radius of
11,737.70 feet and subtended by a long chord having a bearing of South 80
degrees 06 minutes 50 seconds East and a length of 10.70 feet; thence South 00
degrees 21 minutes 47 seconds East 74.33 feet; thence North 81 degrees 14
minutes 14 seconds West 10.72 feet to the east boundary of Broadway; thence
North 00 degrees 19 minutes 25 seconds West (North 00 degrees 19 minutes 18
seconds West deduced from Chicago Title Insurance Company's Commitment No.
394189) 74.54 feet along said east boundary to the point of beginning and
containing 0.018 acres, more or less.

STATE OF INDIANA
LAKE COUNTY
FILED FOR RECORD
JUL 1 1986
9 42 AM '86
CLAY
RECORDED

NON TAXABLE

Parcel 5C

JUL 1 1986

Also, a part of the Northeast Quarter of Section 4, Township 36 North,
West, of the Second Principal Meridian, in the City of Gary, Lake County,
Indiana, described as follows:

Richard A Miller
AUDITOR LAKE COUNTY

Commencing at the northeast corner of said quarter section; thence South 00
degrees 55 minutes 21 seconds East (quoted from Chicago Title Insurance
Company's Commitment No. 394189) 1,209.05 feet (1,209.20 feet by Chicago Title
Insurance Company's Commitment No. 394189) along the east line of said quarter
section to the centerline of the Indiana East-West Toll Road (a Centerline

Survey Map of which is recorded in Special Plat Book 30-1/2, pages 1 to 22, in the Office of the Recorder of Lake County, Indiana); thence North 79 degrees 52 minutes 03 seconds West (quoted from Chicago Title Insurance Company's Commitment No. 394189) 9.14 feet (9.32 feet by Chicago Title Insurance Company's Commitment No. 394189) along said toll road centerline to the west boundary of Broadway; thence South 00 degrees 19 minutes 25 seconds East (South 00 degrees 19 minutes 18 seconds East deduced from Chicago Title Insurance Company's Commitment No. 394189) 117.42 feet along said west boundary to the point of beginning of this description; thence continuing South 00 degrees 19 minutes 25 seconds East (South 00 degrees 19 minutes 18 seconds East deduced from Chicago Title Insurance Company's Commitment No. 394189) 27.91 feet along said west boundary to the north boundary of Third Avenue; thence South 89 degrees 40 minutes 13 seconds West 2.74 feet along said north boundary; thence North 00 degrees 21 minutes 47 seconds West 28.44 feet; thence South 79 degrees 21 minutes 47 seconds East 2.81 feet to the point of beginning and containing 0.002 acres, more or less.

Part of Parcel 8

Also, a part of Lot 21 in Block 119 in Gary Land Company's First Subdivision in the City of Gary, Indiana, the plat of which is recorded in Plat Book 6, page 15, in the Office of the Recorder of Lake County, Indiana, described as follows:

Beginning at the northwest corner of said Lot 21; thence North 89 degrees 38 minutes 49 seconds East 48.93 feet along the north boundary of said Lot; thence Southeasterly 77.29 feet along an arc to the right and having a radius of 2,137.76 feet and subtended by a long chord having a bearing of South 80 degrees 08 minutes 52 seconds East and a length of 77.29 feet to the east boundary of said Lot; thence South 00 degrees 19 minutes 00 seconds East 16.31 feet along said east boundary to the southeast corner of said Lot; thence South 89 degrees 38 minutes 49 seconds West 125.00 feet along the south boundary of said Lot to the southwest corner of said Lot; thence North 00 degrees 19 minutes 00 seconds West 30.00 feet along the west boundary of said Lot to the point of beginning and containing 3,247 square feet (0.075 acres), more or less.

Part of Parcel 13

Also, a part of Lot 25 in Block 109 in Gary Land Company's First Subdivision in the City of Gary, Indiana, the plat of which is recorded in Plat Book 6, Page 15, in the Office of the Recorder of Lake County, Indiana, described as follows:

Beginning on the west line of said Lot at a point South 00 degrees 19 minutes 17 seconds East 7.77 feet from the northwest corner of said Lot; thence North 25 degrees 54 minutes 29 seconds East 3.94 feet; thence Southeasterly 125.29 feet along an arc to the right and having a radius of 1,059.32 feet and

subtended by a long chord having a bearing of South 80 degrees 10 minutes 51. seconds East and a length of 125.21 feet to the east line of said Lot; thence South 00 degrees 19 minutes 17 seconds East 3.71 feet along said east line to the southeast corner of said Lot; thence South 89 degrees 40 minutes 43 seconds West 125.00 feet along the south line of said Lot to the southwest corner of said Lot; thence North 00 degrees 19 minutes 17 seconds West 22.23 feet along the west line of said Lot to the point of beginning and containing 2,012 square feet (0.046 acres), more or less.

Parcel 6 & Parcel 9

Also, Lot 20 and Lot 22 in Block 119 in Gary Land Company's First Subdivision in the City of Gary, Indiana, the plat of which is recorded in Plat Book 6, page 15, in the Office of the Recorder of Lake County, Indiana. Containing 7,500 square feet (0.172 acres), more or less.

Parcel 11

Also, Lot 13, Block 2, Gary Land Company's Seventh Subdivision, in the City of Gary, as shown in Plat Book 11, page 2, in Lake County, Indiana. Containing 3,670 square feet (0.084 acres), more or less and containing in all 0.397 acres, more or less, said real estate being shown of Exhibit "A" attached hereto and made a part hereof.

All bearings in the above descriptions which are not quoted from previous instruments are based on the bearing system for Indiana Toll Road Project ITR-15-80(01).

SUBJECT to all easements and restrictions of record and to all public rights of way, if any, on the above described real estate.

ALSO, SUBJECT to an easement in and over the above-described 0.018-acre parcel for maintenance of an abutment and abutment footing, which easement was conveyed by the State of Indiana to the Chicago South Shore and South Bend Railroad in a certain Quitclaim Deed recorded in the Office of the Recorder of Lake County, Indiana.

ALSO, SUBJECT to an easement in and over the south 10.00 feet of the above-described 0.018-acre parcel for electric lines together with the right of ingress and egress, which easement was conveyed by the State of Indiana to the Northern Indiana Public Service Company in a certain Quitclaim Deed recorded in the Office of the Recorder of Lake County, Indiana.

ALSO, SUBJECT to an easement in and over the above-described 0.002-acre parcel for maintenance of an abutment and abutment footing as originally reserved by and to the grantor in a certain Deed executed by Chicago South Shore and South Bend Railroad to the State of Indiana and recorded in the Office of the Recorder of Lake County, Indiana.

ALSO, SUBJECT to an easement in and over a portion of the above-described 3,247-square foot parcel for maintenance of a retaining wall and retaining wall footing, which easement was conveyed by the State of Indiana to the Chicago South Shore and South Bend Railroad in a certain Cuitclaim Deed recorded in the Office of the Recorder of Lake County, Indiana, which portion is more particularly described as follows, to wit:

A part of Lot 21 in Block 119 in Gary Land Company's First Subdivision in the City of Gary, Indiana, the plat of which is recorded in Plat Book 6, page 15, in the Office of the Recorder of Lake County, Indiana, described as follows:

Beginning at the northwest corner of said Lot 21; thence North 89 degrees 38 minutes 49 seconds East 48.93 feet along the north boundary of said Lot; thence Southeasterly 77.29 feet along an arc to the right and having a radius of 2,137.76 feet and subtended by a long chord having a bearing of South 80 degrees 08 minutes 52 seconds East and a length of 77.29 feet to the east boundary of said Lot; thence South 00 degrees 19 minutes 00 seconds East 10.30 feet along said east boundary; thence Northwesterly 126.78 feet along an arc to the left and having a radius of 2,127.66 feet and subtended by a long chord having a bearing of North 80 degrees 45 minutes 54 seconds West and a length of 126.76 feet to the west boundary of said Lot; thence North 00 degrees 19 minutes 00 seconds West 2.88 feet along said west boundary to the point of beginning and containing 1,097 square feet, more or less.

All bearings in this description are based on the bearing system for Indiana Toll Road Project ITR-15-80(01).

WHEREAS, the fee simple title to the real estate herein above described was acquired by the State of Indiana through the Indiana Department of Highways - Toll Road Division in the acquisition of real estate for the Indiana East-West Toll Road, and properly recorded in the Office of the Recorder of Lake County, State of Indiana; and

IN WITNESS THEREOF, the State of Indiana has hereunto set its hand by the Governor of the State of Indiana, attested to by the Auditor of the State of Indiana.

STATE OF INDIANA



Robert D. Orr, Governor
State of Indiana

6/11/86

Date

Otis E. Cox

Otis E. Cox, Auditor
State of Indiana

APPROVED AS TO FORM AND LEGALITY BY:

J. Gordon Gibbs JUN 9 1986
Vinley E. Pearson, Attorney General
J. Gordon Gibbs, Chief Counsel - Departments

THIS INSTRUMENT PREPARED BY:

Mary Hall Mueller
Mary Hall Mueller, General Counsel
Indiana Department of Highways
Toll Road Division

STATE OF INDIANA)
) SS:
COUNTY OF)

BEFORE ME, the undersigned, a Notary Public in and for said County, personally appeared this 12th day of June, 1986, Robert D. Orr, Governor of the State of Indiana, he being thereunto duly authorized, and acknowledged the execution of the foregoing Quitclaim Deed for and on behalf of the State of Indiana.

WITNESS my hand and seal.

Jacquelyn S. Hendricks
Notary Public

My Commission Expires: 7/10/89
County of Residence: Marion

STATE OF INDIANA)
) SS:
COUNTY OF)

BEFORE ME, the undersigned, a Notary Public in and for said County, personally appeared this 16th day of JUNE, 1986, Otis E. Cox, Auditor of State, he being thereunto duly authorized, and acknowledged the execution of the foregoing Quitclaim Deed for and on behalf of the State of

WITNESS my hand and seal.

Theresa McRoney
Notary Public

My Commission Expires: 1-19-87
County of Residence: Marion

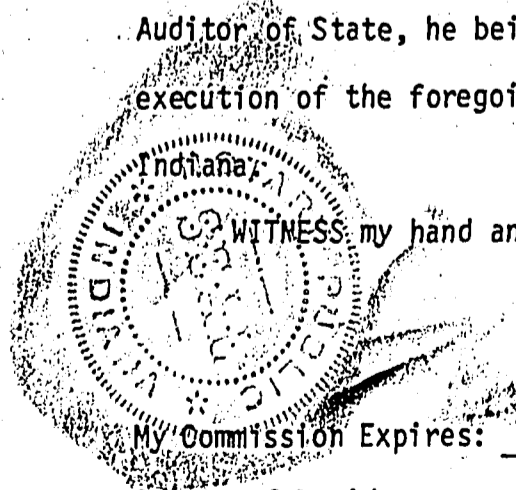

PARCEL NO.

PROJECT NO. ITR-15-80(01)

ROAD NO. INDIANA TOLL ROAD

COUNTY: LAKE

SECTION: 3 & 4

TOWNSHIP: 36 N

RANGE: 8 W

OWNER: STATE OF INDIANA

DRAWN BY: D. PATTERSON 7/7/83

CHECKED BY: R. THOMPSON 7/7/83

INSTRUMENT NO.

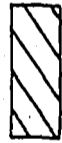

AREA TO BE CONVEYED TO THE CITY OF GARY



PARCEL NUMBER

SCALE: 1" = 50'

SEC. 4, T-36-N, R-8-W

TOLL

PROV. R/W 7

C.S.S. & S.B. RAILROAD

3rd AVE.

ALLEY

SECTION LINE

BROADWAY AVE.

SEC. 3, T-36-N, R-8-W

ROAD EXIST. R/W 7

C R/W & A.C.L.

CITY OF GARY

C R/W

C TEMP. R/W

EXHIBIT "A"

SHEET 1 OF 3

PARCEL NO.

PROJECT NO. ITR-15-80(01)

ROAD NO. INDIANA TOLL ROAD

COUNTY: LAKE

SECTION: 4

TOWNSHIP: 36 N

RANGE: 8 W

OWNER: STATE OF INDIANA

DRAWN BY: D. PATTERSON 7/7/83

CHECKED BY: R. THOMPSON 7/7/83

INSTRUMENT NO.

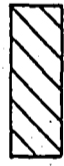

AREA TO BE CONVEYED TO THE CITY OF GARY



PARCEL NUMBER

SCALE: 1" = 100'

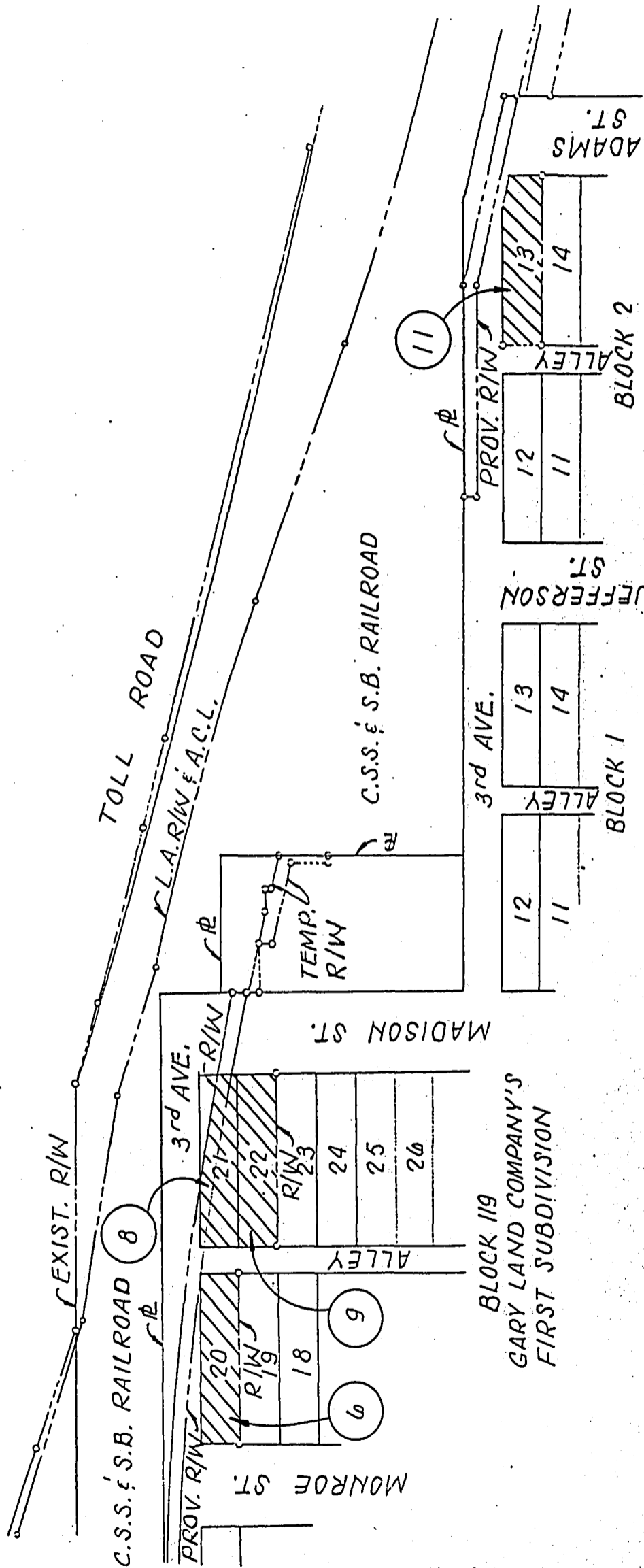
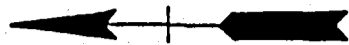



EXHIBIT "A"

DRAWN BY: D. PATTERSON 7/7/83
CHECKED BY: R. THOMPSON 7/7/83

OWNER: STATE OF INDIANA

INSTRUMENT NO.  AREA TO BE CONVEYED TO THE CITY OF GARY

 PARCEL NUMBER

SCALE: 1" = 50'

PARCEL NO.

PROJECT NO. ITR-15-80(01)

ROAD NO. INDIANA TOLL ROAD

COUNTY: LAKE

SECTION: 3

TOWNSHIP: 36 N

RANGE: 8 W

 TEMP. R/W

 TOLL ROAD

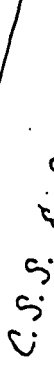
 C.S.S. & S.B. R.R.

4TH AVE. 

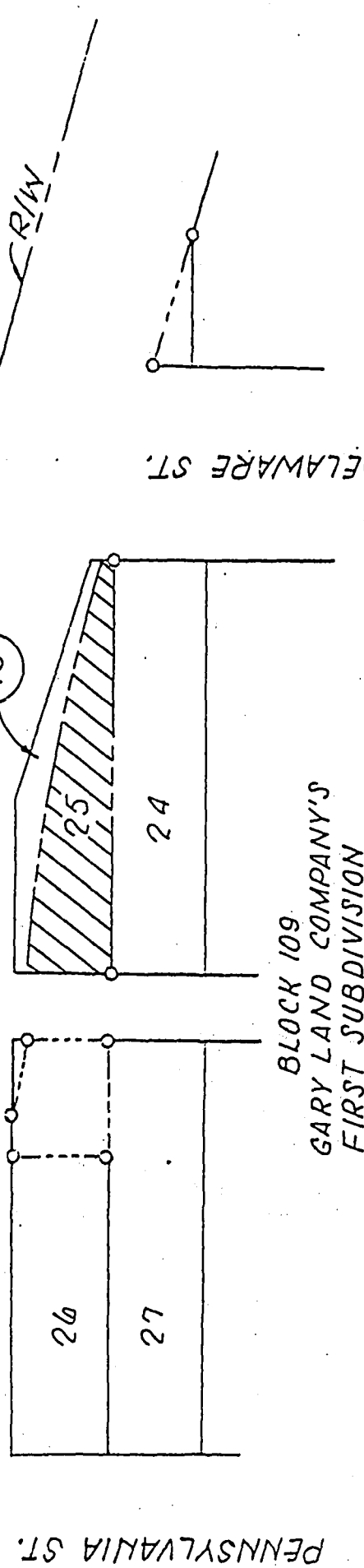

BLOCK 109
GARY LAND COMPANY'S
FIRST SUBDIVISION

EXHIBIT "A"

SHEET 3 OF 3