

R55683

#5-80050.00-00 50  
State of Indiana  
Toll Road Division  
52551 Oak Road, Manger, Ind 46530  
Attn: Mary Mueller

810258

QUITCLAIM DEED

This Indenture Witnesseth that the State of Indiana hereby quitclaims to the Northern Indiana Public Service Company for One Dollar and other valuable consideration, the following described real estate in Lake County, State of Indiana, to-wit:

Parcels designated by the Indiana Toll Road Commission as 3-AS-1(XL), 3-AT-1(XL), 3-1(XL), 3-CR(XL), 3-DQ-1(XL), 3-DQ-4(XL), DV-1(XL), 3-FP-1(XL), 3-GU-1(XL), 3-JQ-1 and 3-KR-1(XL), Combined, (Subject to 3-LR-1 and 3-LR-2P), more particularly described:

Part of blocks 2, 3 and 4; parts of vacated Catalpa and Magnolia Avenues; parts of vacated Alleys (No. 9) and (No. 10); and part of the south half of vacated Alley (B); all in Stafford and Trankle's North Central Calumet Addition to the City of Hammond, Lake County, Indiana (the plat of said addition appearing of record in Plat Book 21, page 23, in the office of the Recorder of Lake County, Indiana), all being bounded and described as follows:

Beginning on the south line of lot 14 in block 4 at a point which is 107.21 feet westerly, measured on said south line (and said south line prolonged), from the centerline of vacated Chestnut Avenue (which centerline is the east line of the north half of the Southwest Quarter of the Southeast Quarter of Section 30, Township 37 North, Range 9 West, 2nd P.M.); thence Northwesterly (on the southwestern line of a tract of land conveyed to the Northern Indiana Public Service Company by virtue of a deed recorded in Deed Record 402, page 337, in said Recorder's office) 773.2 feet to the north line of the Southwest Quarter of the Southeast Quarter of said Section 30, said north line being the centerline of vacated Alley (B); thence Westerly on the north line of said quarter-quarter section (and on the centerline of said vacated alley) to the northeastern line of Marginal Street "C" at a point which is 15.15 feet easterly, measured on the centerline of vacated Alley (B), from the centerline of vacated Alley (No. 7); thence Southeasterly on a curve to the right having a radius of 3391.24 feet (the tangent to said curve at the last corner making an angle of 38 degrees 16 minutes 44 seconds, measured east to south, with the centerline of said vacated Alley (B) a distance of 16.10 feet to the north line of lot 26 in said block 2 at a point which is 17.96 feet easterly, measured on said north line, from the northwest corner of said lot 26; thence continuing Southeasterly on a curve to the right having a radius of 3391.24 feet a distance of 53.50 feet to a point of tangent which is 194.00 feet southwesterly, measured at right angles, from the centerline of the Indiana East-West Toll Road (a Centerline Survey Map of which is on file in the office of the Recorder of Lake County, Indiana); thence

STATE OF INDIANA  
LAKE COUNTY  
FILED FOR RECORD  
INDIANA DIVISION

JUL 8 10 15 AM '85

RUDOLPH P. PISAY  
RECORDER

CHICAGO TITLE INSURANCE COMPANY  
INDIANA DIVISION

Split from  
KEY 36-135-17  
to KEY 36-135-16

Split from  
KEY 36-136-4, 9, 23, 38  
to KEY 36-136-1

Split from  
KEY 36-137-42  
to KEY 36-137-44

KEY 36-136-39  
KEY 36-137-41+44

DULY ENTERED  
FOR TAXATION

JUN 28 1985

*Spencer O. Pruitt*  
AUDITOR LAKE COUNTY

123704  
12.50

Southeasterly parallel with said toll road centerline 79.58 feet to the west line of vacated Magnolia Avenue at a point which is 84.27 feet southerly, measured on said west line, from the northeast corner of lot 26 in said block 2; thence continuing Southeasterly parallel with said toll road centerline 76.36 feet to the east line of said vacated Magnolia Avenue at a point which is 132.83 feet southerly, measured on said east line, from the northwest corner of lot 1 in said block 3; thence continuing Southeasterly parallel with said toll road centerline 156.09 feet to the west line of vacated Alley (No. 9) at a point which is 232.06 feet southerly, measured on said west line, from the northeast corner of said lot in said block 3; thence continuing Southeasterly parallel with said toll road centerline 25.44 feet to the east line of said vacated Alley (No. 9) at a point which is 248.20 feet southerly, measured on said east line, from the northwest corner of lot 26 in said block 3; thence continuing Southeasterly parallel with said toll road centerline 155.90 feet to the west line of vacated Catalpa Avenue at a point which is 133.63 feet northerly, measured on said west line, from the southeast corner of lot 14 in said block 3; thence continuing Southeasterly parallel with said toll road centerline 76.29 feet to the east line of said vacated Catalpa Avenue at a point which is 85.04 feet northerly, measured on said east line, from the southwest corner of lot 13 in said block 4; thence continuing Southeasterly parallel with said toll road centerline 133.53 feet to the south line of said lot 13 in said block 4 at a point which is 18.45 feet westerly, measured on said south line, from the southeast corner of said lot 13; thence Easterly on the south line of said block 4 a distance of 84.75 feet, more or less, to the point of beginning, EXCEPTING the part thereof designated by Indiana Toll Road Commission as Parcel 3-JR and more particularly described as follows:

Lot 14 in block 4 in Stafford and Trankle's North Central Calumet Addition to the City of Hammond, Lake County, Indiana (the plat of said addition appearing of record in Plat Book 21, page 23, in the office of the Recorder of Lake County, Indiana), including herein all rights in any adjacent alleys whether vacated or not vacated; EXCEPTING the part of said lot which was conveyed to Northern Indiana Public Service Company by virtue of a deed recorded in Deed Record 402, page 337, in the office of the Recorder of Lake County, Indiana.

The above described real estate is shown on Exhibit A which is attached hereto and made a part hereof.

Subject to a grant by virtue of a Perpetual Easement dated 23rd day of June, 1980, and recorded as document no. 636090, in the Office of the Recorder of Lake County, Indiana, wherein the Indiana Toll Road

Commission granted and conveyed to the State of Indiana an easement for drainage purposes over a portion of said real estate, bounded and described as follows:

Parcel designated by the Indiana Toll Road Commission as 3-LR-1P, described as:

A strip of land 15.00 feet wide across a part of lots 4 and 5 in said block 3 in Stafford and Trankle's North Central Calumet Addition to the City of Hammond, Lake County, Indiana (the plat of said addition appearing of record in Plat Book 21, page 23, in the office of the Recorder of Lake County, Indiana), said strip of land being 7.50 feet wide on each side of the following described centerline:

Beginning on the southwestern line of a tract of land conveyed to the Northern Indiana Public Service Company by virtue of a deed recorded in Deed Record 402, page 337, in said Recorder's Office, at a point which is 140 feet, more or less, Southwesterly, measured at right angles, from the centerline of the Indiana East-West Toll Road (a Centerline Survey Map of which is on file in the office of the Recorder of Lake County, Indiana) at Station 497+90; thence Southwesterly (on a line drawn at right angles from said toll road centerline) about 54 feet to a point which is 194.00 feet southwesterly, measured at right angles, from said toll road centerline, which point is terminus of the centerline of said 15-foot wide strip of land. The side lines of said strip of land are presumed to be prolonged or shortened to terminate in the boundaries of the tract conveyed herein.

Also, subject to a grant by virtue of a Perpetual Easement dated May 12, 1961, and recorded December 4, 1961, in Deed Record 1171, page 95, in the Office of the Recorder of Lake County, Indiana, wherein the Indiana Toll Road Commission granted and conveyed to the State of Indiana an easement for drainage purposes over a portion of said real estate, bounded and described as follows:

Parcel designated by the Indiana Toll Road Commission as 3-LR-2P, described as:

A strip of land 15.00 feet wide across a part of vacated Catalpa Avenue in Stafford and Trankle's North Central Calumet Addition to the City of Hammond, Lake County, Indiana (the plat of said addition appearing of

record in Plat Book 21, page 23, in the office of the Recorder of Lake County, Indiana), said strip of land being 7.50 feet wide on each side of the following described centerline:

Beginning on the Southwestern line of a tract of land conveyed to the Northern Indiana Public Service Company by virtue of a deed recorded in Deed Record 402, page 337, in said Recorder's office, at a point which is 140 feet, more or less, Southwesterly, measured at right angles, from the centerline of the Indiana East-West Toll Road (a Centerline Survey Map of which is on file in the office of the Recorder of Lake County, Indiana) at Station 501+00; thence Southwesterly (on a line drawn at right angles from said toll road centerline) about 54 feet to a point which is 194.00 feet southwesterly, measured at right angles, from said toll road centerline, which point is the terminus of the centerline of said 15-foot wide strip of land. The side lines of said strip of land are presumed to be prolonged or shortened to terminate in the boundaries of the tract herein conveyed.

Subject to all easements and restrictions of record and to all roads, highways, streets, alleys, railroad rights-of-way, switch and spur tracks, easements for existing pipelines, gas mains, sewers, water mains, ditches and drains, if any.

WHEREAS, the fee simple title to the real estate herein above described was acquired by the State of Indiana through the Indiana Toll Road Commission in the original acquisition of real estate for the Indiana East-West Toll Road, and properly recorded in the Office of the Recorder of Lake County, Indiana.

IN WITNESS WHEREOF, the State of Indiana has hereunto set its hand by the Governor of the State of Indiana, attested to by the Auditor of the State of Indiana.

STATE OF INDIANA



Robert D. Orr, Governor

6/3/85

DATE



EXHIBIT A

AREA TO BE UNIFIED  
INDICATED IN GREEN.

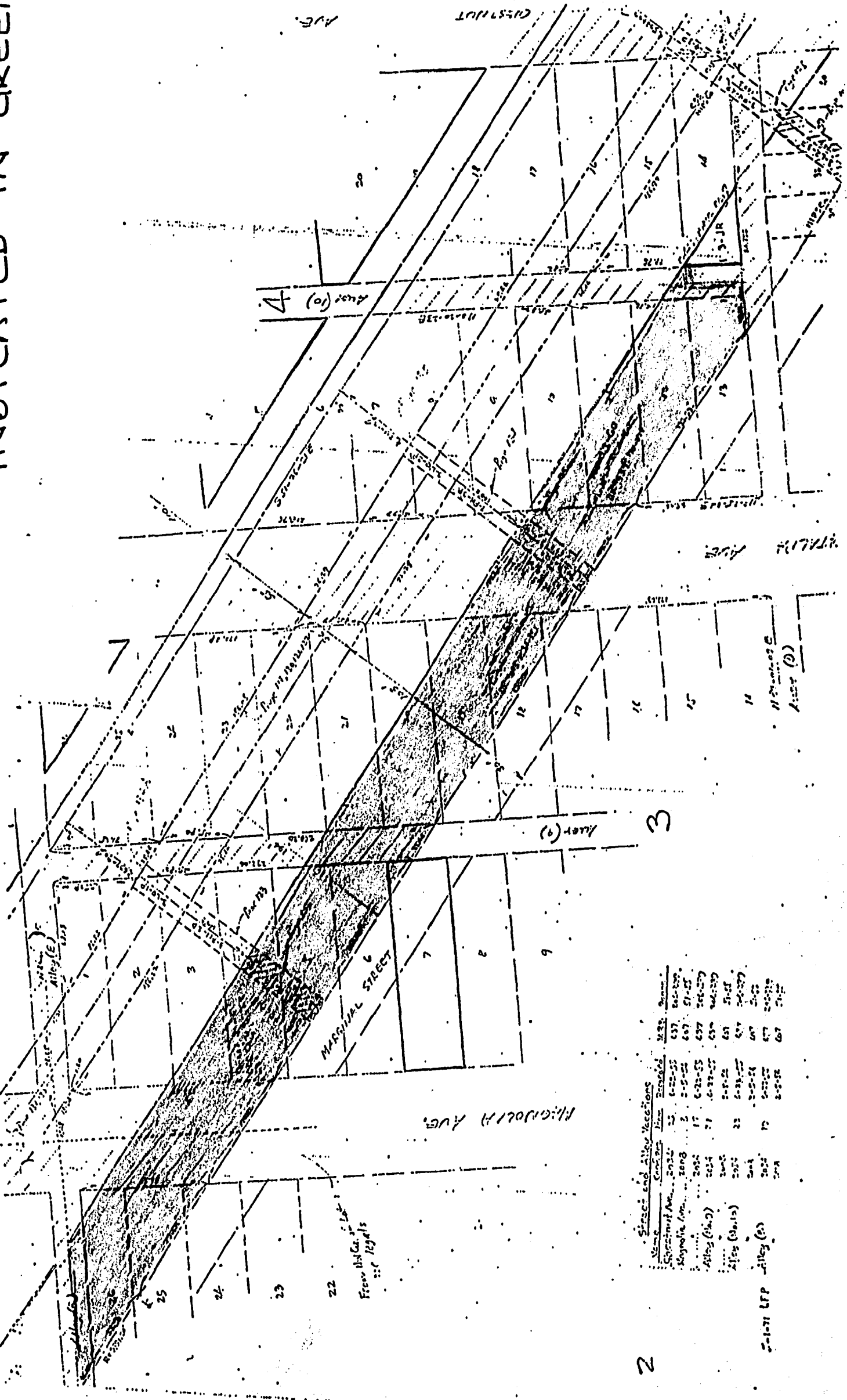

Street and Alley Vacations

Name	Com. No.	Date	Page No.	Area
Richmond Ave.	2952	6-22-55	637	640-639
Richmond Ave.	2953	6-22-55	637	57-55
Alley (S.W.)	2954	6-22-55	637	24-239
Alley (S.W.)	2955	6-22-55	637	24-239
Alley (S.W.)	2956	6-22-55	637	24-239
Alley (S.W.)	2957	6-22-55	637	24-239
Alley (S.W.)	2958	6-22-55	637	24-239
Alley (S.W.)	2959	6-22-55	637	24-239
Alley (S.W.)	2960	6-22-55	637	24-239

2

2-10-71 LFP  
Alley (S)