

630534

FOR REEL SEE DOC. #

583513

Change Return: The First Bank of Whiting, 1500-119th Street, Whiting, Indiana 46398 ATTN: Betty Bondie
R-45650
DW240172

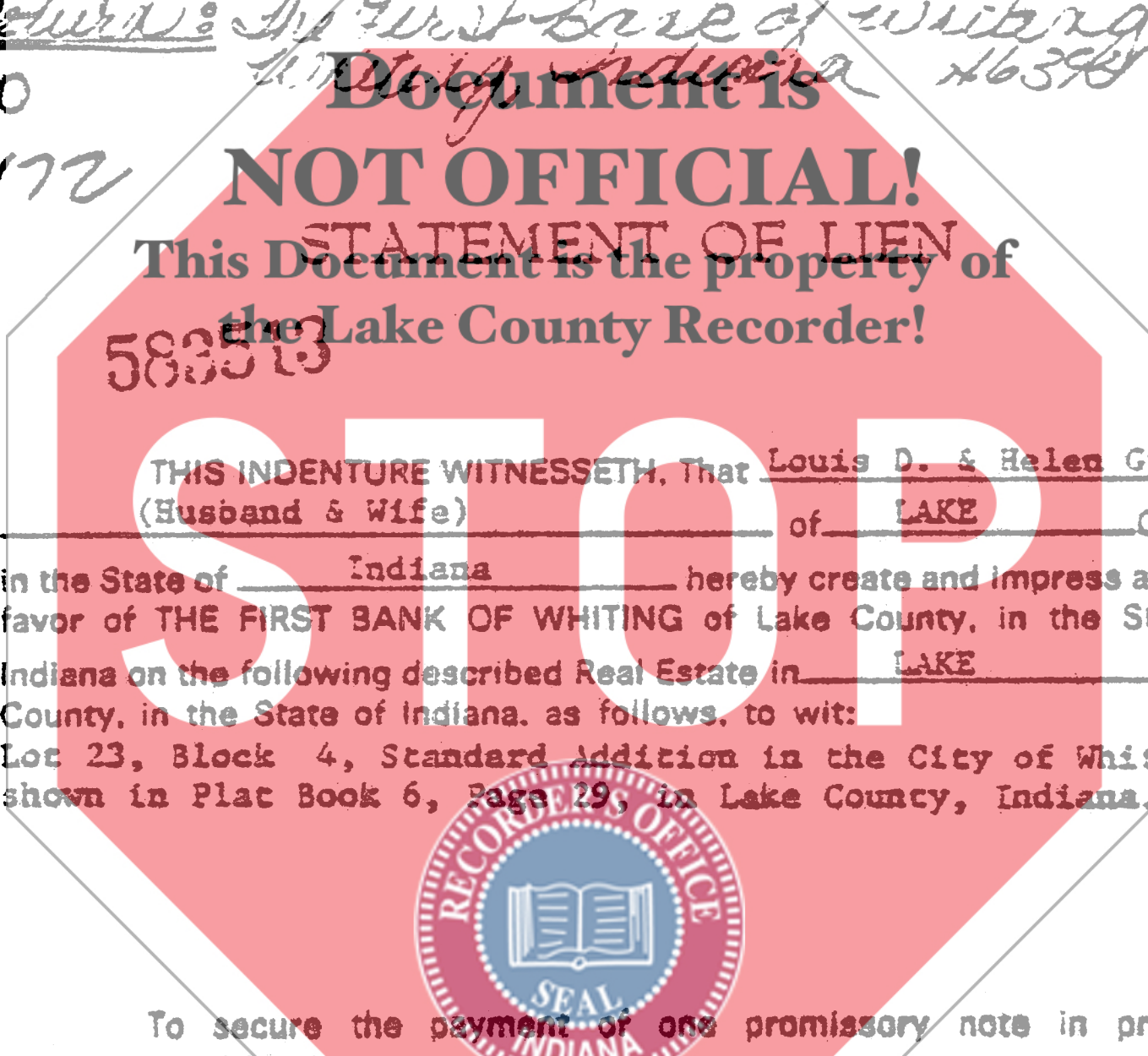

THIS INDENTURE WITNESSETH, That Louis D. & Helen Gyure
(Husband & Wife) of LAKE County,
in the State of Indiana hereby create and impress a lien in
favor of THE FIRST BANK OF WHITING of Lake County, in the State of
Indiana on the following described Real Estate in LAKE
County, in the State of Indiana, as follows, to wit:

Lot 23, Block 4, Standard Addition in the City of Whiting, as
shown in Plat Book 6, Page 29, in Lake County, Indiana.



To secure the payment of one promissory note in principal
sum of \$ 1,256.04 bearing even date herewith, executed by the lien
debtor(s) and payable to the order of the lien creditors in monthly instal-
ments as therein provided, and the lien debtor(s) expressly agree to pay
the sum of money above secure, without relief from valuation or appraise-
ment laws; and upon failure to pay said note, or any part thereof, at maturity,
or the interest thereon, or any part thereof, when due, or the taxes or
insurance as hereinafter stipulated, then all of said note to be due and
collectable, and this lien may be foreclosed accordingly.

IN WITNESS WHEREOF, Louis D. & Helen Gyure (Husband & Wife)
The said lien debtor(s) have hereunto
set their hands and seal this 2nd day of May 19 80

_____(SEAL) _____(SEAL)
Louis D. Gyure Helen Gyure

STATE OF INDIANA, Lake COUNTY, SS:

Before me, the undersigned, a Notary Public in and for said
County, this 2nd day of May 19 80 came
Louis D. Gyure and Helen Gyure, and
acknowledged the execution of the foregoing instrument.

Witness my hand and official seal.

My Commission Expires:
1-28-82

NOTARY PUBLIC Rita M. Strabavy
Lake County Resident
Marie O'Drobinak, Asst. Vice Pres.

THIS INSTRUMENT PREPARED BY: _____

INDIAN RECORDS
MAY 7 9 15 AM '80
STATE OF INDIANA'S...
RECORDED