

583467

Policy B-384476-7 LD

smw 240038

583467

Worple Federal Savings & Loan Assoc.  
WOODMAN BRANCH  
7138 Indianapolis Blvd.  
Hammond, Indiana

INDIAN TITLE INSURANCE COMPANY  
INDIANA DIVISION

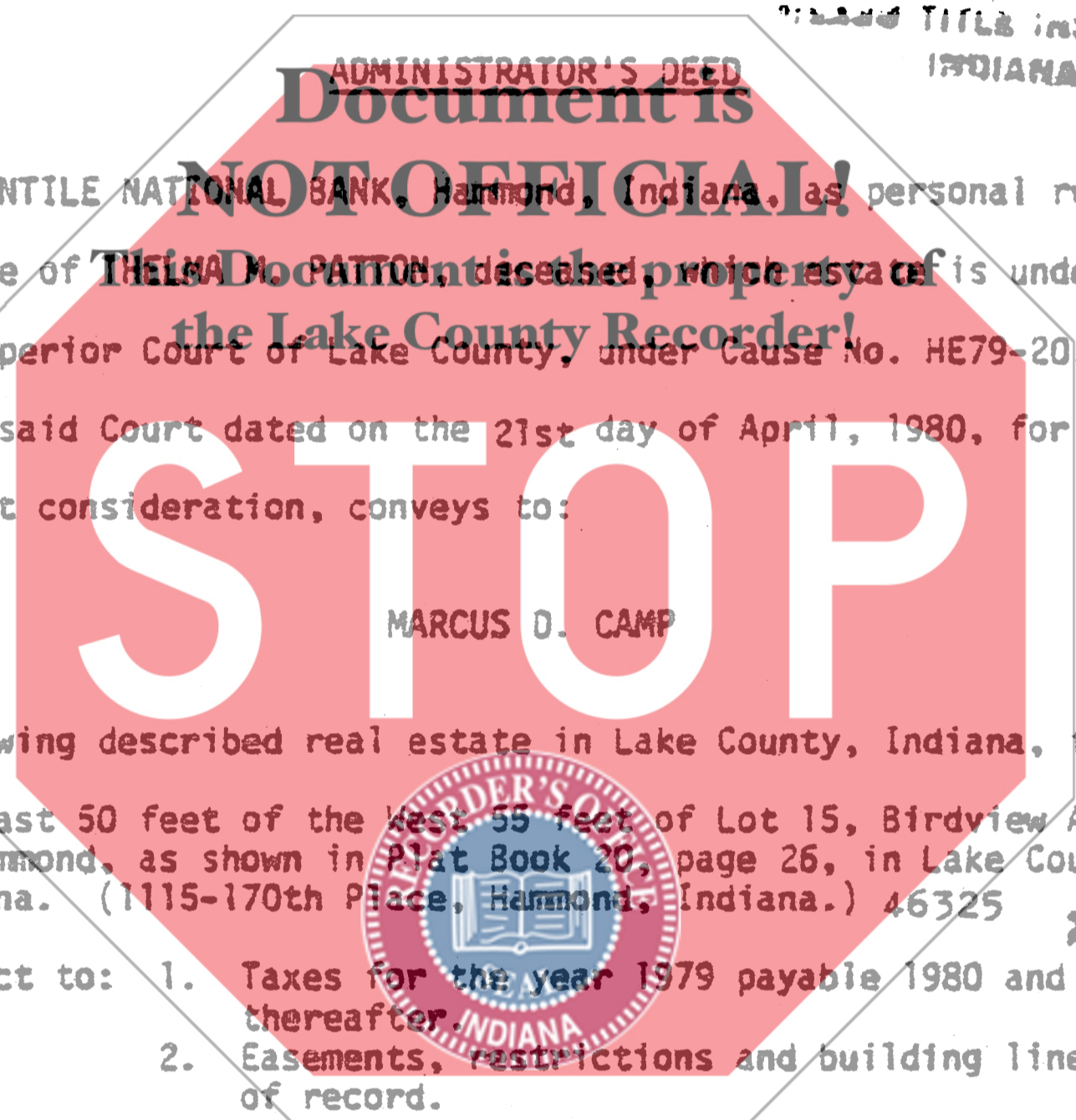

ADMINISTRATOR'S DEED  
Document is NOT OFFICIAL!  
This Document is the property of the Lake County Recorder!  
MERCANTILE NATIONAL BANK, Hammond, Indiana, as personal representative of the estate of THELMA M. PATTON, deceased, whose estate is under the supervision of the Superior Court of Lake County, under Cause No. HE79-20, pursuant to an order of said Court dated on the 21st day of April, 1980, for good and sufficient consideration, conveys to:

MARCUS D. CAMP

the following described real estate in Lake County, Indiana, to-wit:

The East 50 feet of the West 55 feet of Lot 15, Birdview Addition to Hammond, as shown in Plat Book 20, page 26, in Lake County, Indiana. (1115-170th Place, Hammond, Indiana.) 46325

#32-56-18

- Subject to: 1. Taxes for the year 1979 payable 1980 and thereafter.
- 2. Easements, restrictions and building lines of record.

IN WITNESS WHEREOF, the said MERCANTILE NATIONAL BANK, as personal representative of the estate of THELMA M. PATTON, has hereunto set their hand and seal this 3<sup>rd</sup> day of April, 1980.

Mercantile National Bank:

Trust Officer

Andrew Roche

STATE OF INDIANA

COUNTY OF LAKE

SS:

STATE OF INDIANA  
MAY 7 9 15 AM '80  
RECORDED  
WILLIAM WILSON JR  
RECORDER

Before me, the undersigned, a Notary Public, in and for said County and State, personally appear Andrew Roche, MERCANTILE NATIONAL BANK, Trust Officer, as personal representative of the estate of THELMA M. PATTON, and acknowledged the execution of said deed to be his voluntary act and deed for the uses and purposes expressed therein.

WITNESS MY HAND AND SEAL THIS 3<sup>rd</sup> day of April, 1980.

DULY ENTERED FOR TAXATION

MAY 5 1980

NOTARY PUBLIC

George Glendenning

Commission expires: 1/1/81

A resident of Lake County, Indiana.

EXAMINED AND APPROVED IN OPEN COURT THIS 21<sup>st</sup> DAY OF April, 1980

Cordell C. Pinkerton  
JUDGE, Lake Superior Court

This deed prepared by: GEORGE GLENDENING, Attorney-at-Law