

583333

THIS FORM HAS BEEN APPROVED BY THE INDIANA STATE BAR ASSOCIATION FOR USE BY LAWYERS ONLY. THE SELECTION OF A FORM OF INSTRUMENT, FILLING IN BLANK SPACES, STRIKING OUT PROVISIONS AND INSERTION OF SPECIAL CLAUSES, CONSTITUTES THE PRACTICE OF LAW AND SHOULD BE DONE BY A LAWYER.

583333 QUIT-CLAIM DEED

This indenture witnesseth that CURTIS D. WALDROP

of LAKE

Releases and quit claims to KAREN S. WALDROP

of LAKE

for and in consideration of \$10.00 and other valuable consideration the receipt whereof is hereby acknowledged, the following Real Estate in LAKE County in the State of Indiana, to wit:

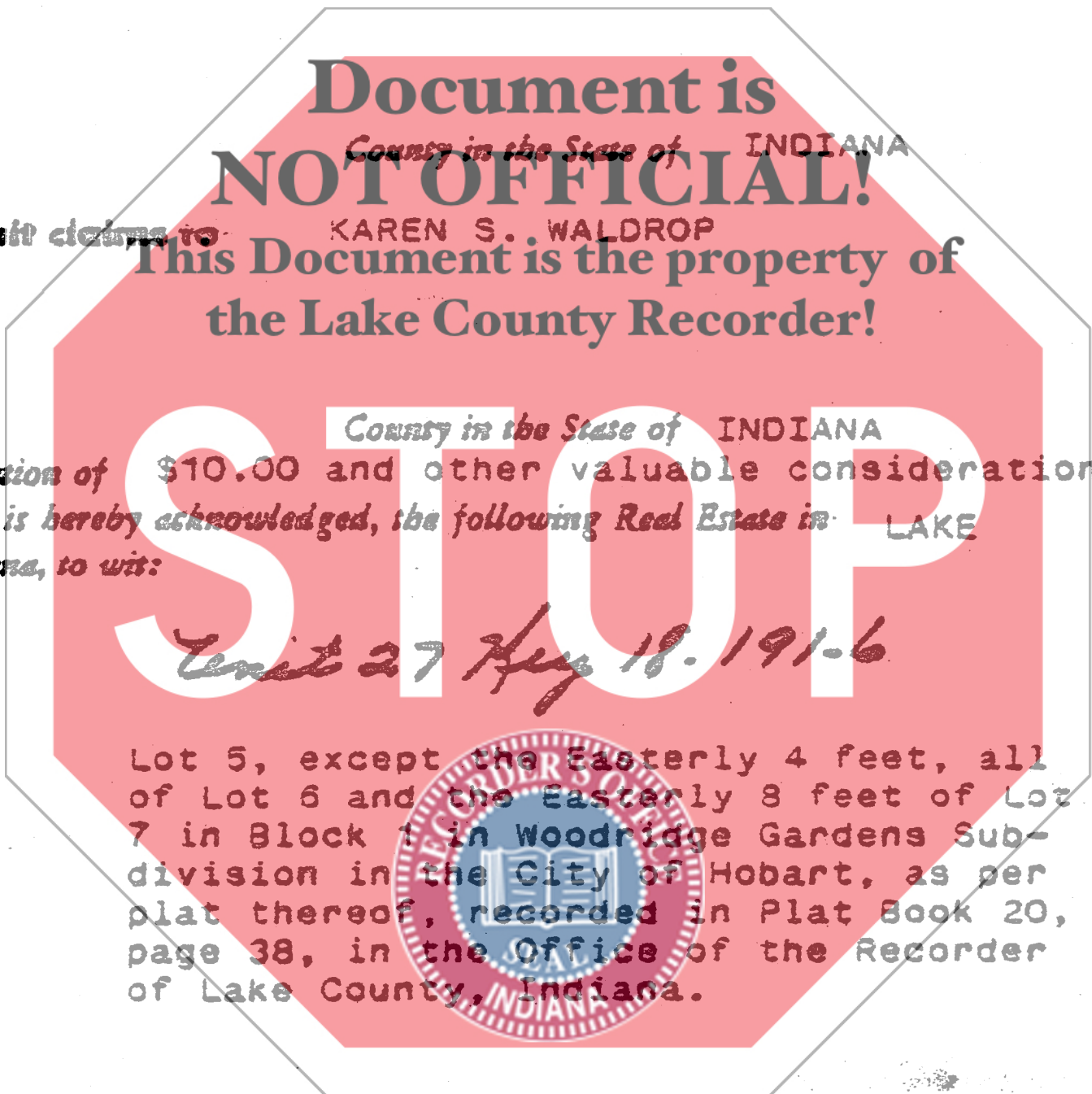

Tract 27 Aug 18. 191-6

Lot 5, except the easterly 4 feet, all of Lot 6 and the easterly 8 feet of Lot 7 in Block 1 in Woodridge Gardens Sub-division in the City of Hobart, as per plat thereof, recorded in Plat Book 20, page 38, in the Office of the Recorder of Lake County, Indiana.

DULY ENTERED FOR TAXATION
MAY 2 1980

[Signature]
AUDITOR LAKE COUNTY

STATE OF INDIANA
MAY 5 11 54 AM '80
WILLIAM DIELSKI JR
RECORDER

State of Indiana, PORTER County, ss:
Before me, the undersigned, a Notary Public in and for said County and State, this 28th day of February 19 80 personally appeared:

CURTIS D. WALDROP, by Milan D. Tesanovich, Commissioner of the Lake Circuit Court in Cause No. C76-3866, by the terms of the Order of the Lake Circuit Court dated February 28, 1980.

And acknowledged the execution of the foregoing deed. In witness whereof, I have hereunto subscribed my name and affixed my official seal. My commission expires August 24 1981

[Signature]
GINDY L. PRICE COON
Notary Public
President of Porter County

This instrument prepared by
ARNOLD A. COONS, JR.
ATTORNEY AT LAW
2655 IRVING STREET
P. O. BOX 71
PORTAGE INDIANA 46368

Dated this 28th Day of February 1980

Curtis D. Waldrop
Milan D. Tesanovich Seal
CURTIS D. WALDROP, by MILAN D. TESANOVICH, Commissioner of the Lake Circuit Court, in Cause No. C76-3866, by the terms of the Order of the Lake Circuit Court dated February 28, 1980. Seal