

28438

LAKE COUNTY TITLE COMPANY  
DIVISION OF CHICAGO TITLE INSURANCE COMPANY

2  
28438

WARRANTY DEED  
Document is

NOT OFFICIAL!

THIS INDENTURE WITNESSETH, that BILL K. ELLIOTT and MARY L. ELLIOTT, husband and wife, of Lake County, State of Indiana; and RUTH F. SMITH, a widow and not remarried, of Cook County, State of Illinois,

CONVEYS AND WARRANTS to LOWELL LUMBER COMPANY, INC., Lowell, Indiana, of Lake County, State of Indiana.

FOR AND IN CONSIDERATION of One Dollar (\$1.00) and other good and valuable consideration, the receipt whereof is hereby acknowledged, the following described real estate in Lake County, State of Indiana, to-wit:

That part of the Southeast 1/4 of the Southeast 1/4 of Section 23, Township 33 North, Range 9 West of the 2nd P.M., described as, Beginning at the Southeast corner of said Section; thence West on the South line of said Section, 96.60 feet; thence Northwesterly at an external angle of 52 degrees 47 minutes, a distance of 216.50 feet; thence Northerly a distance of 193.14 feet, more or less, to a point 131.88 feet South of the center line of Commercial Avenue; thence Easterly 216.43 feet to the East line of said Section 23; thence South on said East line at an internal angle of 94 degrees a distance of 350.1 feet to the point of beginning, in the Town of Lowell, Lake County, Indiana. Key 4-8-26

SUBJECT, NEVERTHELESS, TO THE FOLLOWING:

1. Covenants, easements and restrictions of record.
2. Taxes for 1969 payable in 1970 and all taxes thereafter.
3. Applicable building codes and zoning ordinances.
4. This deed is subject to a certain first mortgage in the original principal amount of \$240,000.00 from Charles E. Smith and Ruth F. Smith, husband and wife, and William Elliott and Mary Luelda Elliott, husband and wife, to Gary National Bank dated April 1, 1968, and recorded April 17, 1968, in Mortgage Record 1695 page 151 and assigned by Gary National Bank, Gary, Indiana, to The Midland Mutual Life Insurance Company, an Ohio Corporation, by assignment dated January 29, 1969, and recorded January 30, 1969, as Doc. No. 3355. Grantee expressly assumes and agrees to pay said mortgage balance.
5. A certain Conditional Assignment of Rentals executed by Charles E. Smith and Ruth F. Smith, husband and wife, and William Elliott and Mary Luelda Elliott, husband and wife, to Gary National Bank, of Gary, Indiana, dated April 1, 1968, and recorded April 17, 1968, as Doc. No. 746705 in Miscellaneous Record 966 page 420 as additional security for the mortgage at Item (4) herein and assigned by Gary National Bank of Gary, Indiana, to The Midland Mutual Life Insurance Company, an Ohio corporation, by assignment dated January 29, 1969, and recorded

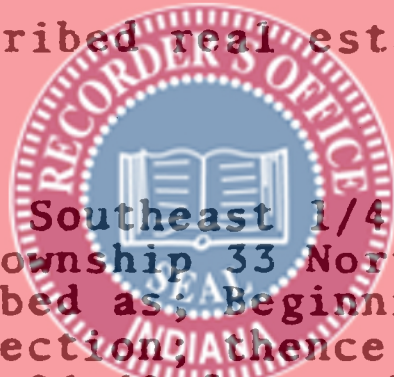

STATE OF INDIANA  
LAKE COUNTY  
FILED FOR RECORD

AUG 29 10 02 AM '69

ANDREW J. HICENKO  
RECORDER

DULY ENTERED

FOR TAXATION

Key 4-8-26  
AUG 19 1969

NOTARY LAKE COUNTY

