

24032

333769

Reception No.

Recorded this day of

WARRANTY DEED

Charge Subject Ref to - KENNETH E KNIGHT
A.D. 19 o'clock P.M.
310 EAST JOUET ST.
CROWN POINT, INDIANA

24032

THIS INDENTURE WITNESSETH

That WAYNE ASHCRAFT and LORRAINE ASHCRAFT, husband and wife,

of Lake County, Indiana

To DONALD R. BOWEN and JANE BOWEN, husband and wife, as tenants by entireties,

of Lake County, in the State of Indiana

for the sum of other valuable consideration and Ten Dollars the following described REAL ESTATE in Lake County, in the State of Indiana, to-wit:

Lot 18, in Block 1, in Park Manor Third Addition to Griffith, as per plat thereof, recorded in Plat Book 30, page 30, in the Office of the Recorder of Lake County, Indiana.

Subject to: 1969 real estate taxes payable in 1970; easements, grants and restrictions of record.

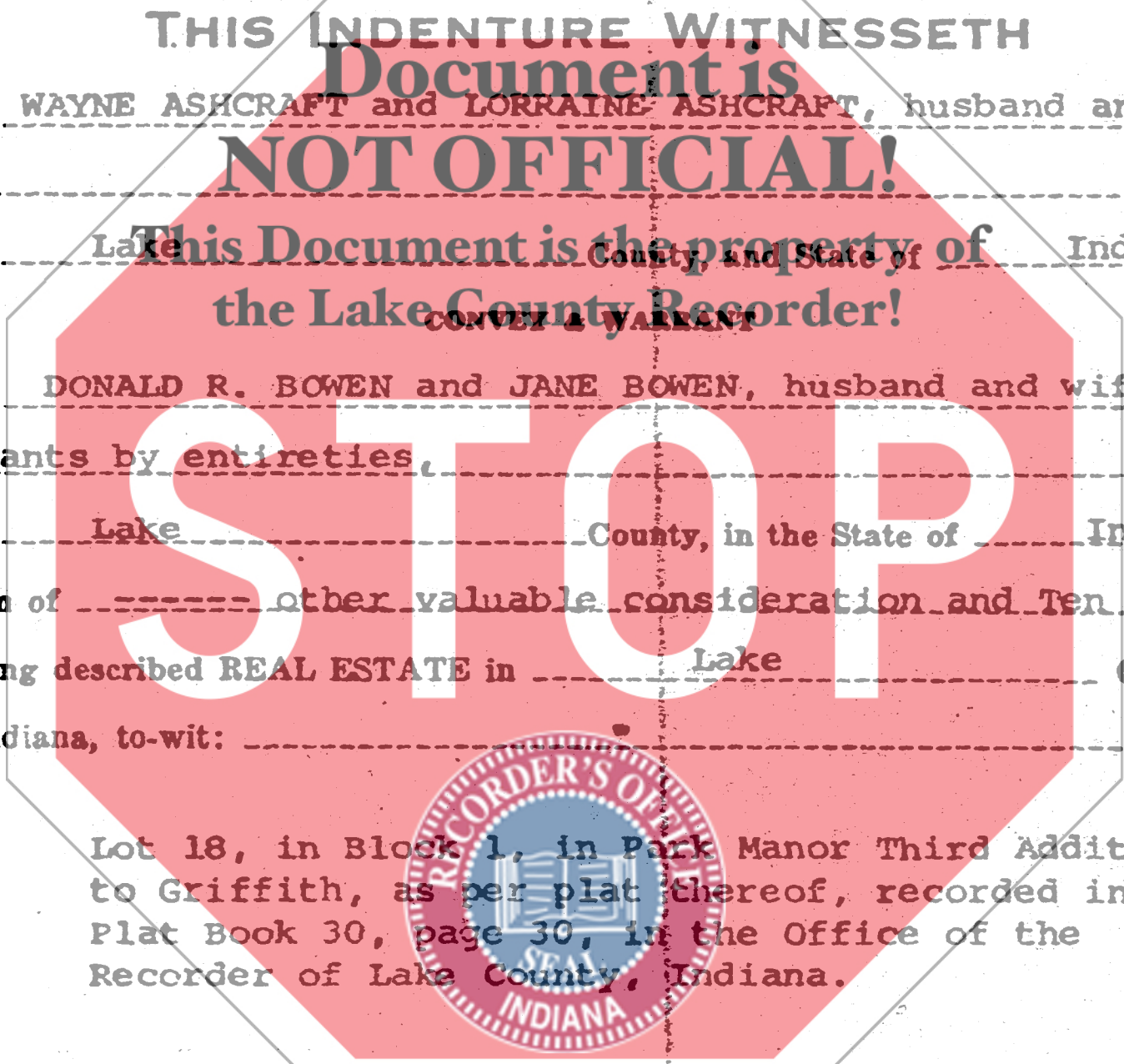

MONIER NATL TITLE INC. CO

DULY ENTERED FOR TAXATION

JUL 15 1969

Andrew J. Migenko
ANDREW J. MIGENKO

STATE OF INDIANA S. NO. LAKE COUNTY FILED FOR RECORD

JUL 15 2 23 PM '69

ANDREW J. MIGENKO RECORDER

IN WITNESS WHEREOF, The said Grantors

Have hereunto set their Hands and seals this 6th day of June, 19 69

Lorraine Ashcraft (SEAL)
(Lorraine Ashcraft) (SEAL)
(SEAL)

Wayne Ashcraft (SEAL)
(Wayne Ashcraft) (SEAL)
(SEAL)

STATE OF INDIANA, Lake County, ss:

Before me, the undersigned, a Notary Public in and for said County and State, personally appeared the within named Wayne Ashcraft and Lorraine Ashcraft, husband and wife, who acknowledged the execution of the foregoing Deed to be their voluntary act and deed.

WITNESS, my hand and Seal this 10 day of July 19 69 616

My commission expires Mar. 4 19 72 *Helen K. Lund*

This instrument was prepared by: Kenneth E. Knight, Lawyer, Crown Point, Indiana

PLEASE MAIL TAX STATEMENTS TO: DONALD R. and JANE BOWEN
735 N. Lindberg St.,
Griffith, Indiana 46319