

24031

33669

Note: This form approved by Indiana State Bar Association for use in Indiana. Use of this form constitutes practice of law and is limited to practicing lawyers.

SECURITY FEDERAL SAVINGS & LOAN ASSN. OF LAKE COUNTY

4518 INDIANAPOLIS BLVD. EAST CHICAGO, INDIANA 46212

24031 WARRANTY DEED

THIS INDENTURE WITNESSETH, That RICHARD M. TABER and ESTHER R. TABER, husband and wife

of Lake County, in the State of Indiana, CONVEY AND WARRANT to WILLIAM L. SCHURRKE and CLARICE SCHURRKE, husband and wife of Lake County, in the State of Indiana, for the sum of TEN Dollars (\$ 10.00 ) and other valuable consideration, the receipt of which is hereby acknowledged, the following described real estate in Lake County, in the State of Indiana:

Lot 15, except the south 7.5 feet thereof, and the south 10 feet of Lot 14 in Block 8 in Roxana Park Addition to the City of East Chicago, as per plat thereof, recorded in Plat Book 20, page 49, in the Office of the Recorder of Lake County, Indiana

subject to all taxes, assessments and easements of record.

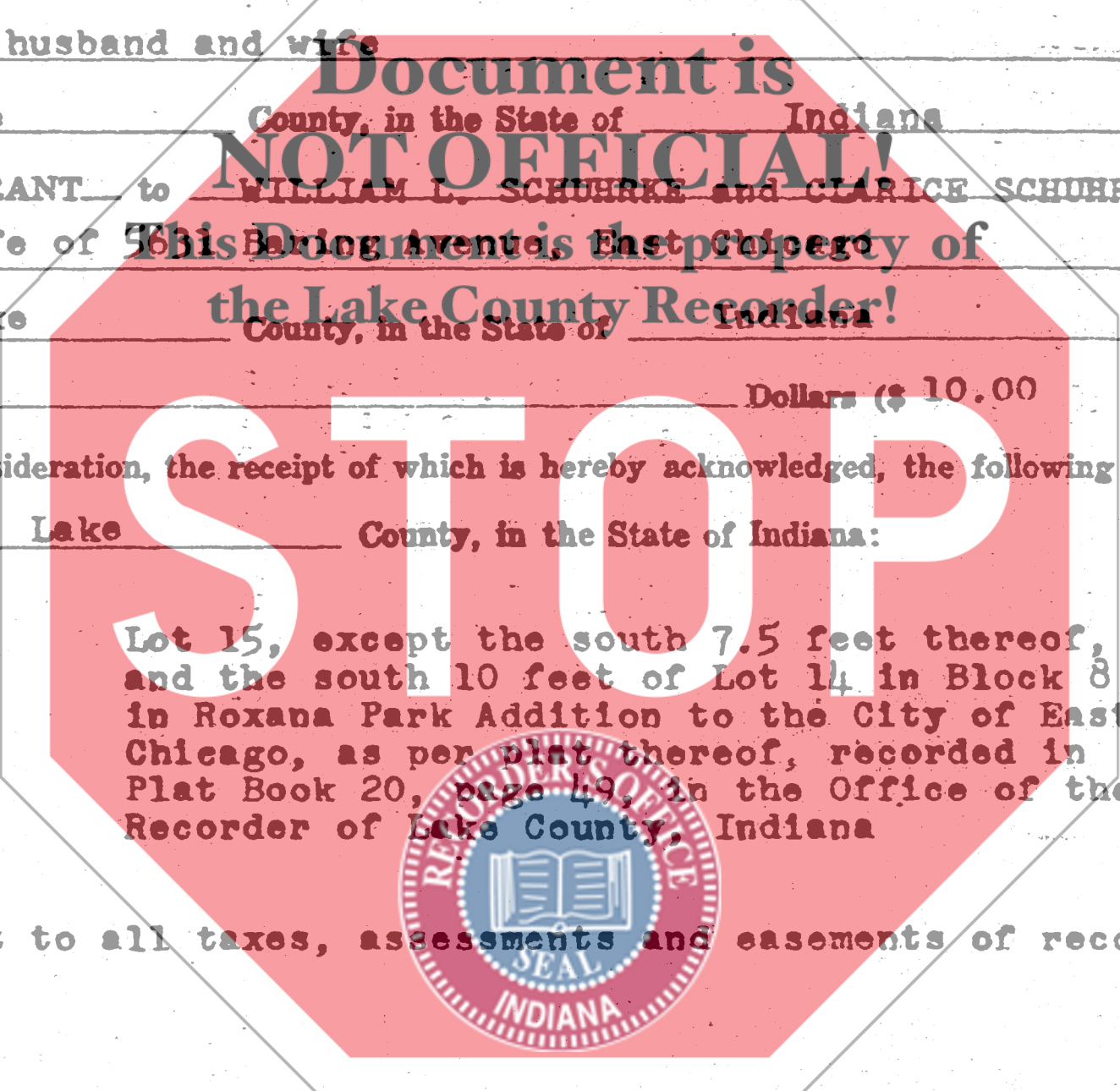

PIONEER TITLE INS. CO.

DULY ENTERED FOR TAXATION

JUL 15 1969

AUDITOR LAKE COUNTY

STATE OF INDIANA LAKE COUNTY FILED FOR RECORD

JUL 15 2:23 PM '69

ANDREW J. NIGENKO RECORDER

IN WITNESS WHEREOF, Grantor has executed this deed this 16th day of JUNE, 19 69.

Signature Richard M. Taber (SEAL) Signature Esther R. Taber (SEAL) Printed RICHARD M. TABER Printed ESTHER R. TABER

STATE OF INDIANA COUNTY OF LAKE

SS:

Before me, a Notary Public in and for said County and State, personally appeared Richard M. Taber and Esther R. Taber, husband and wife who acknowledged the execution of the foregoing Warranty Deed, and who, having been duly sworn, stated that any representations therein contained are true.

Witness my hand and Notarial Seal this 11th day of July 19 69. My commission expires 27 April 1972 Signature Michael E. Connelly Printed MICHAEL E. CONNELLY, Notary Public

This instrument was prepared by MICHAEL E. CONNELLY, attorney at law.